

W:\Projects\32017117-089 - Five Points Condominiums (Barrie)\Current Dwg\AupCAD17-089_Five Points_Landscape SPA_22dec17.dwg

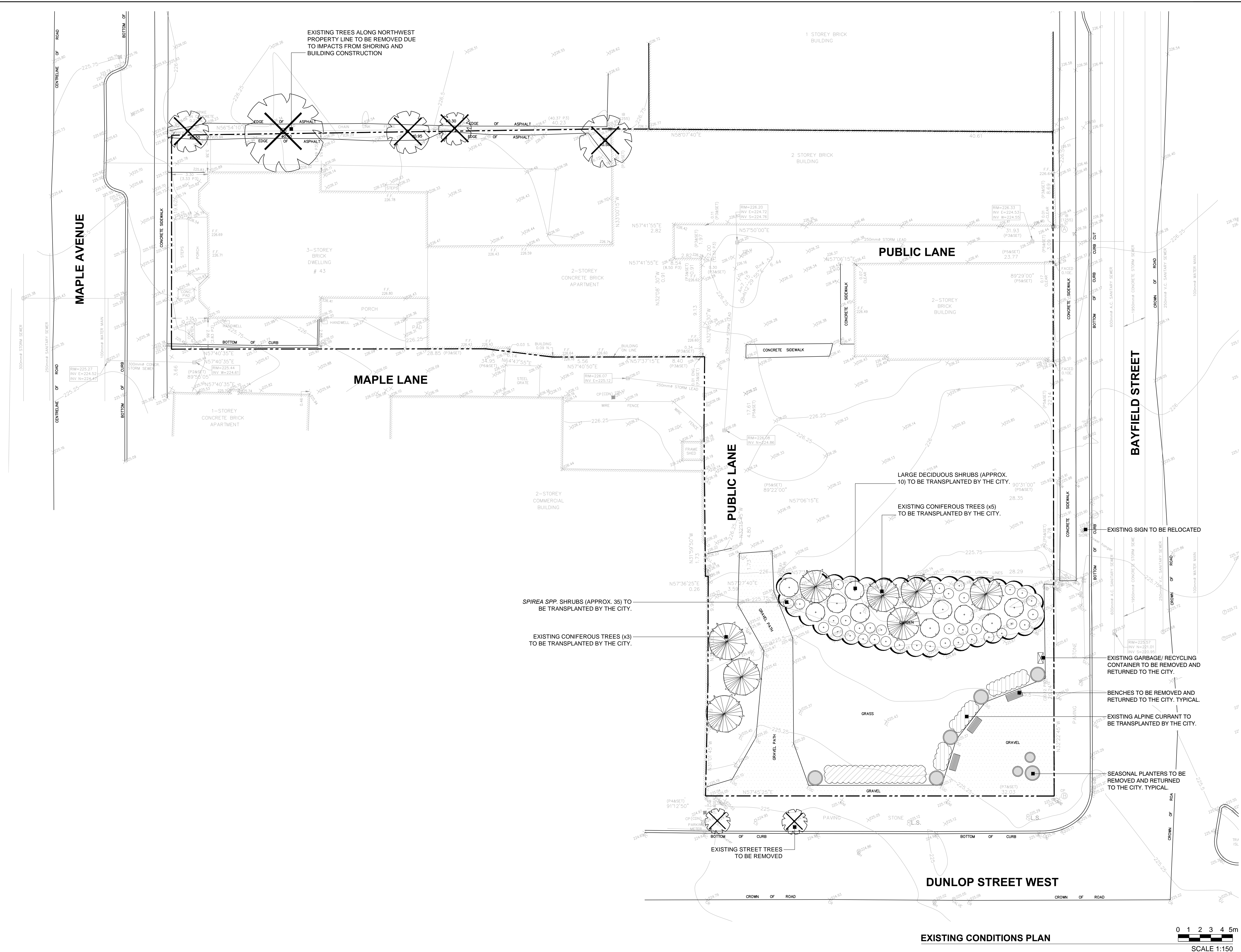

NOTES:
 All dimensions are the responsibility of the contractor to verify. This drawing is not to be scaled directly. Report all errors and omissions to Seferian Design Group Limited immediately.
 Reproduction of this drawing, or use for any other purpose than that authorized by Seferian Design Group Limited is strictly forbidden. The copyrights to all designs and drawings are the property of Seferian Design Group Limited.
 This drawing forms part of a set and may not be separated. This drawing is to be read in conjunction with all other drawings, notes and specifications included in the contract documents.
 Any ambiguity in the drawings, specifications or details is to be reported to the Landscape Architect for direction. Do not proceed in uncertainty.

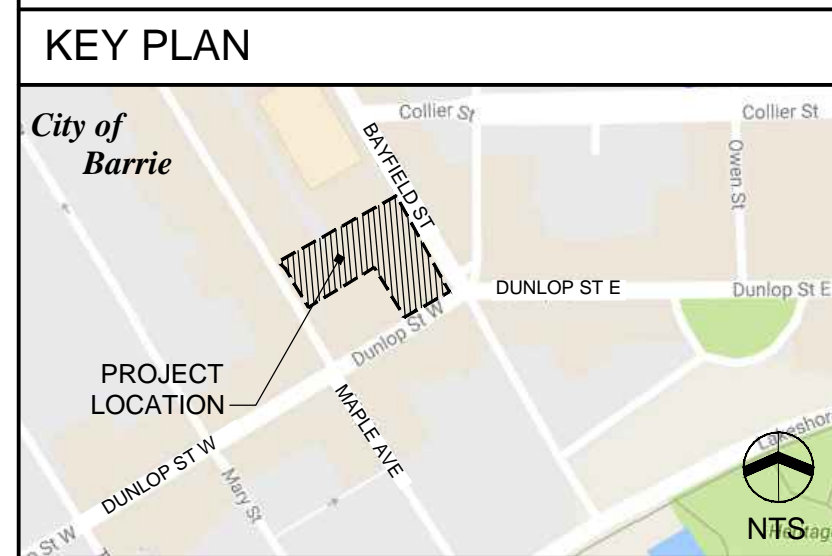

- LEGEND:**
- PROPERTY LINE
 - EXISTING GRAVEL AREA
 - EXISTING PLANT MATERIALS TO BE TRANSPLANTED
 - EXISTING SITE FURNISHINGS TO BE REMOVED AND RETURNED TO THE CITY

FOR REVIEW ONLY
 NOT FOR CONSTRUCTION

NO.	REVISIONS	DATE:
NO.	ISSUED	DATE:
2	REISSUED FOR SPA	DEC 22, 2017
1	ISSUED FOR SPA	AUG 28, 2017

CLIENT:

 2006536 ONTARIO INC.
 5-190 MINET'S POINT RD.
 SUITE 315, BARRIE, ON

PROJECT TITLE:
FIVE POINTS CONDOMINIUMS
 30 BAYFIELD STREET
 Barrie, Ontario



SHEET TITLE:
EXISTING CONDITIONS PLAN

DWG No: L1	SCALE: 1:150
STAMP: 	PROJECT NO: 17-059
	DRAWN BY: BS/LSL
	DESIGN BY: BS
	CHECKED BY: HS
	SHEET No: 1 of 5
	NORTH

PRINT DATE: Thursday, December 21, 2017