

KEY PLAN
N.T.S.

LEGEND

- PROPOSED SAN MAINTENANCE HOLE
- EXISTING SAN MAINTENANCE HOLE
- PROPOSED CATCH-BASIN
- PROPOSED CATCH-BASIN MAINTENANCE HOLE
- PROPOSED OIL/GRIT SEPARATOR
- EXISTING FIRE HYDRANT & VALVE
- EXISTING WATER METER
- PROPOSED WATER METER
- EXISTING BELL PEDESTAL
- BARRIER FREE PARKING
- DIRECTION OF FLOW
- PROPOSED CURB STOP

No.	Issuance Description	YY/MM/DD
1.	FUNCTIONAL SERVICING REPORT	15/02/13
2.	FUNCTIONAL SERVICING REPORT	15/06/04
3.	CLIENT REVIEW	16/10/14
4.	FIRST SUBMISSION	16/12/02
5.	CLIENT REVIEW	17/05/15
6.	SECOND SUBMISSION	17/05/26
7.	THIRD SUBMISSION	17/08/31
8.	FOURTH SUBMISSION	17/10/03
9.	AS PER LSRCA COMMENTS	17/11/13
10.	AS PER LSRCA COMMENTS	18/02/09
11.	REV. WATER SERV. CONNECTION & ALIGNMENT	18/03/28

HORIZONTAL CONTROL:
 ID# 03119910009
 R.I.B. w/ BRASS CAP. LOCATED ON EAST SIDE OF BIKE PATH ON FERRSDALE DRIVE NORTH AND APPROXIMATELY 75m NORTH FROM EDGEHILL DRIVE. NORTHING-N4915024.59m, EASTING-E601598.85

ID# 03120040026
 R.I.B. WITH BRASS CAP. LOCATED IN THE LANDFILL SITE ON TOP OF BERM ON NORTH SIDE OF MAIN BUILDING AND THE WEIGH SCALE. OPPOSITE A SMALL GRATE. NORTHING-N4915496.45, EASTING-E600496.85

VERTICAL CONTROL:
 ID# 03120030022
 BRASS TABLET. LOCATED AT HEADWALL TO CULVERT ON NORTH WEST CORNER TO FERRSDALE DR. AND SANDY HOLLOW LANDFILL ENTRANCE. NORTHING-N4915556.00, EASTING-E601196.00 ELEVATION-266.19

ID# 01019865469
 BRASS TABLET. LOCATED ONE AND ONE-HALF STORY FRAME DWELLING #401 ON THE SOUTH SIDE OF EDGEHILL DRIVE IN THE CITY BARRIE. NORTHING-N4914420.00, EASTING-E600412.00 ELEVATION-241.698

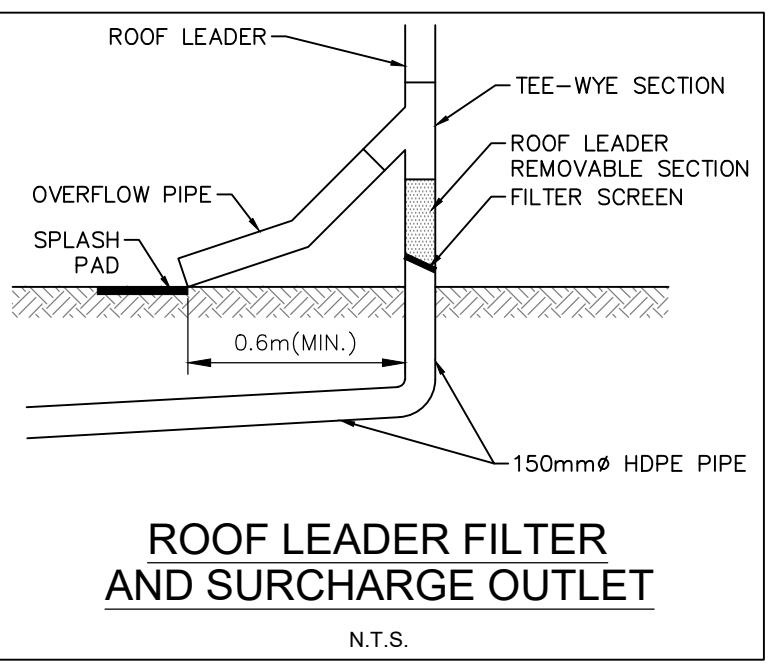
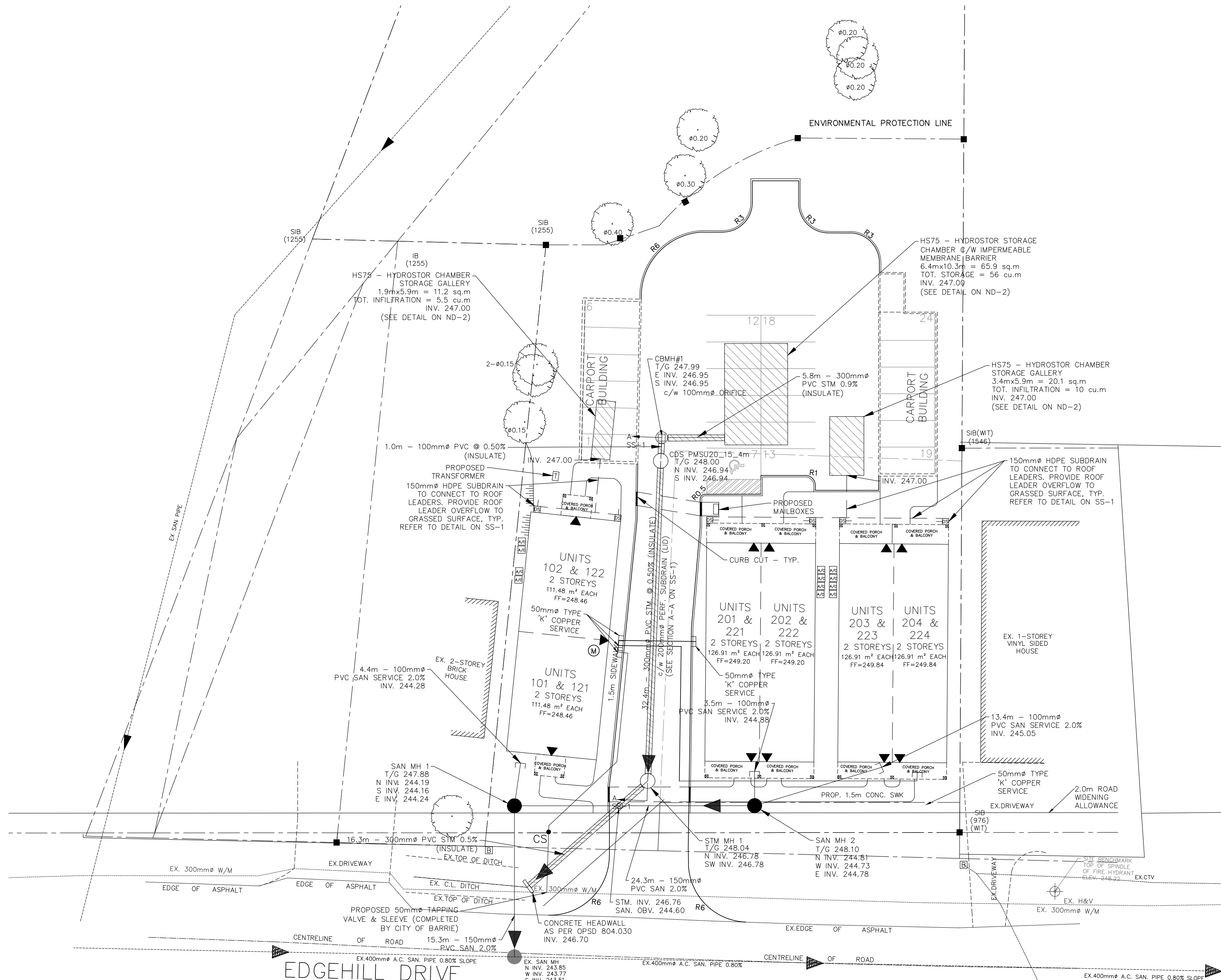

ISSUED FOR:
SITE PLAN APPROVAL

Client: **HEDBERN HOMES**

Project: **RESIDENTIAL DEVELOPMENT**
EDGEHILL DR., BARRIE, ON

Drawing: **SITE SERVICING PLAN**

Project No. 530-007-14 Designed by: KF Checked by: RCC
 Scale: 1:250 Drawn by: KF Approved by: JDM

Orientation:

Stamp: