

- Legend:**
- EXISTING FEATURES (EX)**
- EX SIB EX STD IRON BAR
 - EX IB EX IRON BAR
 - EX MAILBOX EX MAILBOX
 - EX UP EX UTILITY POLE
 - EX BELL PED EX BELL PED
 - EX HYDRO EX HYDRO TRANSFORMER
 - EX WS EX WATER SERVICE
 - EX HYD EX FIRE HYD.
 - EX WY EX WATER VALVE
 - EX NS EX ST NAME SIGN
 - EX SS EX STOP SIGN
 - EX ELEV EX ELEVATION
 - EX FENCE EX FENCE
 - EX U/G GAS EX U/G GASMAIN
 - EX U/G BELL EX U/G BELL
 - EX O/H HYDRO EX O/H HYDRO
 - EX 00mm² WATERMAIN EX WATERMAIN & VALVE
 - EX 00mm² SAN @ 0.0% EX SAN SEWER & MH
 - EX 00mm² STM @ 0.0% EX STM SEWER & MH

- PROPOSED FEATURES (PR)**
- NS PR STREET NAME SIGN
 - SS PR STOP SIGN
 - SF PR SILT FENCE
 - PR PR STREET LIGHT
 - PR PR WATER SERVICE
 - PR PR SAN SERVICE
 - PR PR STM SERVICE
 - PR PR HYDRO TRANSFORMER
 - PR PR WATERMAIN
 - PR PR FIRE HYDRANT
 - PR PR WATER VALVE
 - PR PR SAN SEWER
 - PR PR SANITARY MANHOLE
 - PR PR STM SEWER
 - PR PR CATCHBASIN MANHOLE
 - PR PR MANHOLE
 - PR PR CATCHBASIN
 - PR PR LANDSCAPE CATCHBASIN
 - PR PR ELEVATION
 - PR PR MATCH EXISTING ELEVATION (INTERPOLATED)
 - PR PR SLOPE
 - PR PR SWALE
 - PR PR DEPRESSED CURB
 - PR PR LINEAR LID STORM SEWER
 - PR PR FIRE BREAK LINE

- GENERAL NOTES:**
- BASEPLAN INFORMATION OBTAINED FROM THE SITE PLAN PREPARED BY INNOVATIVE PLANNING SOLUTIONS.
 - EXISTING SERVICES INFORMATION OBTAINED FROM CITY OF BARRIE DRAWINGS AND SERVICE LOCATE SHEETS.
 - ALL SWALES ARE 0.15m DEPTH WITH 3:1 SIDE SLOPES UNLESS OTHERWISE NOTED.

- EROSION & SEDIMENT NOTES:**
- EROSION CONTROL WORKS TO BE INSPECTED REGULARLY AFTER EVERY RAINFALL AND REPAIRED/REPLACED AS REQUIRED BY THE MUNICIPALITY OR DEVELOPER'S ENGINEER.
 - ALL DISTURBED AREAS TO BE RESTORED USING TOPSOIL AND SEED IMMEDIATELY UPON ESTABLISHING FINAL GRADES.
 - EROSION CONTROL WORKS TO BE MAINTAINED UNTIL THE SITE HAS STABILIZED AND REMOVAL IS DIRECTED BY THE MUNICIPALITY OR DEVELOPER'S ENGINEER.
 - SILTATION CONTROL FENCE (REFER TO BSD-1233) TO BE CONSTRUCTED/INSTALLED AROUND PERIMETER OF THE SITE PRIOR TO CONSTRUCTION COMMENCEMENT.
 - CONSTRUCTION ENTRANCE MAT (REFER TO BSD-23D) TO BE POSITIONED AND INSTALLED BY THE CONTRACTOR PRIOR TO ANY SITE DISTURBANCE.
 - ALL DISTURBED AREAS THAT WILL REMAIN FOR MORE THAN 30 DAYS SHALL BE STABILIZED PER THE "LSRCA TECHNICAL GUIDELINES FOR STORMWATER MANAGEMENT SUBMISSIONS".
 - ALL SWM QUALITY CONTROLS SHALL REMAIN OFF-LINE UNTIL THE SITE HAS BEEN STABILIZED AS APPROVED BY THE ENGINEER.

CAUTION
CONTRACTOR TO DETERMINE
LOCATION OF EXISTING UTILITIES
PRIOR TO CONSTRUCTION.

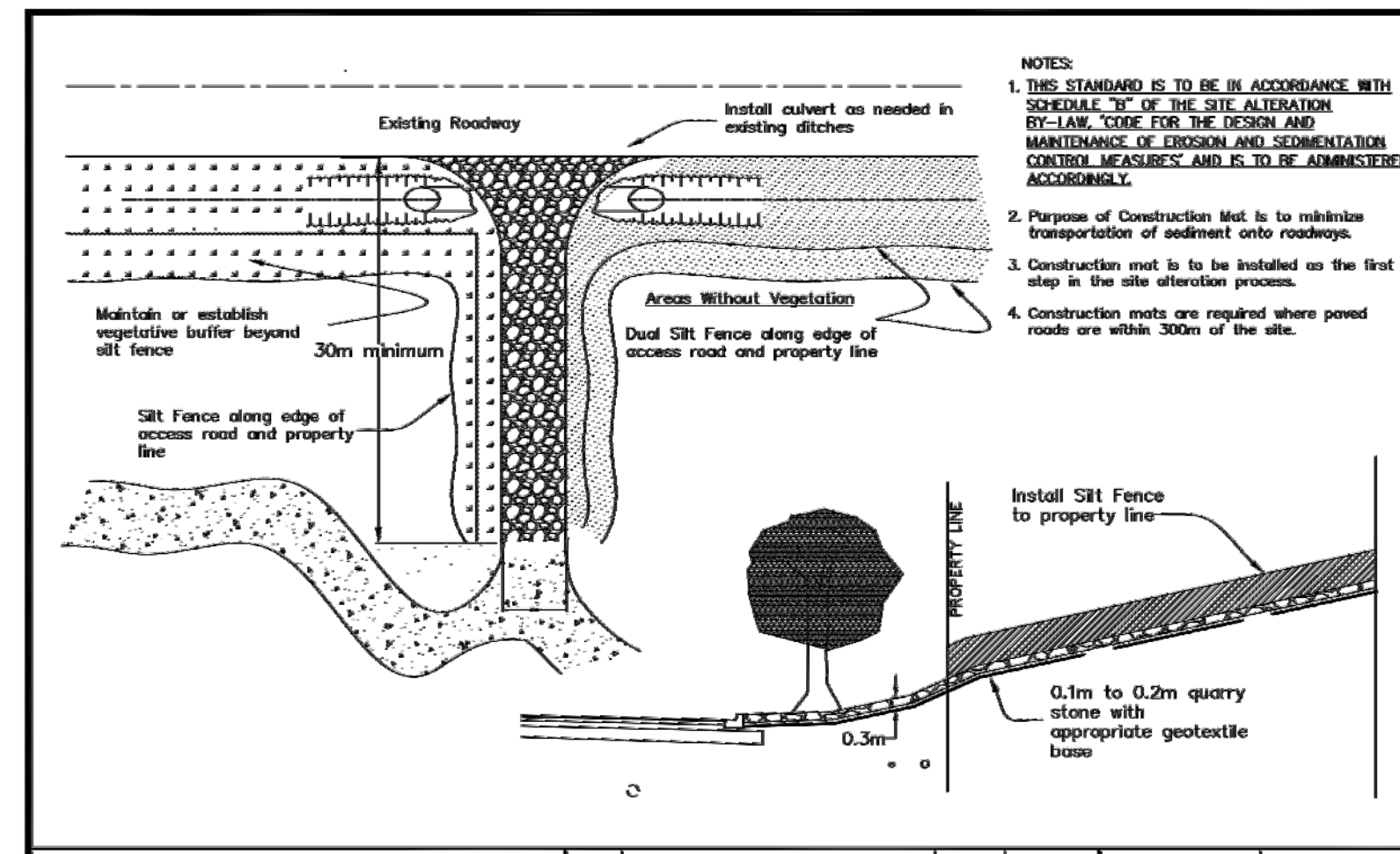
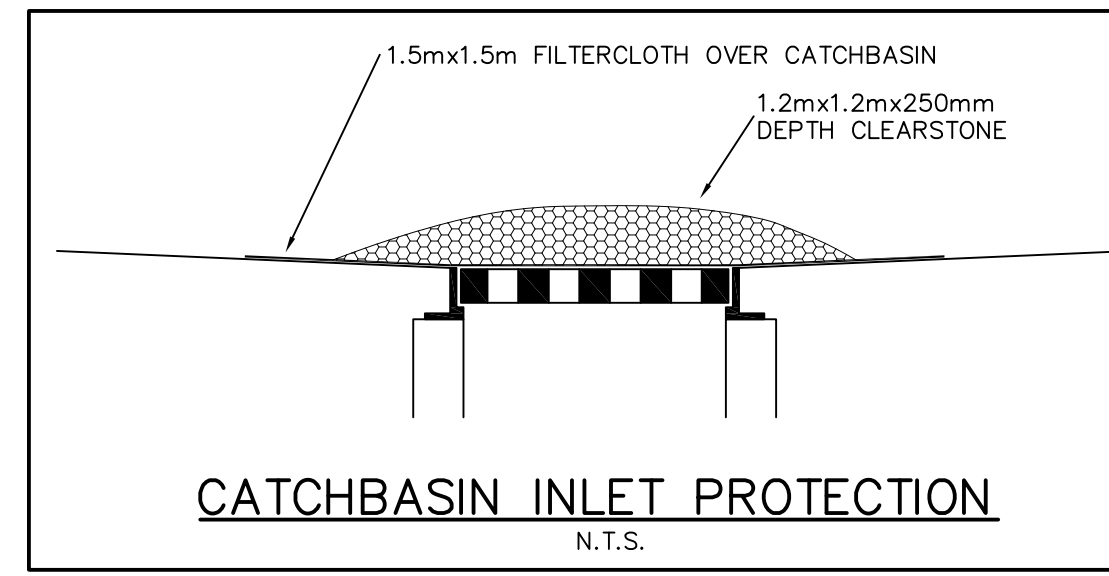
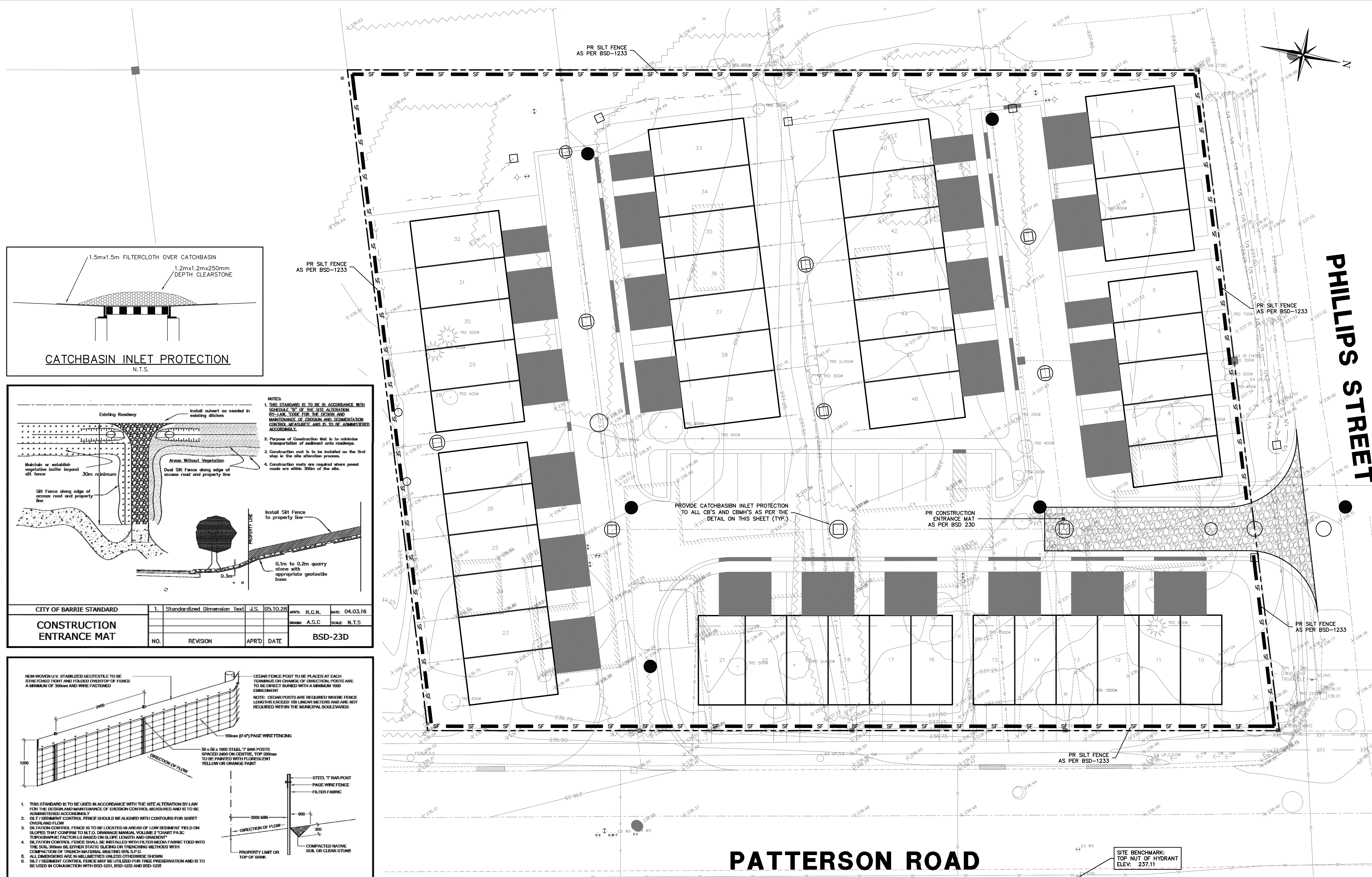

CITY OF BARRIE STANDARD	1. Standardized Dimension Text	J.S. 05.10.28	APP'D: R.G.N.	DATE: 04.03.16
CONSTRUCTION ENTRANCE MAT			SCALE: A.S.C	SCALE: N.T.S.
NO.	REVISION	APR'D	DATE	BSD-23D

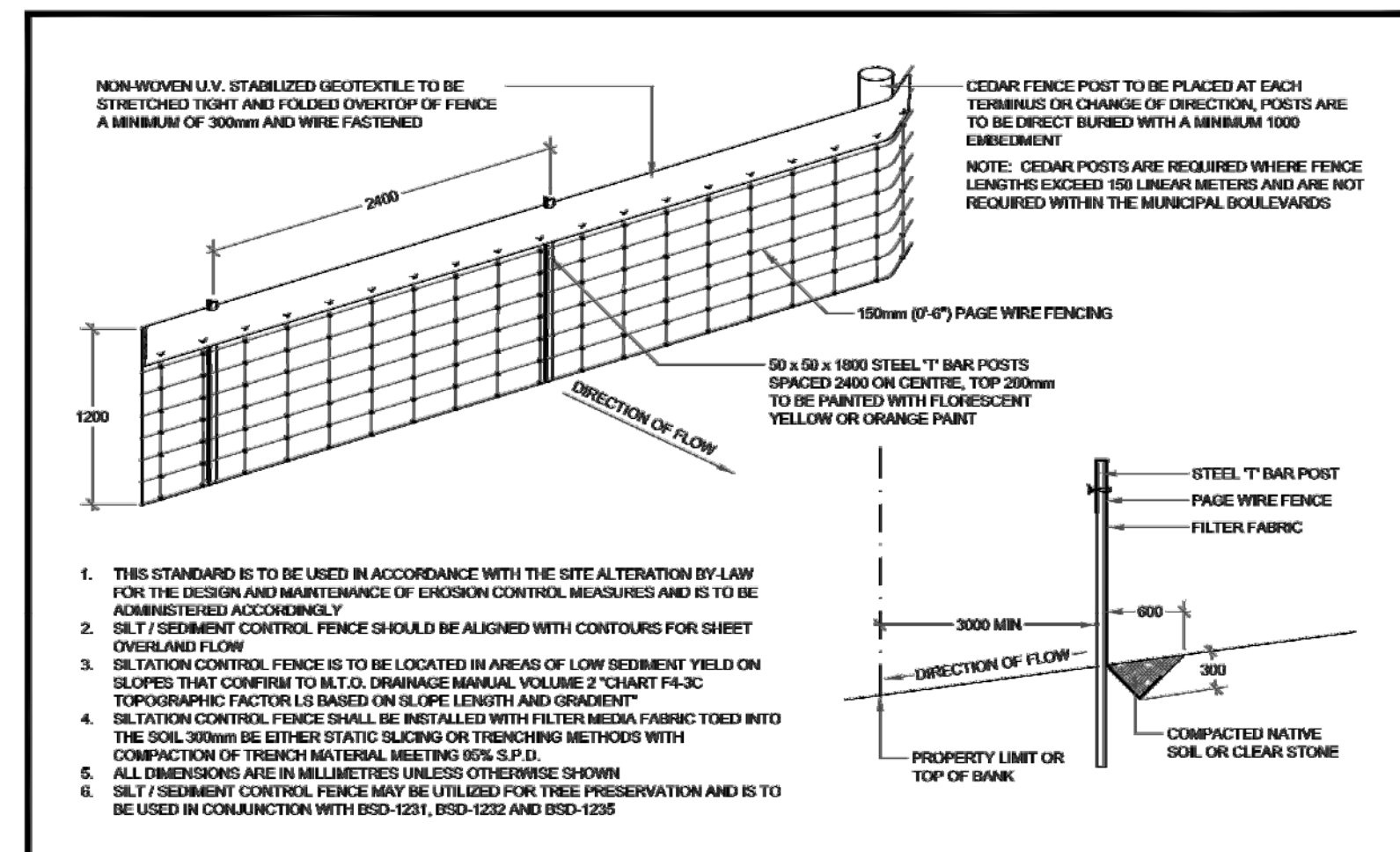

Barrie STANDARD DETAIL	SILTATION CONTROL FENCING	REV No. 2	DATE: OCT 2017	APPROVED
		SCALE: N.T.S.		Oct 10/17
		BSD-1233		Original Signed By
		FORMERLY BSD-23A		DIRECTOR OF ENGINEERING

- Notes:**
- Unless noted otherwise, the measurements and distances shown on this drawing are shown in meters.
 - Do not scale drawings.
 - It is the contractor's responsibility to verify all dimensions, levels and datums on site and report any discrepancies or omissions to WMI & Associates Ltd. prior to construction.
 - This drawing is to be read and understood in conjunction with all other relevant documents applicable to this project.
 - This drawing is the exclusive property of WMI & Associates Ltd. and the reproduction of any part of this document without prior written consent is strictly prohibited.

Benchmark: 237.11m
Top nut of hydrant located between #46 and #48 Patterson Road on the east side of Patterson Road.

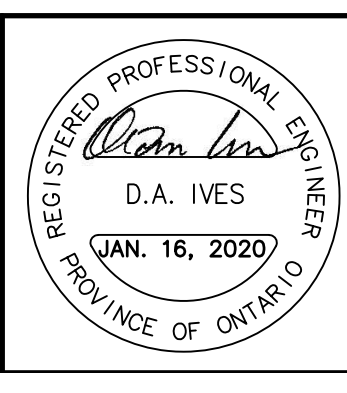

No.	Issue / Revision	Date
1	1ST SUBMISSION	July 12, 2019
2	2ND SUBMISSION	OCT. 22, 2019
3	3ND SUBMISSION	JAN. 16, 2020

46-56 PATTERSON ROAD
EROSION AND SEDIMENT CONTROL PLAN

Client:
Farrage Developments Inc.
185 Goulding Avenue
Toronto, Ontario
M2R 2P3

Drawn By: JA	Checked By: DAI	Drawing No.:
Scale: 1:200	Project No.: 17-428	ESC