

**GENERAL NOTES**

CONTRACTOR IS RESPONSIBLE FOR ALL LOCATES INCLUDING ALL UNDERGROUND SERVICES PRIOR TO ANY EXCAVATION OR INSTALLATIONS. THE CONTRACTOR IS REQUIRED TO NOTIFY THE VARIOUS UTILITY COMPANIES 48 HOURS PRIOR TO THE COMMENCEMENT OF ANY WORK.

ANY ACCOMPANYING DOCUMENTATION RELATING TO THE LANDSCAPE PLAN AND/OR PRESERVATION PLAN SUCH AS TENDER DOCUMENTS AND CHANGE NOTICES ARE TO BE ENDORSED BY JOHN D. BELL ASSOCIATES LIMITED PRIOR TO THE BEGINNING OF ANY SITE WORKS. IN THE EVENT THAT OF A DISCREPANCY THE DRAWING SHALL BE ASSUMED CORRECT.

IT IS THE RESPONSIBILITY OF THE PERSON OR PERSONS RESPONSIBLE FOR THE CONSTRUCTED WORKS TO NOTIFY JOHN D. BELL ASSOCIATES WHEN PREPARED FOR ANY REQUIRED INSPECTIONS AND SIGN OFFS.

SCHEDULED MEETINGS SHALL TAKE PLACE AT THE CLOSEST MUTUALLY CONVENIENT TIME.

No.	REVISION	DATE	APRVD.
1.	CLIENT REVIEW	Dec. 12, 2019	ST
2.	SUBMITTED TO THE CITY OF BARRIE	Feb. 25, 2020	ST
3.	AS PER CITY OF BARRIE COMMENTS	June 15, 2020	ST
4.	AS PER CITY OF BARRIE COMMENTS	November 25, 2020	ST

BASE INFORMATION PROVIDED BY: J.D. BARNES Ltd. 540 Bay St., Barrie, ON. BASE PLAN OBTAINED: January 2018

ALL DRAWINGS AND SPECIFICATIONS ARE INSTRUMENTS OF SERVICE AND ARE THE PROPERTY OF JOHN D. BELL ASSOCIATES LIMITED. DRAWINGS ARE NOT TO BE MODIFIED AND/OR REPRODUCED WITHOUT THE WRITTEN CONSENT OF JOHN D. BELL ASSOCIATES LIMITED. REPRODUCTION OF DRAWINGS IN ANY FORM WITHOUT THE CONSENT OF JOHN D. BELL ASSOCIATES LIMITED VOIDS THE DRAWING AT WHICH TIME JOHN D. BELL ASSOCIATES LIMITED ACCEPTS NO LIABILITY FOR THE DRAWING CONTENT OR WORKS RESULTING FROM SAID REPRODUCTION.

IF DRAWINGS MAY BE REPRODUCED BY MUNICIPAL AND GOVERNMENT AGENCIES RESPONSIBLE FOR APPROVALS FOR THEIR OWN USE, JOHN D. BELL ASSOCIATES RESERVES THE RIGHT TO WITHDRAW ANY DRAWINGS FROM GOVERNMENT OR MUNICIPAL AGENCIES WHETHER APPROVED OR NOT IN THE EVENT THAT ACCOUNTS ARE NOT SETTLED OR REMAIN OUTSTANDING.

IT IS THE RESPONSIBILITY OF THE CONTRACTOR TO VERIFY ALL DIMENSIONS ON THE SITE AND REPORT ANY DISCREPANCIES OR VARIATIONS FROM THE SUPPLIED INFORMATION TO THE LANDSCAPE ARCHITECT WITH THE PROJECT. JOHN D. BELL ASSOCIATES LIMITED IS NOT RESPONSIBLE FOR THE ACCURACY OF SURVEY, ARCHITECTURAL, MECHANICAL, ENGINEERING OR ELECTRICAL INFORMATION SHOWN ON THE DRAWINGS. FOR FURTHER INFORMATION REFER TO APPROPRIATE SURVEY, ARCHITECTURAL, MECHANICAL, ENGINEERING OR ELECTRICAL DRAWINGS PRIOR TO PROCEEDING WITH ANY WORKS.

THIS DRAWING IS NOT TO BE SCALED.

Tree #	Nr. of trees	Botanical Name	Common name	DBH cm	Height m	Crown O (m)	Maturity	Health conditions	Location	Recommended action
1	2	<i>Acer negundo</i>	Manitoba Maple	<10	5	6	Immature	Fair	Multi-trunk 1m, 2m to Property Line on Site	Remove
2	1	<i>Pinus sylvestris</i>	Scots Pine	45	12	8	Mature	Fair	1.5m to PL on Site	Preserved
3	1	<i>Thuja occidentalis</i>	Northern White Cedar	25	8	6	Mature	Good	1m to PL on Site	Removed
4	1	<i>Juglans nigra</i>	Black Walnut	11	7	6	Immature	Good / Fair	4m to PL on Site	Removed
5	1	<i>Pinus sylvestris</i>	Scots Pine	35	12	12	Mature	Fair	1.4m to PL on Site	Removed
6	1	<i>Pinus sylvestris</i>	Scots Pine	40	12	12	Mature	Fair / Good	1.5m to PL on Site	Removed
7	1	<i>Thuja occidentalis</i>	Northern White Cedar	20	8	3	Mature	Fair	1m to PL on Site	Removed
8	1	<i>Picea abies</i>	Norway Spruce	50	14	10	Mature	Good	1.2m to PL on Site	Removed
9	2	<i>Pinus nigra</i>	Austrian Pine	30	14	7	Mature	Poor / Fair	Vines 2.2m, 2m to PL on Site	Removed
10	1	<i>Robinia pseudoacacia</i>	Black Locust	14	6	5	Immature	Good	0.4m to PL on Site	Removed
11	1	<i>Ulmus americana</i>	White Elm	12	6	7	Immature	Good	0.3m to PL on Site	Removed
12	4	<i>Celtis occidentalis</i>	Hackberry	13-14	5-6	3-4	Immature	Fair	Boulevard	Protected

**LEGEND**

- SUBJECT LANDS. REFER TO SITE PLAN.
- EXISTING TREE NUMBER
- EXISTING TREES TO BE REMOVED. REFER TO TREE INVENTORY LIST ON THIS PAGE.
- EXISTING TREES TO BE PRESERVED. REFER TO TREE INVENTORY LIST ON THIS PAGE.
- PLANT MATERIAL TO BE PERMANENTLY PRESERVED -- INDICATES THAT ANY VEGETATION WITHIN THESE AREAS ARE TO BE PRESERVED IN ACCORDANCE TO PRESERVATION TECHNIQUES OUTLINED ON THIS PLAN. REFER TO PAGE TP-2.
- TREE PRESERVATION FENCE. REFER TO DETAILS ON PAGE TP-2

NOTE:  
NO ENDANGERED SPECIES OF TREES HAVE BEEN IDENTIFIED ON SITE AND ADJACENT LANDS.

DATE \_\_\_\_\_  
PRINT NAME \_\_\_\_\_  
SIGNED OWNER/CLIENT \_\_\_\_\_

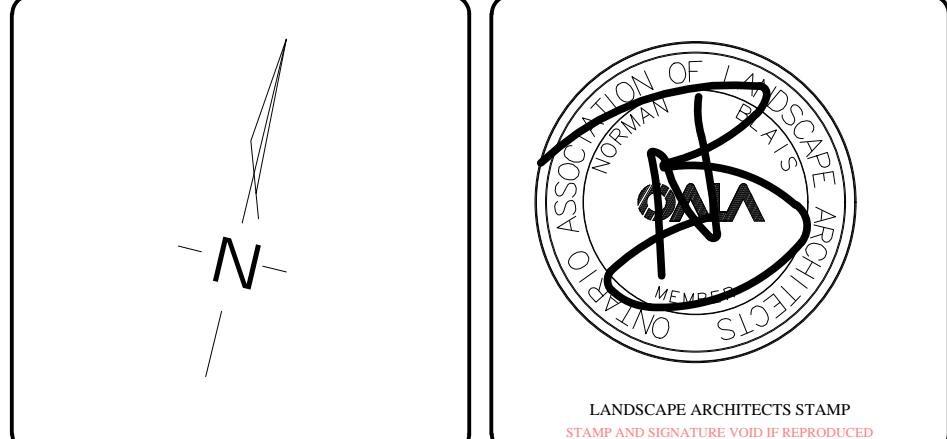

**JDB ASSOCIATES LTD.**  
Urban Designers  
Landscape Architects  
Arborists  
274 Burton Ave., Suite 1201  
Barrie, Ontario L4N 5W4  
Fax: 705-722-5600  
Tel: 705-722-6278

**TREE PRESERVATION PLAN**

SCALE: 1:200	DATE: January 29, 2018	DESIGNED BY: ST	REVIEWED BY: NB
CITY FILE No.	OUR FILE REF. # 1162A-18	DRAWN BY: ST	TP-1