

GENERAL NOTES

1. BASE SURVEY PLAN PREPARED WITH THE FOLLOWING DRAWINGS:
 - 1.1. SURVEY DRAWING 2868-07 DATED JUNE 1, 2011 COMPLETED BY R. AVIS SURVEYING INC.
2. THE LOCATION AND EXTENT OF ALL EXISTING UTILITIES SHOWN ON THE PLAN ARE CONSIDERED APPROXIMATE ONLY. PRIOR TO CONSTRUCTION THE CONTRACTOR SHALL CONFIRM THE LOCATION OF UTILITIES AND BE RESPONSIBLE FOR ADEQUATE PROTECTION FROM DAMAGE DURING CONSTRUCTION.
3. ALL WORK TO CONFORM TO THE APPLICABLE MUNICIPALITIES STANDARDS, ONTARIO PROVINCIAL STANDARDS AND SPECIFICATIONS AND ALL OTHER RELEVANT CODES, STANDARDS, GUIDELINES, ETC.
4. ALL WORK TO BE CARRIED OUT IN COMPLIANCE WITH THE OCCUPATIONAL HEALTH AND SAFETY ACT AND THE MINISTRY OF TRANSPORTATION ROADSIDE SAFETY MANUAL.
5. EXISTING DRAINAGE PATTERNS TO BE MAINTAINED.
6. NOISE LEVELS SHALL BE KEPT IN ACCORDANCE WITH THE APPLICABLE MUNICIPALITIES BY LAWS AND REGULATIONS.
7. FENCED FROM WALKWAY TO BE KEPT CLEAR OF OBSTRUCTIONS AT ALL TIMES.
8. CONSTRUCTION ZONE TO HAVE SUPPLEMENTARY REPLACEMENT STREET & PEDESTRIAN LIGHTING (REQUIREMENTS TO BE DETERMINED BY THE CITY OF BARRIE).
9. ALL TRAFFIC SIGNALS & POLES, TRAFFIC CONTROLLERS, LIGHT STANDARDS, UTILITY POLES, SIGN POSTS, STREET FURNITURE, PIPE BARRIERS, TRAFFIC PARKING CONTROL, SIGNAGE, REMOVAL/RELOCATION/REPLACEMENT SHALL BE BY THE APPLICABLE MUNICIPALITY OR APPROPRIATE UTILITY COMPANY/TRANSPORTATION AUTHORITY.
10. CROSS SECTION ITEMS, INCLUDING BUT NOT LIMITED TO, COVERED WALKWAY ARE FOR ILLUSTRATIVE PURPOSES ONLY. DETAILED DESIGN OF THESE ITEMS TO BE DESIGNED BY OTHERS.

EROSION & SEDIMENT CONTROL NOTES

1. ALL CONSTRUCTION FENCING WILL BE LINED WITH A SILT FENCE TO ALLOW WATER PASSAGE AND RESTRICT SILT AND SOIL COMPOUNDS.
2. MUD MATS WILL BE POSITIONED AT ALL CONSTRUCTION ACCESS POINTS TO LIMIT THE AMOUNT OF DIRT LEAVING THE SITE.
3. ALL EXISTING AND PROPOSED CATCHBASINS WITHIN THE SITE AND WITHIN THE PUBLIC RIGHT-OF-WAY, ADJACENT TO THE SITE ARE TO BE EQUIPPED WITH INLET SEDIMENT CONTROL TRAPS.
4. THE SWATHING PROCESS WILL INVOLVE A LICENSED CONTRACTOR AND WILL CONFORM TO MINISTRY OF ENVIRONMENT GUIDELINES AND REGULATIONS.
5. ALL REMOVAL, DISPOSAL OF EXCAVATION AND DEMOLITION MATERIALS WILL BE TRANSPORTED TO LICENSED DUMP STATION AS PER MINISTRY OF ENVIRONMENT GUIDELINES AND REGULATIONS.
6. SCHEDULED STREET MAINTENANCE ALONG THE LOCAL STREETS SURROUNDING THE DEVELOPMENT SITE WILL BE PROVIDED DURING THE CONSTRUCTION PERIOD.

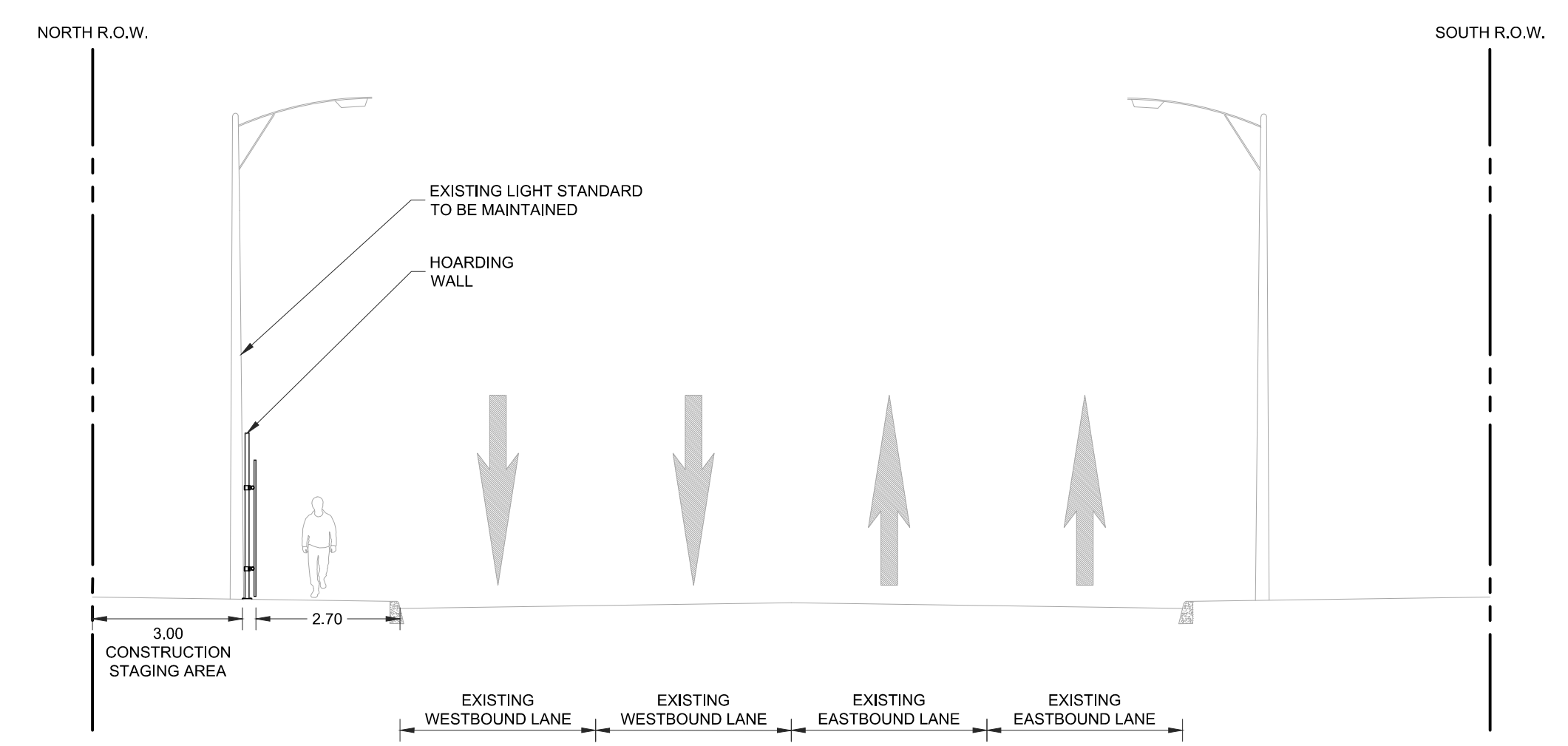
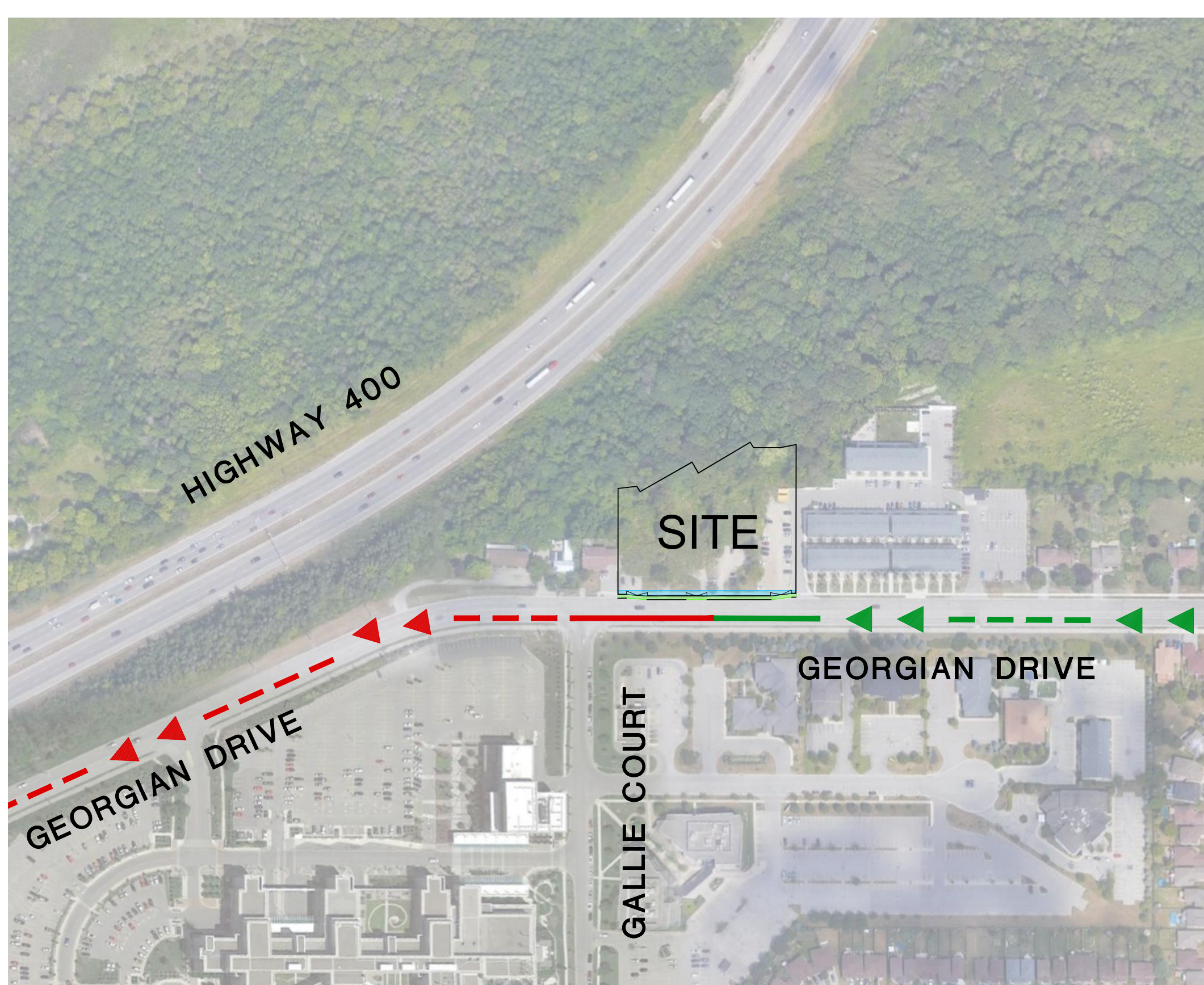
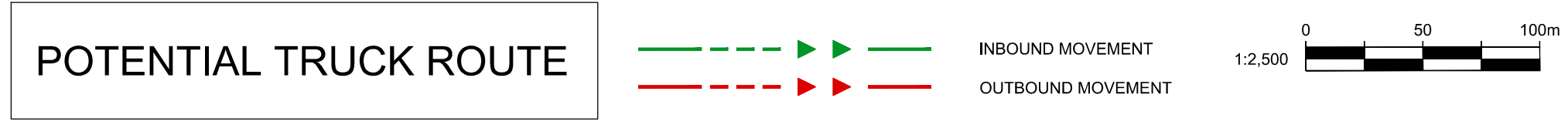

GEORGIAN DRIVE SECTION A-A N.T.S.

NOTE:
A. COVERED WALKWAY IS FOR ILLUSTRATIVE PURPOSES ONLY. DETAIL DESIGN TO BE COMPLETED BY OTHERS

- NOTE:
- A. CONSTRUCTION VEHICLE QUEUING TO OCCUR ON PRIVATE OFF-SITE PROPERTY AND WILL NOT REQUIRE THE USE OF PUBLIC RIGHT-OF-WAY.
 - B. PARKING FOR CONSTRUCTION PERSONNEL WILL BE PROVIDED THROUGH A SEPARATE AGREEMENT WITH NEARBY PRIVATE SITE OWNERS. CONSTRUCTION PERSONNEL WILL NOT UTILIZE ON-STREET PARKING.
 - C. MUD MAT AS PER CITY OF BARRIE STANDARD "BSD-23D"

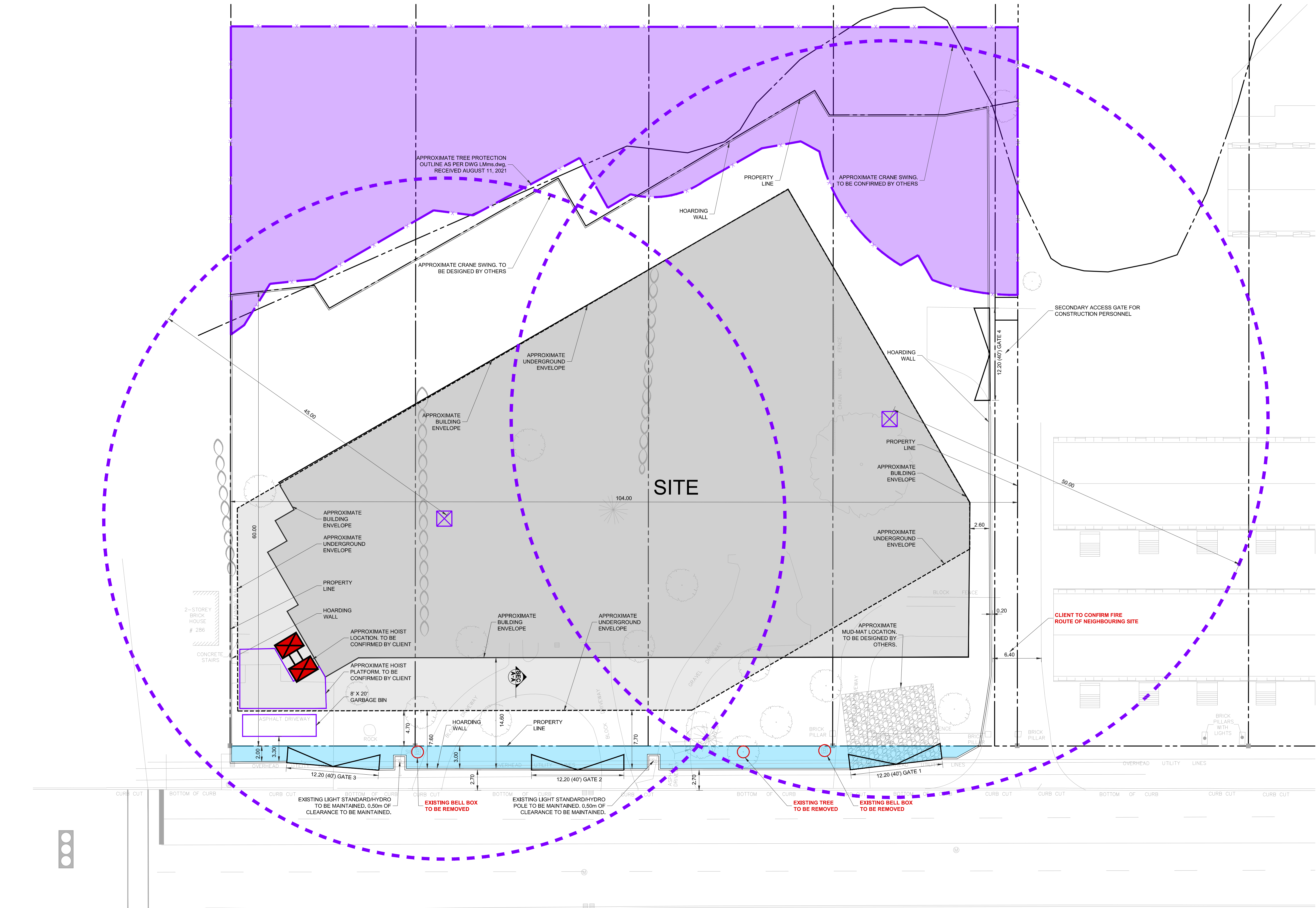

GEORGIAN DRIVE

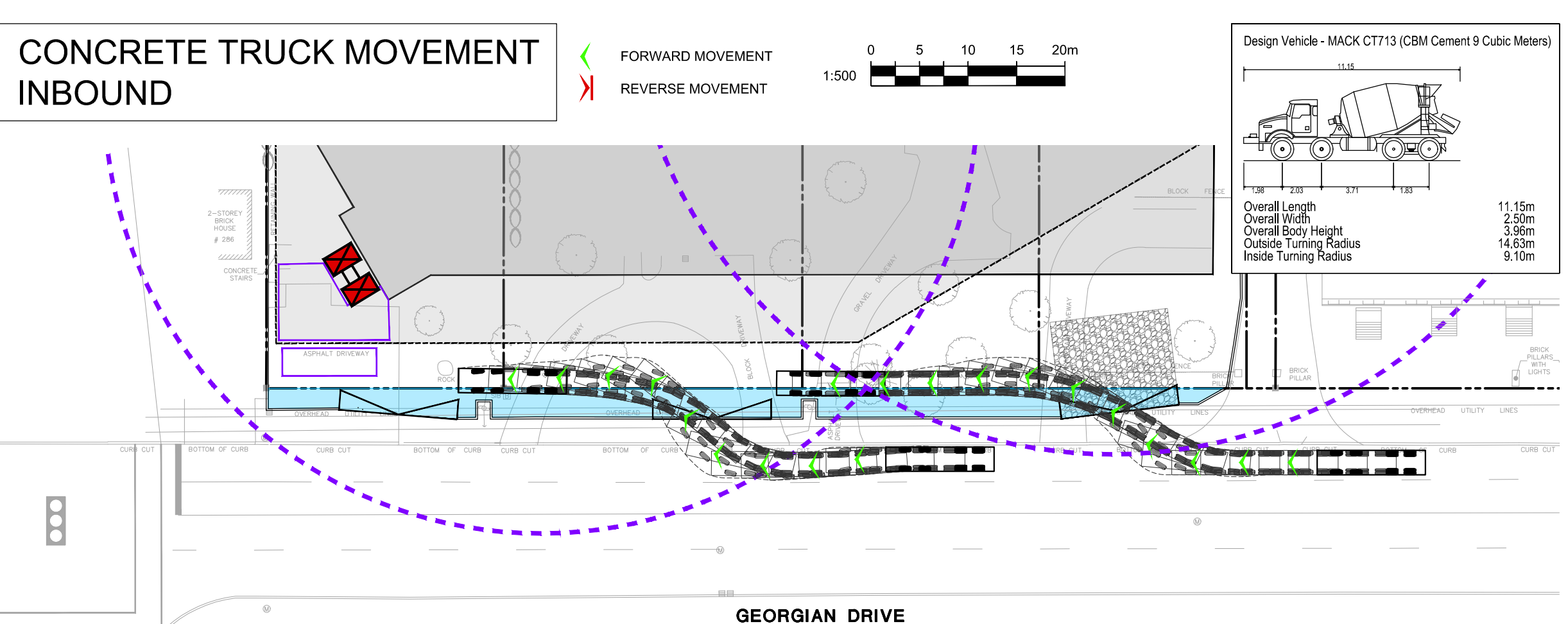

GEORGIAN DRIVE

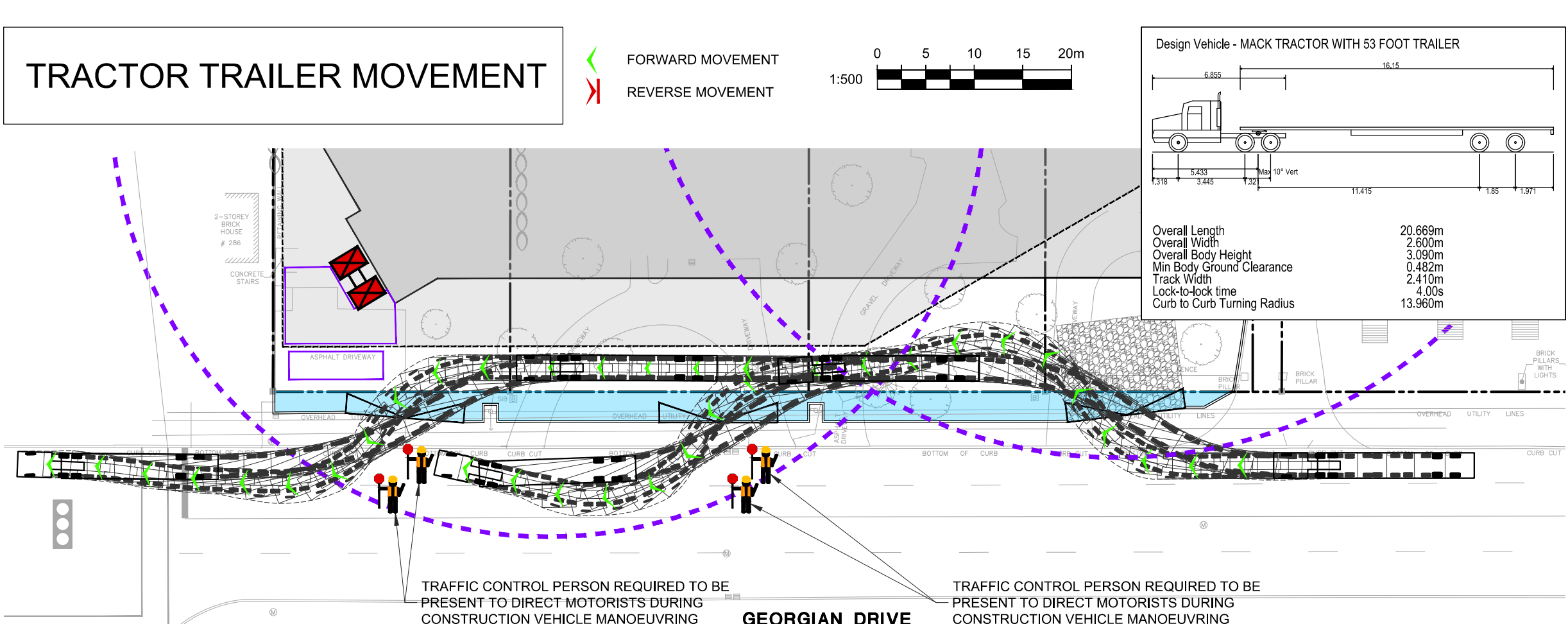

GEORGIAN DRIVE

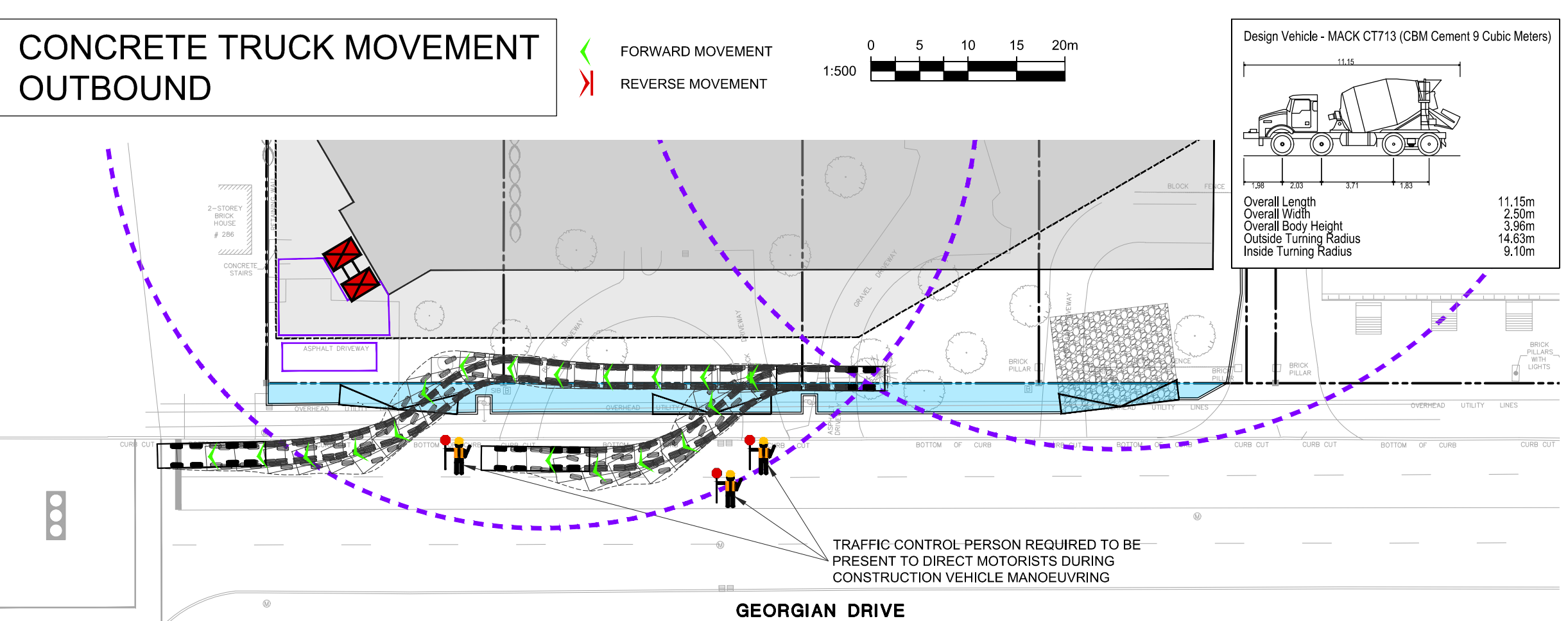

GEORGIAN DRIVE

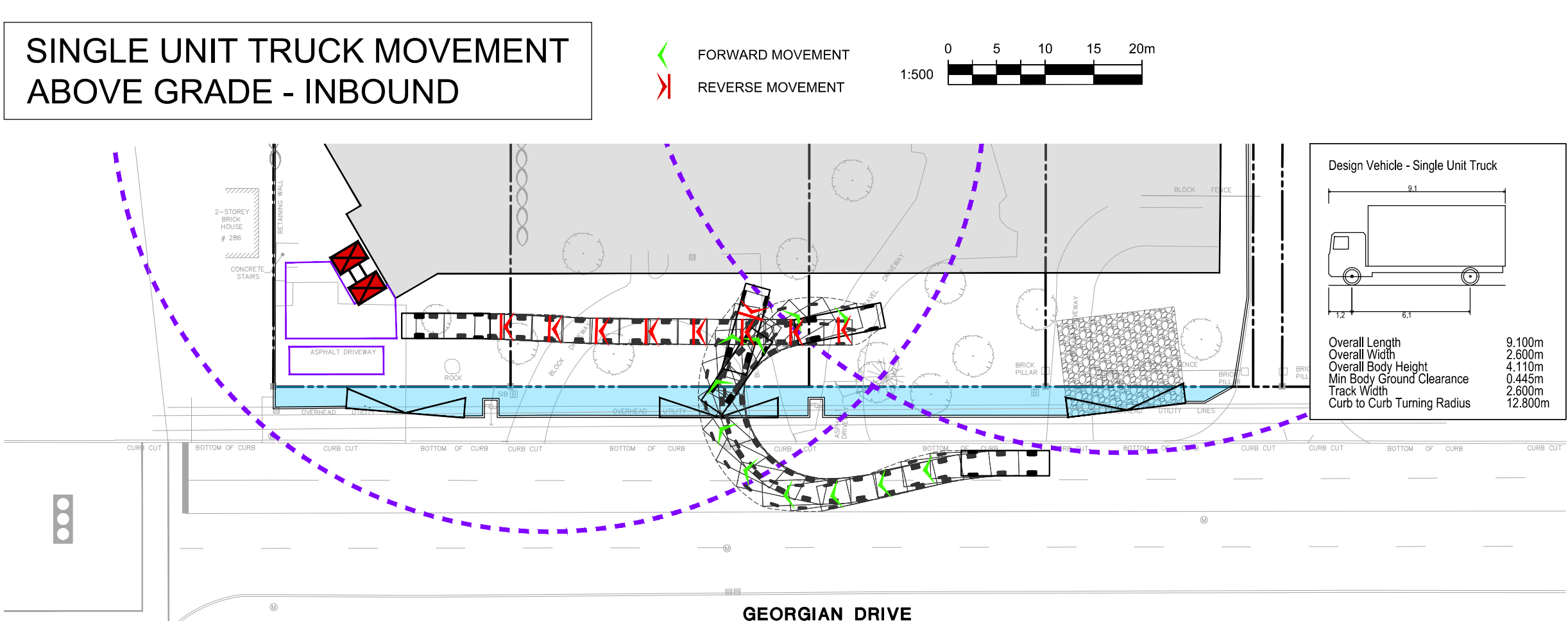

GEORGIAN DRIVE

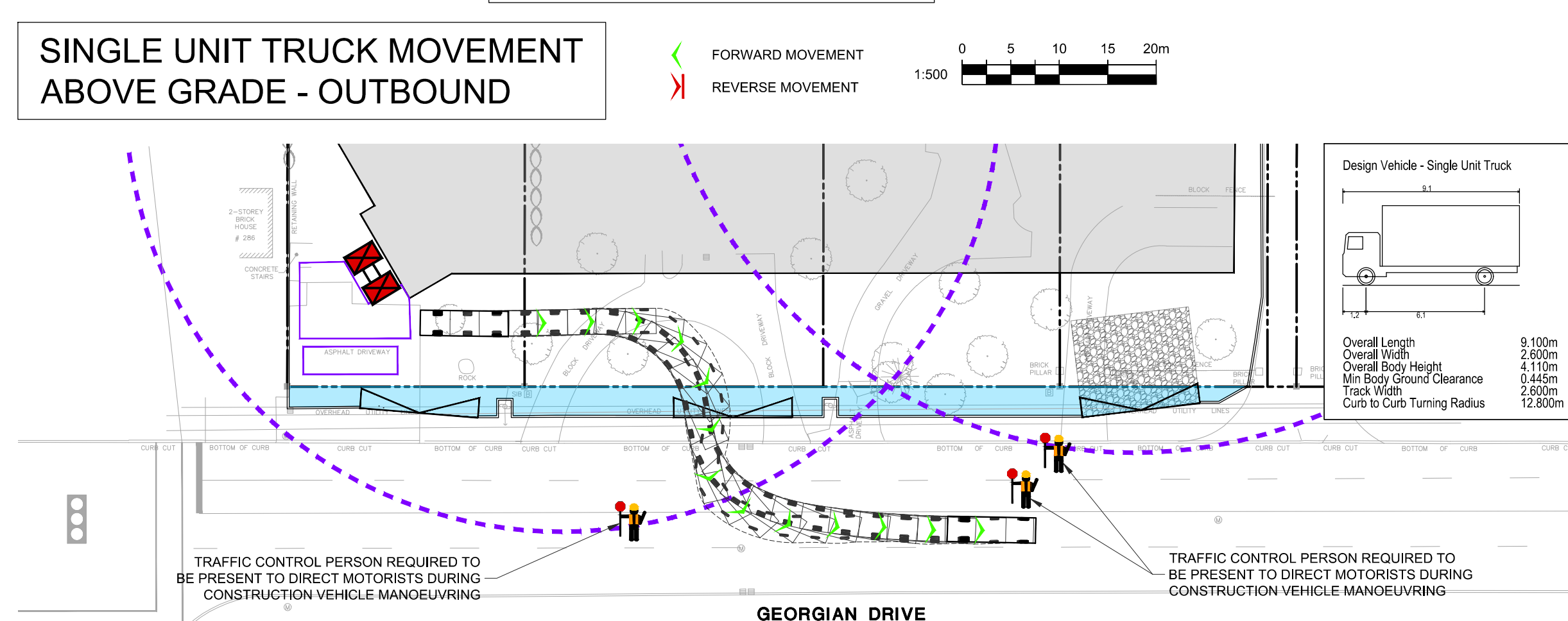

GEORGIAN DRIVE

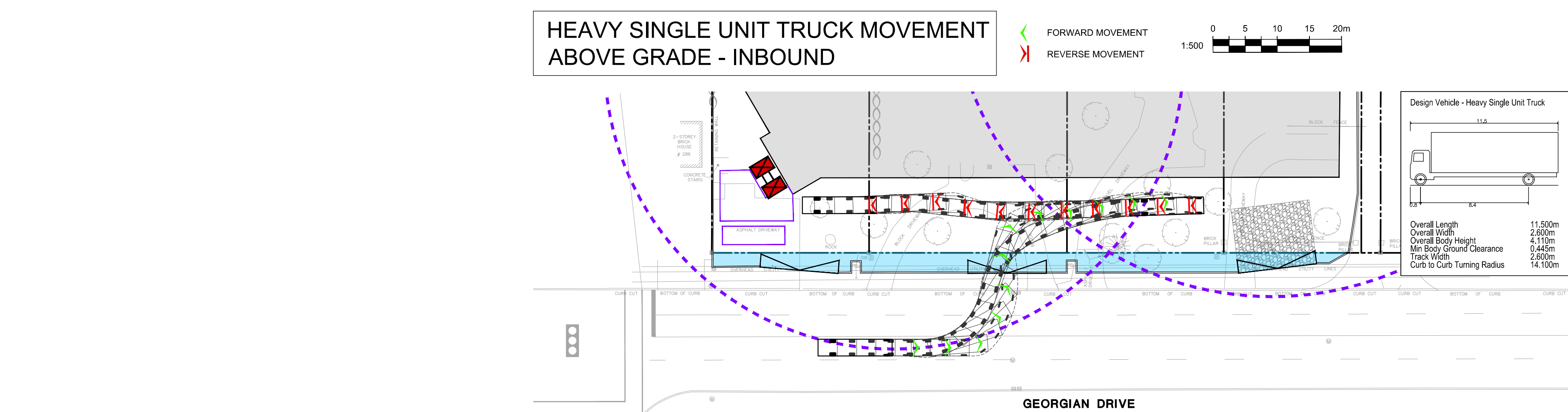

GEORGIAN DRIVE

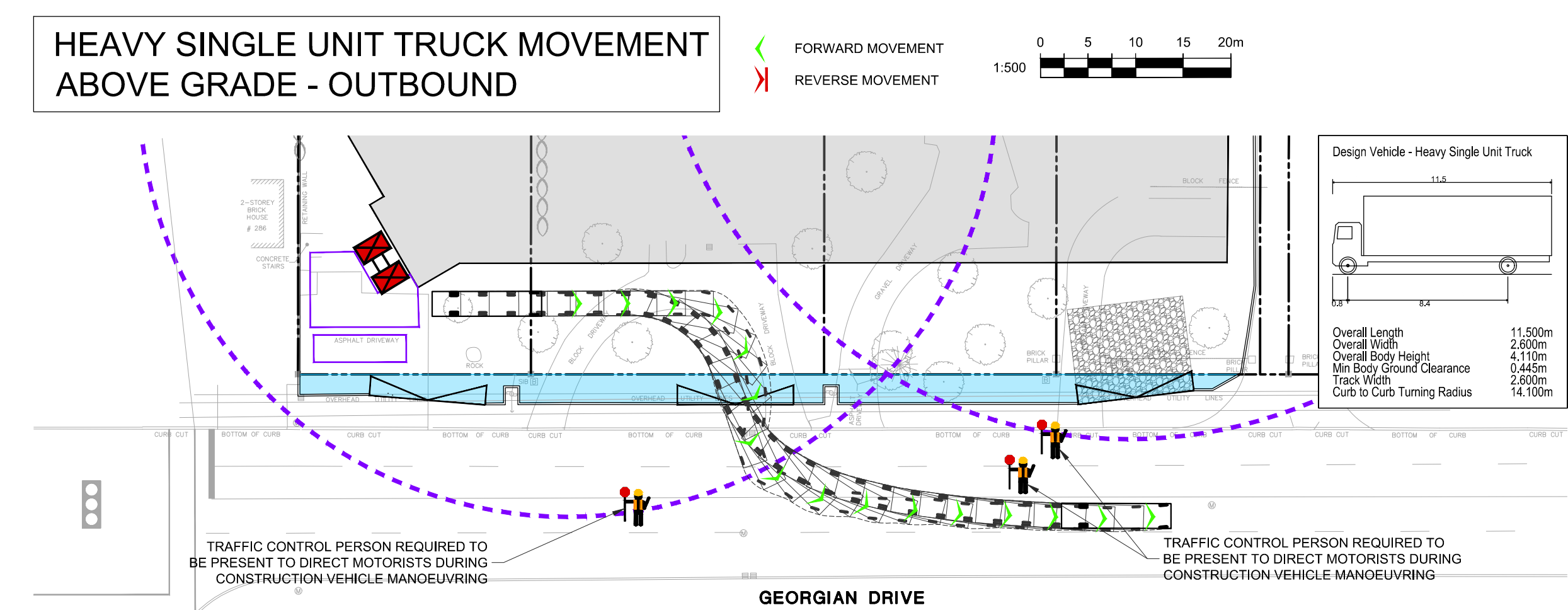

GEORGIAN DRIVE

- 04 08-20-02 RPM ISSUED TO CLIENT FOR CITY SUBMISSION
- 03 08-20-02 BRC ISSUED TO CLIENT FOR CITY SUBMISSION
- 02 08-11-21 BRC ISSUED TO CLIENT FOR REVIEW
- 01 08-10-21 RPM ISSUED TO CLIENT FOR REVIEW
- 00 08-05-21 RPM ISSUED TO CLIENT FOR PRELIMINARY REVIEW
- 00 08-04-19 INT REVISION NOTE

THIS CONSTRUCTION MANAGEMENT PLAN AND CONTAINED CONSTRUCTION LOGISTICS ARE PRELIMINARY AND SUBJECT TO CHANGE. THIS PLAN IS INTENDED TO SUPPORT THE PLANNING PROCESSES OF RE-ZONING AND/OR SITE PLAN APPLICATION. NOT THE PERMIT APPLICATION FOR RIGHT-OF-WAY OCCUPANCY.

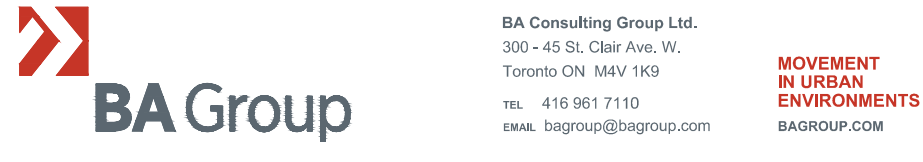

290 GEORGIAN DRIVE

CONSTRUCTION MANAGEMENT PLAN

Date: AUGUST 05, 2021
Project No: 8052-06
Scale: 1:250