

535 BAYFIELD STREET, BARRIE, ONTARIO

TWO (2) PROPOSED MIXED USE BUILDINGS

C-1

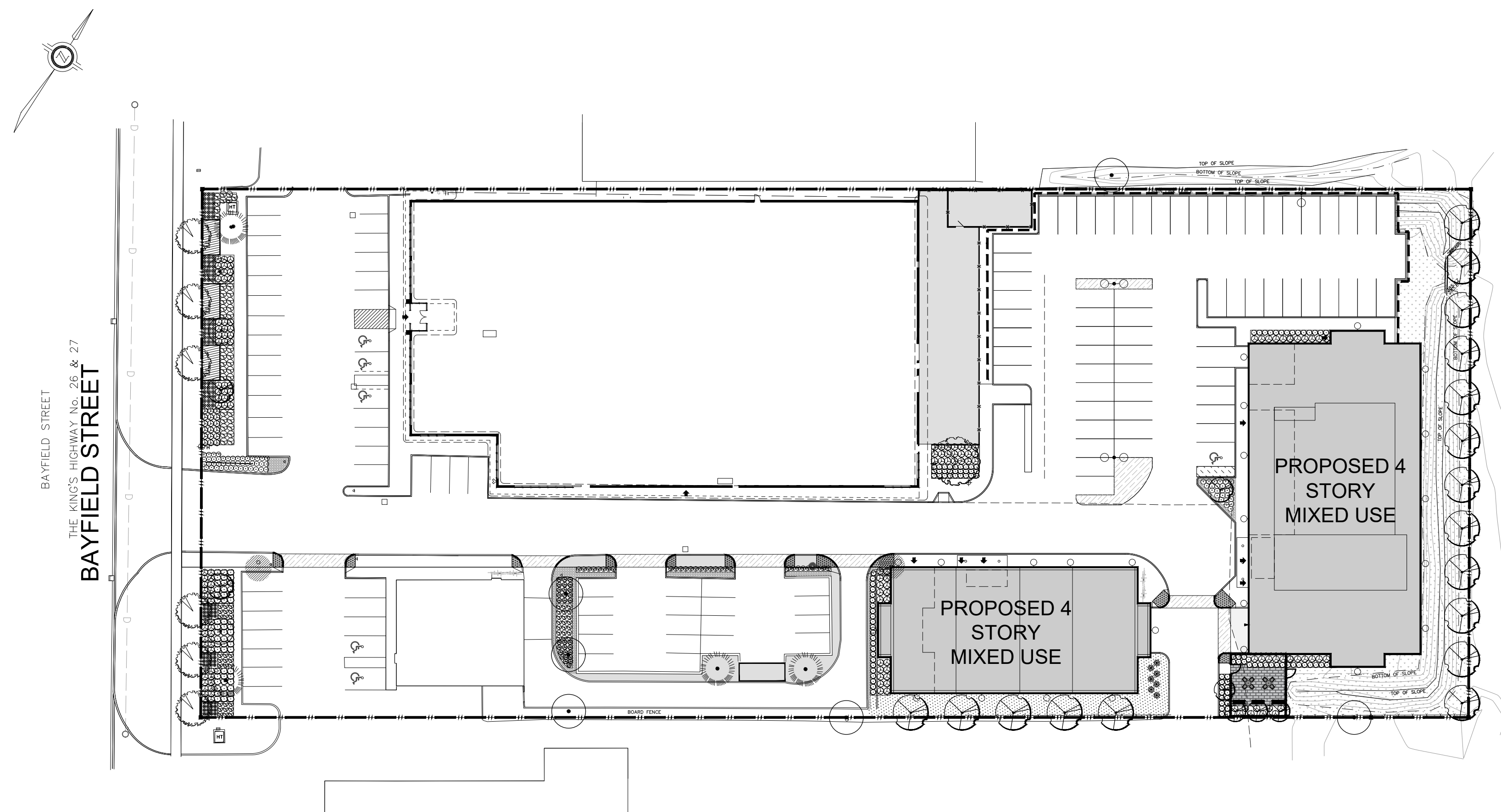

MASTER PLAN KEY MAP

1:500

LIST OF DRAWINGS:

C-1	COVER PAGE AND MASTER PLAN KEY MAP
L-1	LANDSCAPE PLAN
LD-1	DETAILS AND NOTES
LD-2	DETAILS



John Shank, OALA, CSLA, Principal
95 Mural Street, Suite 207, Richmond Hill, ON L4B 3G2
Tel: 905.669.6838, www.landscapeplan.ca

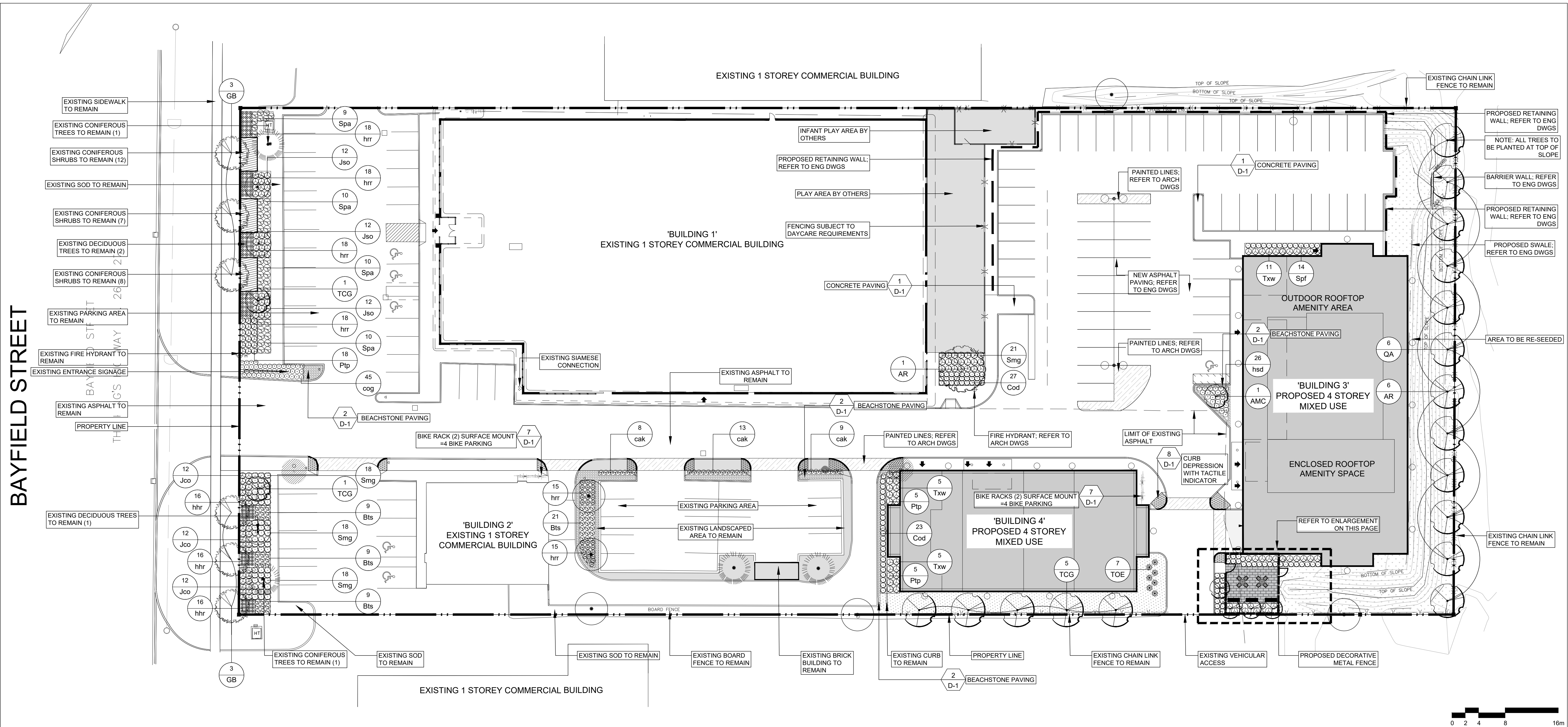

BAYFIELD STREET

CITY STAMP:

LEGEND:

- PROPERTY LINE
- DECORATIVE METAL FENCE
- EXISTING TREES TO REMAIN
- EXISTING SHRUB BEDS TO REMAIN
- EXISTING TREES TO BE REMOVED
- PROPOSED DECIDUOUS TREES
- PROPOSED R.O.W TREES
- PROPOSED CONIFEROUS TREES
- PROPOSED DECIDUOUS SHRUBS
- PROPOSED CONIFEROUS SHRUBS
- PROPOSED PERENNIALS/GRASSES
- BIKE RACKS (4 UNITS / 8 BIKES)
- SOD
- UNIT PAVING
- SEED
- BEACH STONE
- PAINTED LINES
- LIGHTING FIXTURES; REFER TO ELECTRICAL DWGS

RT	SITE PLAN APPLICATION SUBMISSION	3/9/2023	MN
RT	SITE PLAN APPLICATION SUBMISSION	3/3/2023	MN
RD	TEAM COORDINATION	1/30/2023	MN
no.	revision	date	by

THESE DRAWINGS ARE THE PROPERTY OF LANDSCAPE PLANNING LIMITED AND SHALL NOT BE ALTERED, MODIFIED, REVISED OR CHANGED WITHOUT THE WRITTEN CONSENT OF LANDSCAPE PLANNING LIMITED. SEALS NOT VALID WITHOUT SIGNATURE OF THE LANDSCAPE ARCHITECT. DRAWINGS CANNOT BE USED FOR TENDER/CONSTRUCTION UNTIL SIGNED BY LANDSCAPE ARCHITECT.

PLANT LIST - SHEET L-1.0

DECIDUOUS TREES								
Count	Key	BOTANICAL NAME	COMMON NAME	CALIPER	HEIGHT	ROOT	SPREAD	NOTE
7	AR	Acer rubrum	Red Maple	60mm	-	-	-	-
1	AMC	Amelanchier canadensis	Serviceberry	60mm	-	-	-	-
7	TCG	Tilia cordata "Greenspire"	Greenspire Linden	60mm	-	-	-	-
6	QA	Quercus alba	White Oak	60mm	-	-	-	-
4	SGI	Syringa reticulata "Ivory Silk"	Ivory Silk Tree Lilac	60mm	-	-	-	-
6	GB	Ginkgo biloba	Maidenhair Tree	60mm	-	-	-	-

CONIFEROUS TREES								
Count	Key	BOTANICAL NAME	COMMON NAME	CALIPER	HEIGHT	ROOT	SPREAD	NOTE
7	TOE	Thuja occidentalis "Emerald"	Emerald Cedar	-	200CM	-	-	-

DECIDUOUS SHRUBS								
Count	Key	BOTANICAL NAME	COMMON NAME	CALIPER	HEIGHT	ROOT	SPREAD	NOTE
66	Cod	Cornus sericea "Kelsey"	Kelsey Dwarf Dogwood	-	-	-	-	-
36	Spf	Spiraea japonica "Goldflame"	Goldflame Spirea	-	-	-	-	-
39	Spa	Spiraea bumalda "Anthony Waterer"	Anthony Waterer Spirea	-	-	-	-	-
28	Ptp	Potentilla fruticosa "Pink Beauty"	Pink Beauty Potentilla	-	-	-	-	-
75	Smg	Spiraea x "Gold Mound"	Gold Mound Spirea	-	-	-	-	-
48	Bts	Berberis thunbergii "Sunsation"	Sunsation Japanese Barberry	-	-	-	-	-

CONIFEROUS SHRUBS								
Count	Key	BOTANICAL NAME	COMMON NAME	CALIPER	HEIGHT	ROOT	SPREAD	NOTE
32	Twx	Taxus media "Ward"	Ward's Yew	-	40cm	-	-	-
36	Jso	Juniperus scopulorum "Moffetti"	Moffet's Blue Juniper	-	-	-	-	-
36	Jco	Juniperus communis	Common Juniper	-	-	-	-	-
9	Jst	Juniperus sabina "Tamariscifolia"	Tamarix Juniper	-	-	-	-	-

PERENNIALS AND GRASSES								
Count	Key	BOTANICAL NAME	COMMON NAME	CALIPER	HEIGHT	ROOT	SPREAD	NOTE
26	hsd	Hemerocallis "Stella D'oro"	Stella d'Oro Daylily	-	-	-	-	-
102	hrr	Hemerocallis "Rosy Returns"	Rosy Returns Daylily	-	-	-	-	-
30	cak	Calamagrostis acutiflora "Karl Foerster"	Karl Foerster Feather Reed Grass	-	-	-	-	-
45	cog	Coreopsis grandiflora "Early Sunrise"	Early Sunrise Tickseed	-	-	-	-	-
48	hhr	Hemerocallis "Happy Returns"	Happy Returns Daylily	-	-	-	-	-

ITEM	PLANT TYPE	DENSITY FORMULA	CITY REQUIREMENT (ENTIRE PROJECT SITE)	PROPOSED QUANTITY (ENTIRE PROJECT SITE)
1	Deciduous Trees	SITE AREA (SQ.M) / 300 = # OF DECIDUOUS TREES	46	40
2	Evergreen Trees	SITE AREA (SQ.M) / 500 = # OF EVERGREEN TREES	28	11
3	Deciduous Shrubs	SITE AREA (SQ.M) / 50 = # OF DECIDUOUS SHRUBS	278	292
4	Evergreen Shrubs	SITE AREA (SQ.M) / 100 = # OF EVERGREEN SHRUBS	140	140

REFER TO LD-1 FOR GENERAL CONSTRUCTION AND PLANTING NOTES

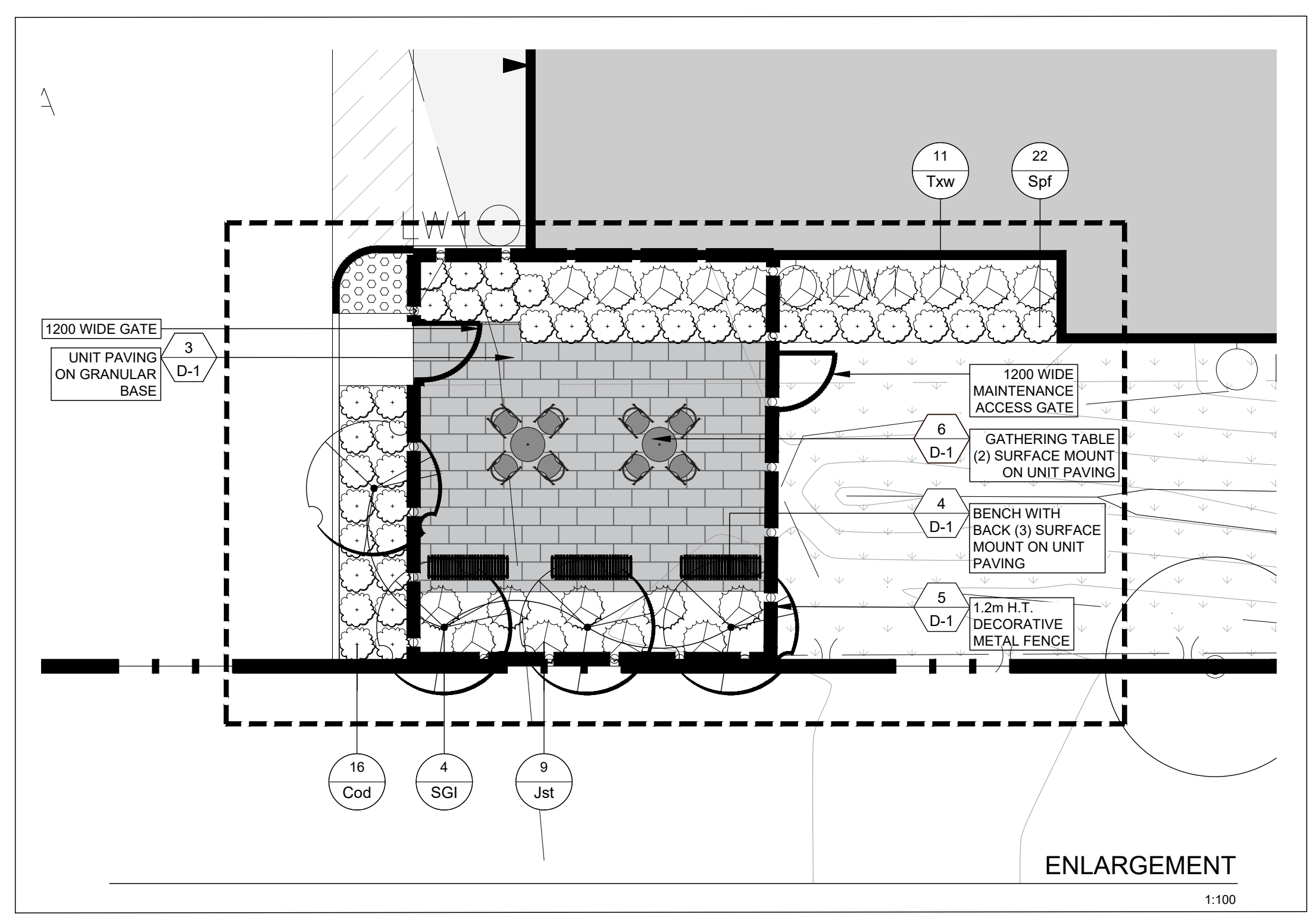

project number
2023-019

Suite 207, 95 Mural Street, Richmond Hill, Ontario L4B 3G2, Tel. 905.669.6838, www.landscapeplan.ca

project title
BAYFIELD COMMERCIAL DEVELOPMENT

535 BAYFIELD STREET, BARRIE, ON, L4M 4Z9

city file:
municipality: BARRIE

drawing title
LANDSCAPE/SURFACE MATERIALS PLAN

drawn by MN	reviewed by JS	drawing number: L-1.0
date JAN.2023	scale 1:300	

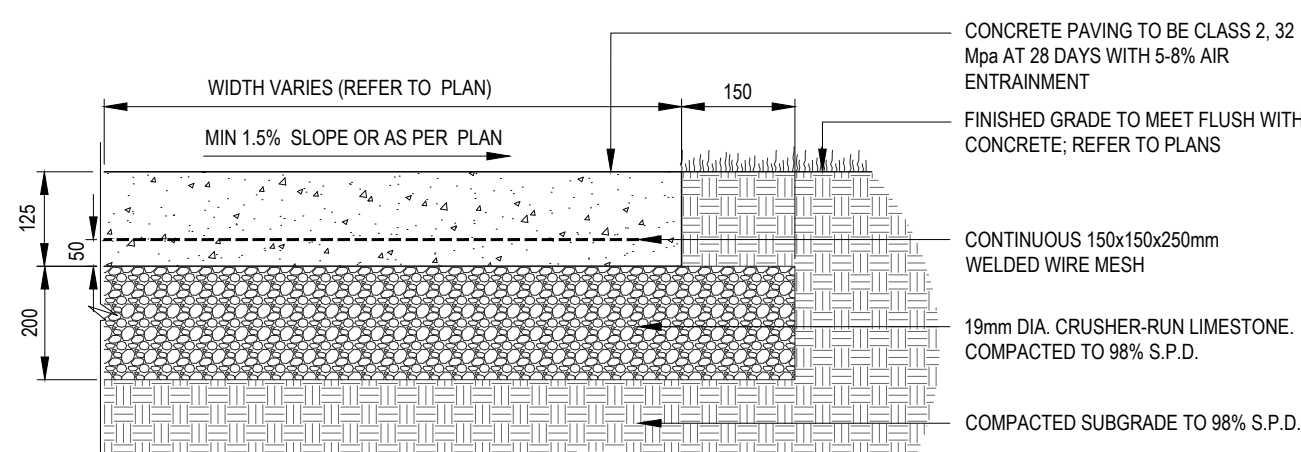

- NOTES:**
- CONTRACTOR SHALL CONTACT THE OWNER IMMEDIATELY IF UNSUITABLE OR UNSTABLE SUBGRADE IS ENCOUNTERED, SUCH AS EXCESSIVE TOPSOIL, SOFT SPOTS, & OR ORGANIC MATTER. METHODS & OR MATERIAL MUST BE APPROVED BY THE OWNER PRIOR TO COMMENCING WITH WORK. SUBGRADE TO BE CONSOLIDATED & TESTED TO 98% S.P.D.
 - CONTINUOUS BROOM FINISH PERPENDICULAR TO PATH OF TRAVEL OR AS OTHERWISE STATED ON PLANS
 - CONTRACTOR TO PROVIDE SAMPLES FOR CONSULTANT APPROVAL PRIOR TO COMPLETING INSTALLATION
 - REFER TO JOINTING DETAIL FOR CONTROL AND EXPANSION JOINTS
 - GRANULAR EDGE TO EXTEND MIN. 150mm BEYOND CONCRETE
 - CONCRETE EDGE TO BE FORMED UNIFORMLY WITH SMOOTH CLEAN EDGES
 - ADJACENT AND ADJUTING SURFACES TO MEET FLUSH WITH CONCRETE SURFACE
 - GRADE WALKWAY WITH A MIN 1.5% CROSS-SLOPE OR AS INDICATED ON PLANS. **PONDING WATER ON CONCRETE WALKWAYS WILL NOT BE ACCEPTED.**
 - ALL MEASUREMENTS ARE IN MILLIMETRES UNLESS STATED OTHERWISE
 - REFER TO PLANS

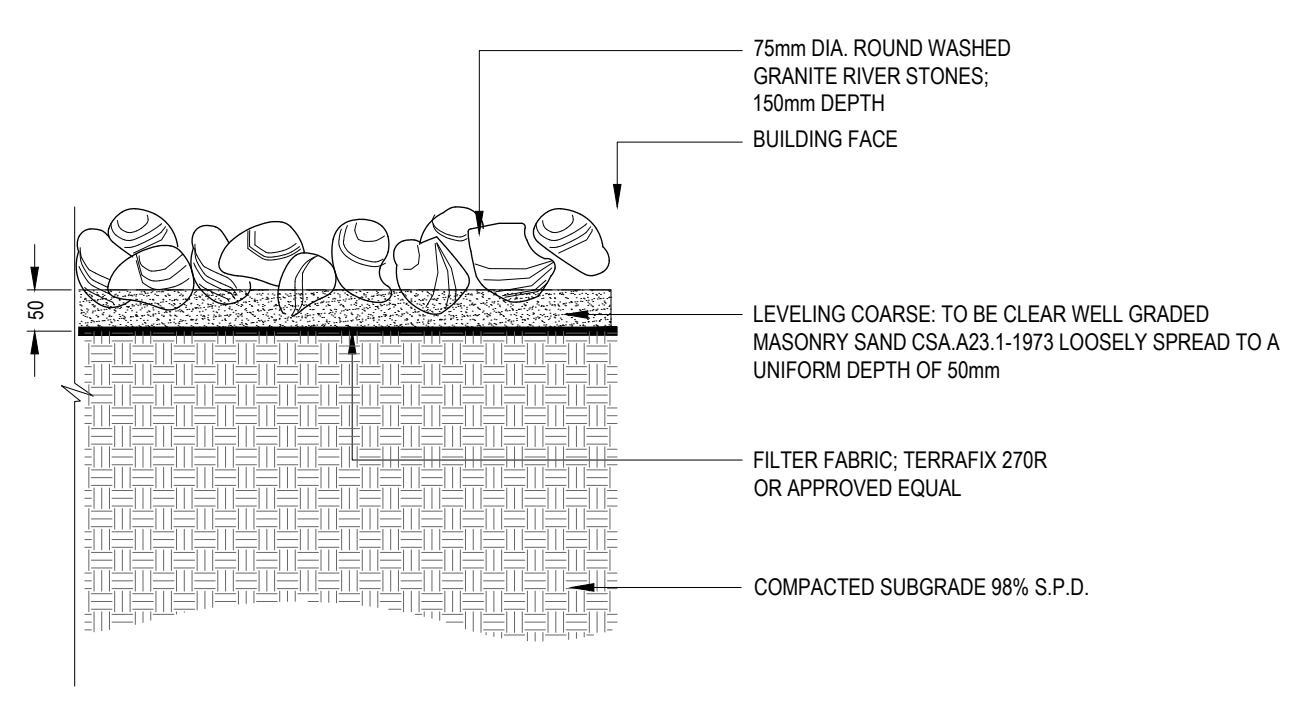

- NOTES:**
- BEACHSTONE SHALL BE FREE FROM CRACKS AND FISSURES, AND SHALL BE FREE FROM SAND AND CLAY AND OTHER DELETERIOUS MATERIAL
 - BEACHSTONE SHALL BE PLACED OVER THE LIMESTONE SCREENING BEDDING COURSE SUCH THAT AN OVERALL LEVEL APPEARANCE IS ACHIEVED WITHOUT VOIDS
 - ALL MEASUREMENTS ARE IN MILLIMETRES UNLESS STATED OTHERWISE
 - REFER TO LANDSCAPE PLAN

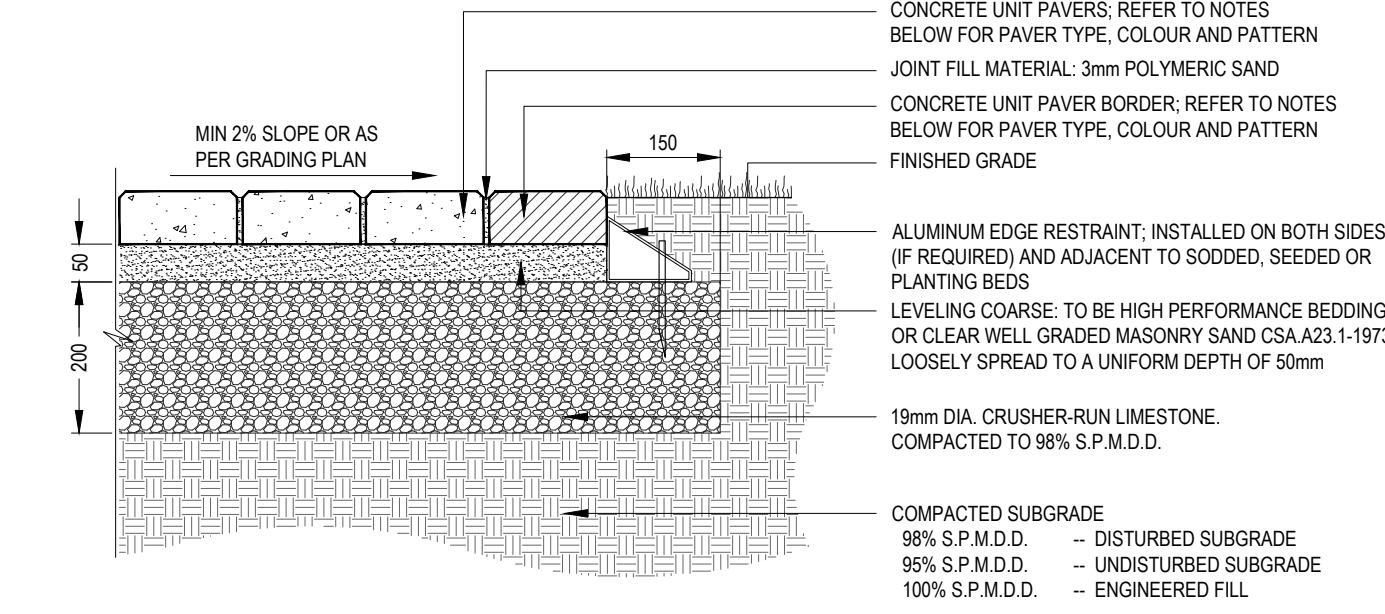

- NOTES:**
- AS REQUIRED, CONTRACTOR SHALL CONTACT THE OWNER IMMEDIATELY IF UNSUITABLE OR UNSTABLE SUBGRADE IS ENCOUNTERED, SUCH AS EXCESSIVE TOPSOIL, SOFT SPOTS, & OR ORGANIC MATTER. METHODS & OR MATERIAL MUST BE APPROVED BY THE OWNER PRIOR TO COMMENCING WITH WORK. SUBGRADE TO BE CONSOLIDATED & TESTED TO 98% S.P.M.D.D. MIN. ENGINEERED FILL TO BE CONSOLIDATED & TESTED TO 100% S.P.M.D.D.
 - WHERE REQUIRED, CUT UNIT PAVERS WITH AN APPROVED CUTTER TO FIT ACCURATELY, NEATLY AND WITHOUT DAMAGED EDGES
 - AFTER LAYING UNIT PAVERS ON UN-COMPACTED, SCREENED SAND BEDDING OR HIGH PERFORMANCE BEDDING COURSE, COMPACT ENTIRE PAVED AREA TO ACHIEVE CONSOLIDATION OF THE BEDDING USING A SUITABLE PLATE COMPACTOR
 - AFTER COMPACTION, JOINTING SAND SHALL BE SPREAD OVER PAVING AND SWEEP INTO JOINTS
 - GRANULAR EDGE TO EXTEND MIN 150mm BEYOND CONCRETE
 - GRADE WALKWAY WITH A MIN 2% CROSS-SLOPE OR AS DIRECTED ON SITE. **PONDING WATER ON UNIT PAVING WALKWAYS WILL NOT BE ACCEPTED.**
 - SOD TO MEET & MATCH EXISTING GRADES, WITH SMOOTH TRANSITIONS AT A MAXIMUM SLOPE OF 4:1
 - ALL SEEDS & OR SOODED AREAS SHALL BE 25mm BELOW THE FINISH ELEVATION OF UNIT PAVING WALKWAY.
 - ALL MEASUREMENTS ARE IN MILLIMETRES UNLESS STATED OTHERWISE
 - REFER TO GRADING & SURFACE MATERIALS PLANS

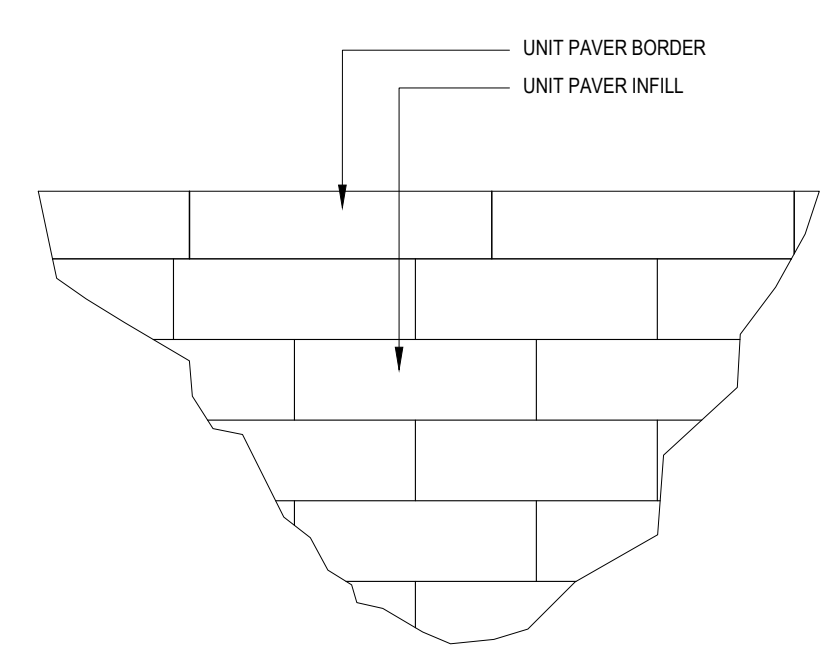

CONCRETE UNIT PAVES SCHEDULE				
LOCATION	MANUFACTURER	TYPE	PATTERN	COLOUR/FINISH
BORDER 1	UNLOCK	IL CAMPO - 30x10x7cm STONE	SAILOR COURSE	BLACK SAND
INFILL 1	UNLOCK	ARTLINE PAVES	ARTLINE A	GRANITE FLUSION

1 D-1

2 D-1

BEACHSTONE PAVING
N.T.S.

3 D-1

UNIT PAVING - STANDARD
N.T.S.

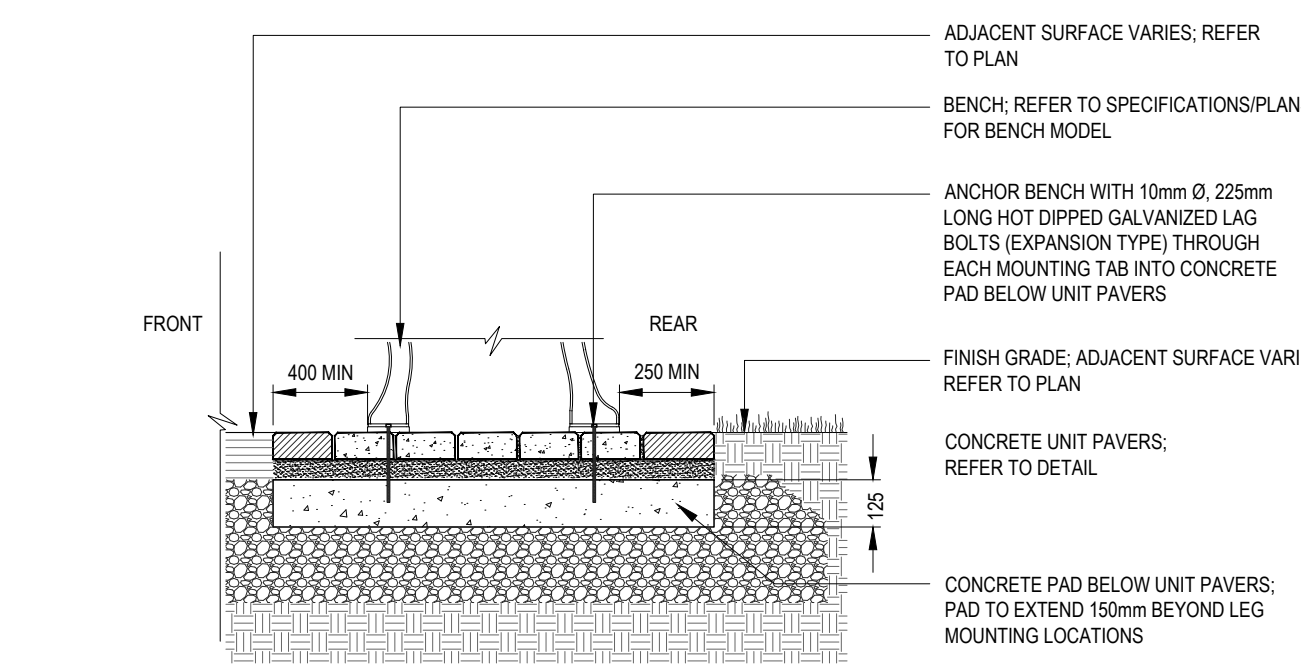

- NOTES:**
- REFER TO SPECIFICATIONS/PLANS FOR BENCH MANUFACTURER, MODEL, AND COLOUR
 - CONTRACTOR TO PROVIDE SHOP DRAWINGS
 - CONTRACTOR TO LEVEL BENCH AND SECURE / DRIVE LAG BOLTS INTO CONCRETE
 - CONTRACTOR TO DEFORM LAG BOLT HEADS ONCE INSTALLATION IS COMPLETE
 - ALL FASTENING HARDWARE TO BE HOT DIPPED GALVANIZED
 - ALL SITE FURNISHINGS TO BE FIELD LOCATED WITH SITE INSPECTOR PRIOR TO INSTALLATION
 - ALL MEASUREMENTS ARE IN MILLIMETRES UNLESS STATED OTHERWISE
 - REFER TO PLANS

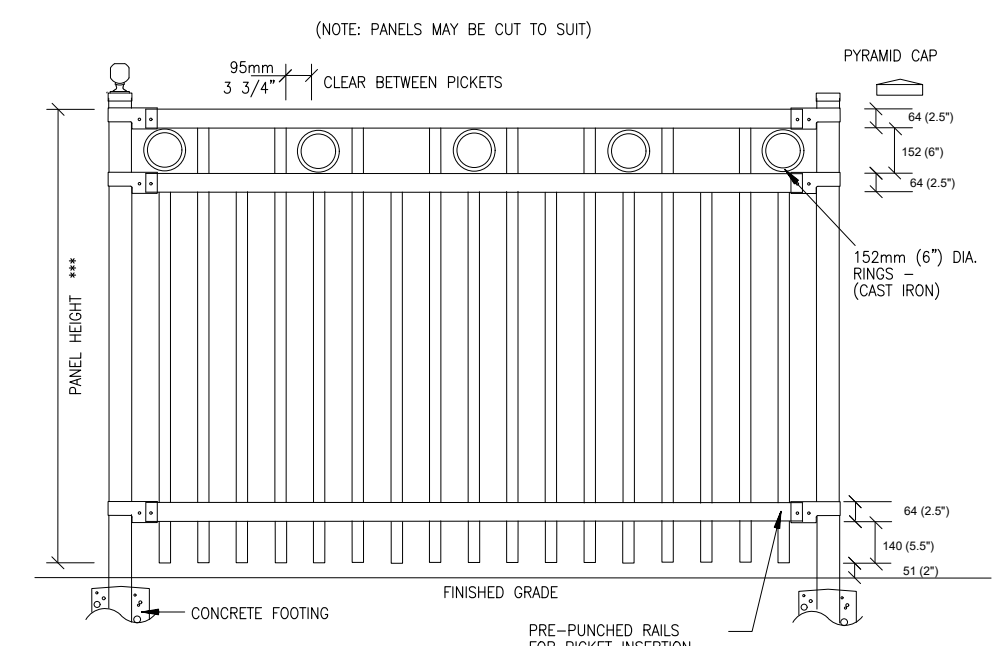

SPECIFICATIONS:	POSTS, RAILS & PICKETS:	FITTINGS:
POSTS, RAILS: COLD FORMED STEEL TUBING INTERIOR & EXTERIOR GALVALUME™ COATING CHROMIUM COPPER COATING ELECTROCHEMICALLY APPLIED THERMALLY BONDED POLYESTER POWDER COATING - MINIMUM FILM THICKNESS 2.5 mils	POSTS: 76mm x 76mm (3") x 14 GAUGE, S540 OR S24 40	FITTINGS: 12 GAUGE STAMP FORGED FACTORY FINISH AS ABOVE
POST FLANGES: 203mm x 203mm (8") x 13mm (1/2") OR 254mm x 254mm (10") x 13mm (1/2")	POST CAP: P/SMDO	WELDS: STAINLESS STEEL
RAILS: 38mm x 64mm (1 1/2" x 2 1/2") - 16 GAUGE	PICKETS: 19mm x 38mm (3/4" x 1 1/2") - 16 GAUGE	COLOURS: BLACK
		WARRANTY: 5 YEAR MAINTENANCE FREE. NOTE: ALL TYPE OF GATES AVAILABLE. TAMPER PROOF NOT AVAILABLE. E-COAT PROTECTION AVAILABLE UPON REQUEST

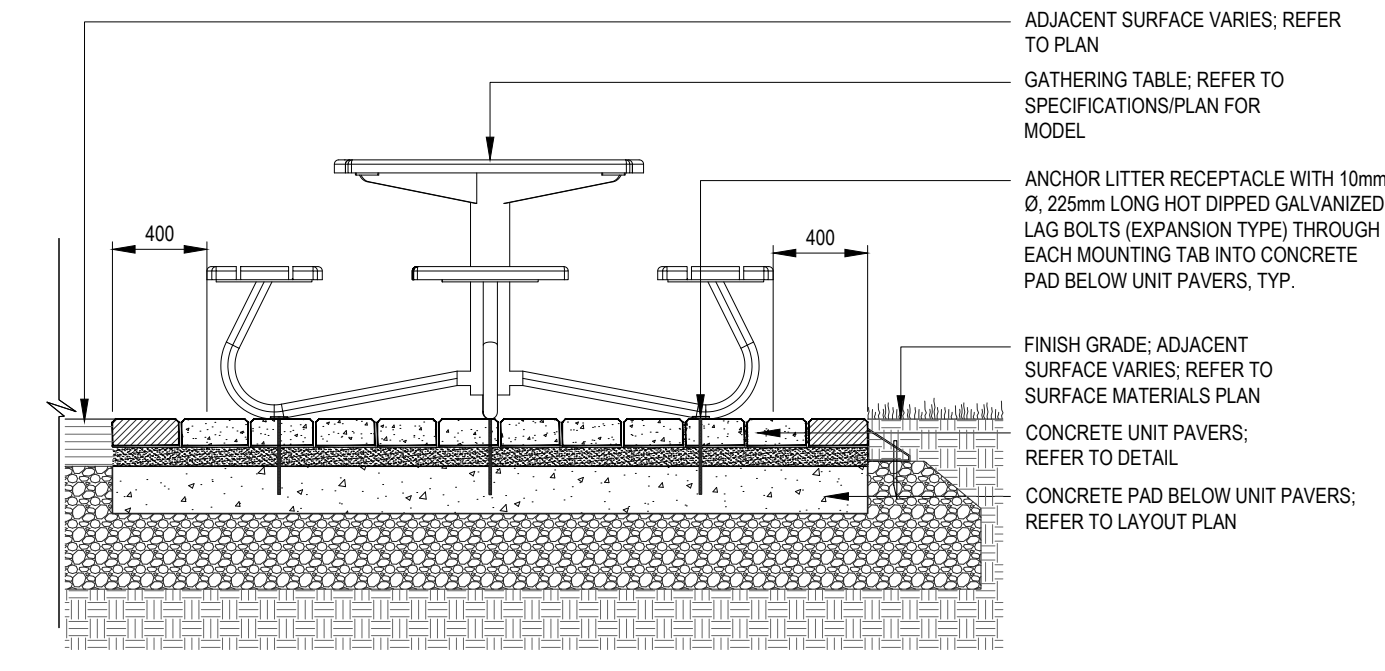

- NOTES:**
- CONTRACTOR TO REFER TO SPECIFICATIONS/PLAN FOR GATHERING TABLE MANUFACTURER, MODEL AND COLOUR
 - CONTRACTOR TO PROVIDE SHOP DRAWINGS
 - CONTRACTOR TO LEVEL, GATHERING TABLE AND SECURE / DRIVE LAG BOLTS INTO CONCRETE
 - CONTRACTOR TO DEFORM LAG BOLT HEADS ONCE INSTALLATION IS COMPLETE
 - ALL FASTENING HARDWARE TO BE HOT DIPPED GALVANIZED
 - ALL SITE FURNISHINGS TO BE FIELD LOCATED WITH SITE INSPECTOR PRIOR TO INSTALLATION
 - ALL MEASUREMENTS ARE IN MILLIMETRES UNLESS STATED OTHERWISE
 - REFER TO PLANS

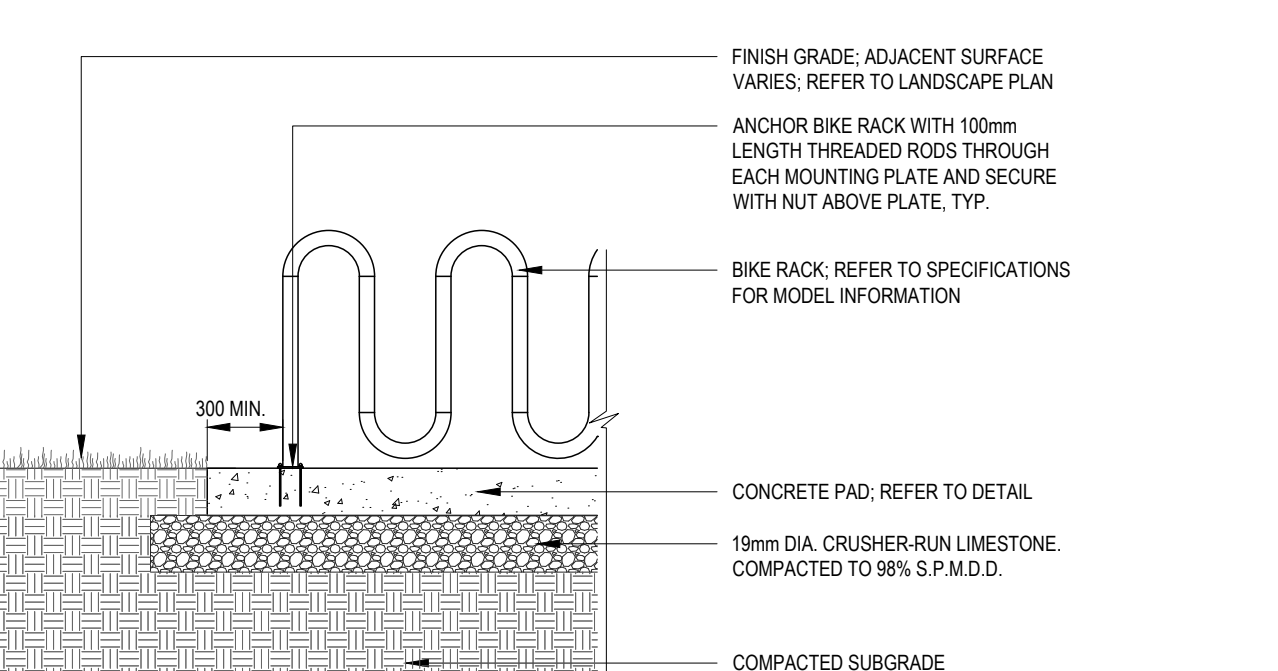

- NOTES:**
- REFER TO SPECIFICATIONS FOR BIKE RACK MANUFACTURER, MODEL, AND COLOUR
 - CONTRACTOR TO PROVIDE SHOP DRAWINGS IN ACCORDANCE WITH SPECIFICATION
 - CONTRACTOR TO LEVEL BIKE RACK AND SECURE / DRIVE THREADED RODS INTO CONCRETE
 - CONTRACTOR TO DEFORM END OF THREADED RODS ONCE INSTALLATION IS COMPLETE
 - ALL FASTENING HARDWARE TO BE HOT DIPPED GALVANIZED
 - ALL SITE FURNISHINGS TO BE FIELD LOCATED WITH SITE INSPECTOR PRIOR TO INSTALLATION
 - ALL MEASUREMENTS ARE IN MILLIMETRES UNLESS STATED OTHERWISE
 - REFER TO LAYOUT & LANDSCAPE PLANS

BENCH WITH BACK - SURFACE MOUNT ON UNIT PAVING
N.T.S.

1.2m h.t. DECORATIVE METAL FENCE
N.T.S.

GATHERING TABLE - SURFACE MOUNT ON UNIT PAVERS
N.T.S.

BIKE RACK - SURFACE MOUNT
N.T.S.

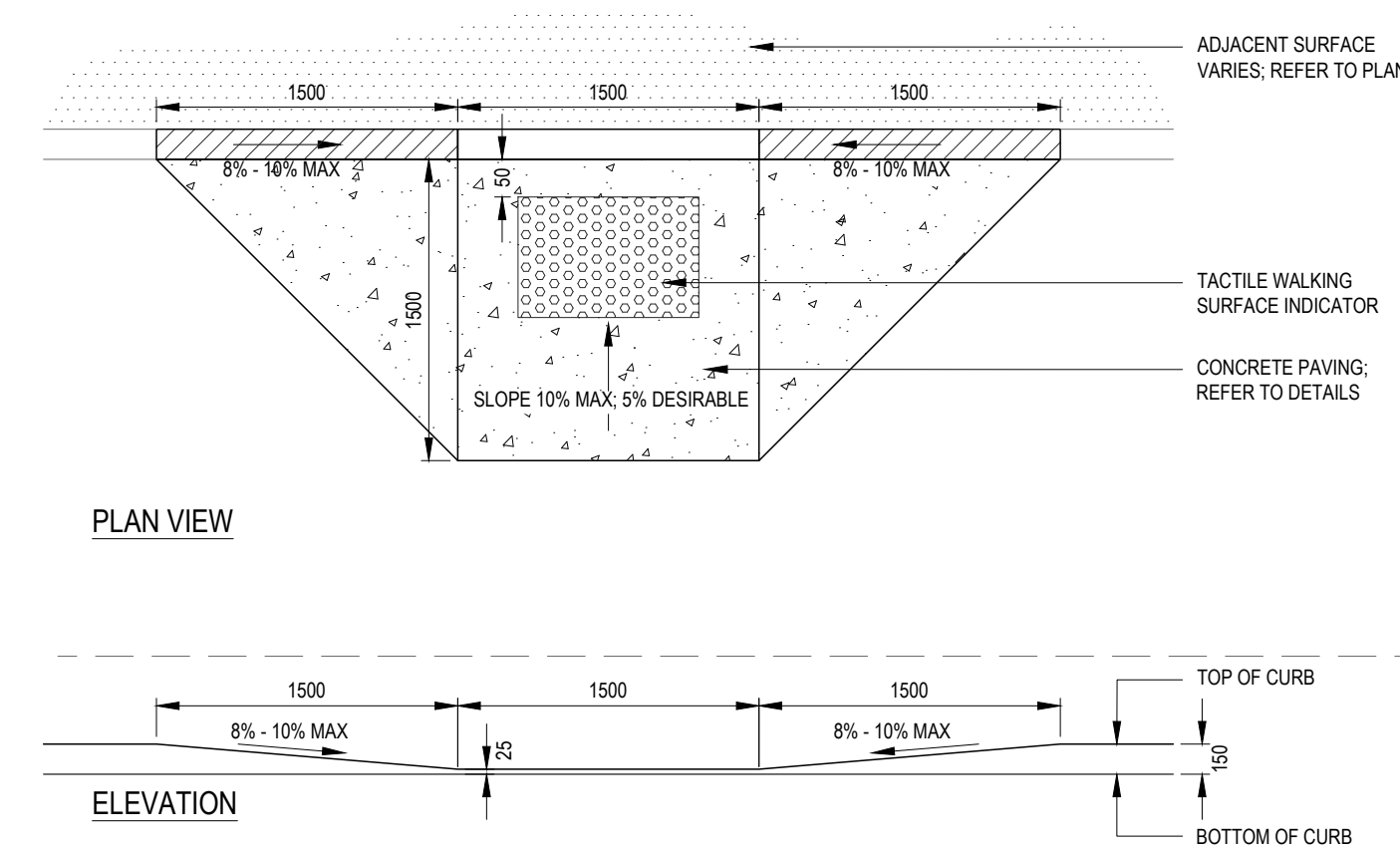

- NOTES:**
- REFER TO CONCRETE PAVING DETAILS
 - CONCRETE EDGE TO BE FORMED UNIFORMLY, SMOOTH WITH CLEAN EDGES, WITHOUT LATERAL DEVIATIONS
 - TACTILE WALKING SURFACE INDICATOR TO BE SUPPLIED BY ACCESS TILE (OR APPROVED EQUAL), REFER TO DRAWINGS FOR TACTILE INDICATOR SIZE, COLOUR TO BE FEDERAL YELLOW, REFER TO MANUFACTURERS SPECIFICATIONS
 - TACTILE WALKING SURFACE INDICATOR TO BE TRUNCATED DOME.
 - ALL MEASUREMENTS ARE IN MILLIMETRES UNLESS STATED OTHERWISE
 - REFER TO DRAWINGS

CURB DEPRESSION WITH TACTILE INDICATOR
N.T.S.

- GENERAL NOTES:**
- CONTRACTOR SHALL BE REQUIRED TO HAVE A FLAGMAN DIRECTING ALL DELIVERIES OF MACHINERY OR MATERIALS TO THE SITE.
 - CONTRACTOR SHALL PROTECT ALL IRON BARS, ANY DISTURBED BARS SHALL BE REPLACED BY OWNER AT CONTRACTOR'S EXPENSE.
 - CONTRACTOR SHALL REVIEW AND VERIFY SITE GRADES AND REPORT ANY DISCREPANCIES TO THE LANDSCAPE ARCHITECT. COMMENCEMENT OF GRADING SHALL CONSTITUTE ACCEPTANCE OF SITE CONDITIONS, NO CLAIMS FOR EXTRAS WILL BE ENTERTAINED THEREAFTER.
 - STORAGE OF MATERIALS, VEHICLES AND EQUIPMENT SHALL NOT BE PERMITTED WITHIN THE MUNICIPAL ROAD ALLOWANCE.
 - CONTRACTOR SHALL BE RESPONSIBLE TO CLEAN ROADS DAILY TO THE SATISFACTION OF THE LANDSCAPE ARCHITECT.
 - SITE SHALL BE MAINTAINED IN A CLEAN AND ORDERLY STATE FOR THE DURATION OF CONSTRUCTION. ALL WORK SHALL BE PERFORMED IN ACCORDANCE WITH THE OCCUPATIONAL HEALTH AND SAFETY ACT.
 - ALL TEMPORARY PROTECTIVE & SEDIMENT CONTROL FENCING SHALL BE MAINTAINED BY THE CONTRACTOR TO THE SATISFACTION OF THE L.A. FOR THE DURATION OF CONSTRUCTION.
 - CONTRACTOR SHALL SUPPLY & INSTALL FILTER FABRIC PROTECTION ON ALL EXISTING CATCH BASINS, WATER METER CHAMBERS, AND UTILITIES.
 - CONTRACTOR SHALL REPAIR AT HIS COST ANY DAMAGE ARISING DURING CONSTRUCTION.
 - ALL EXISTING VEGETATION TO BE RETAINED SHALL BE PROTECTED BY THE GENERAL CONTRACTOR FOR THE DURATION OF CONSTRUCTION.
 - ALL EXISTING UTILITIES SHOWN ON THE DRAWINGS ARE FOR REFERENCE PURPOSES ONLY. THE GENERAL CONTRACTOR SHALL CONTACT THE UTILITY COMPANIES FOR UTILITY STAKEOUT. THE CONTRACTOR SHALL BE RESPONSIBLE FOR ANY DAMAGES CAUSED TO EXISTING UTILITIES DURING CONSTRUCTION.
 - ALL CONSTRUCTION TO BE CARRIED OUT IN ACCORDANCE WITH THE MOST CURRENT PROVINCIAL AND MUNICIPAL STANDARDS AND SPECIFICATIONS.
 - THE CONDITION OF CURBS, SIDEWALKS, STREET TREES AND UTILITIES LOCATED WITHIN THE R.O.W. SHALL BE REVIEWED AND DOCUMENTED BETWEEN ALL PARTIES PRIOR TO THE START OF CONSTRUCTION.
 - DUST CONTROL:** CONTRACTOR SHALL TAKE ALL NECESSARY MEASURES TO CONTROL DUST ON THIS PROJECT SITE ON A DAILY BASIS AND TO THE SATISFACTION OF THE CONSULTANT.

- GENERAL PLANTING AND BED PREPARATION NOTES:**
- PLANT PERFORMANCE:**
- ALL PLANT MATERIAL SHALL BE NURSERY STOCK CONFORMING TO THE LATEST EDITION OF THE CANADIAN STANDARDS FOR NURSERY STOCK AS PUBLISHED BY THE CANADIAN NURSERY LANDSCAPE ASSOCIATION.
 - ALL PLANTS SHALL BE HEALTHY, VIGOROUS PLANTS, FREE FROM DEFECTS, DECAY, DISFIGURING ROOTS, SUN-SCALD INJURIES, BARK ABRASIONS, PLANT DISEASES AND PESTS AND ALL FORMS OF INFESTATIONS OR OBJECTIONABLE DISFIGUREMENTS.
 - ALL PLANTS SHALL BE TRUE TO NAME, SIZE, CONDITION AND QUANTITY AS PER PLAN AND PLANT LIST SPECIFICATIONS.
 - ALL PLANT MATERIAL SHALL BE UNWRAPPED PRIOR TO INSPECTION. THE LANDSCAPE ARCHITECT RESERVES THE RIGHT TO INSPECT ALL PLANT MATERIAL AND REJECT ALL MATERIAL THAT DOES NOT MEET THE STANDARDS LISTED HEREIN.
 - SUBSTITUTIONS WILL NOT BE ACCEPTED WITHOUT PRIOR WRITTEN REQUEST BY THE CONSULTING LANDSCAPE ARCHITECT. ADDITIONAL PLANT QUANTITIES WILL BE REQUIRED TO COMPENSATE FOR APPROVED REDUCTION IN SIZE DUE TO UNAVAILABILITY OF MATERIALS, TO THE SATISFACTION OF THE LANDSCAPE ARCHITECT.
 - ALL TREES SHALL BE OPEN-GROWN FOR WIND-FIRMNESS. TREES SHALL NOT BE LEANING OR HAVE SIGNIFICANT SWEEP, CROOK OR BEND. DECIDUOUS TREES SHALL HAVE APPROXIMATELY TWO-THIRDS OF THEIR TOTAL HEIGHT IN LIVING BRANCHES. ALL TREES SHALL HAVE GOOD CROWN SHAPE AND COLOUR (EVERGREENS) CHARACTERISTIC OF THEIR SPECIES. TREES SHALL HAVE A SINGLE DOMINANT LEADER WITH NO SIDE BRANCHES TALLER / LONGER THAN THE MAIN LEADER.
 - IF REQUIRED, TREES SHALL BE PROPERLY TARGET PRUNED (NEVER FLUSH CUT, TRIMMED, ROUNDED-OVER, HEDGED, TIPPED OR TOPPED) AND DEAD / DAMAGED BRANCHES SHALL BE REMOVED. BRANCHES THAT CROSS-OVER EACH OTHER OR RUB AGAINST EACH OTHER, CO-DOMINANT LEADERS, AND BRANCHES GROWING UPWARD INSIDE THE CROWN SHALL BE PROPERLY PRUNED. TREES SHALL NOT BE TREATED AT ANY TIME WITH WOUND PAINT.
 - ALL TREES SHALL HAVE ROOT BALL SIZES THAT MEET OR EXCEED NURSERY STANDARDS. ROOT BALLS SHALL BE FIRM AND STRUCTURALLY INTEGRAL WITH THE TRUNK.
 - SHRUBS AND GROUND COVERS SHALL HAVE FULL, WELL BRANCHED CROWNS TYPICAL OF SPECIES OR VARIETY. ROOT SYSTEMS SHALL BE AMPLE, WELL-BALANCED AND FIBROUS, CAPABLE OF SUSTAINING VIGOROUS GROWTH. PLANTS THAT ARE WEAK OR THIN, UNDERSIZED, OR HAVE BEEN CUT BACK FROM LARGER SPECIES TO MEET SPECIFICATIONS SHALL BE REJECTED.
 - ALL SOD SHALL BE TURFGRASS NURSERY SOD CONFORMING TO THE LATEST SPECIFICATIONS OF THE ONTARIO SOD ASSOCIATION AND THE THE NURSERY SOD GROWERS ASSOCIATION.
- TOPSOIL REQUIREMENTS:**
- | | |
|--|-------------|
| PRIVATE SIDE (SOD AND SEED): | 200mm DEPTH |
| RIGHT OF WAY (BOULEVARD AND ADJACENT TO DRIVEWAY AREAS): | 200mm DEPTH |
- TOPSOIL MAKE UP: TOPSOIL SHALL BE A FERTILE, NATURAL LOAM, CAPABLE OF SUSTAINING HEALTHY GROWTH; CONTAINING A MINIMUM OF 4% ORGANIC MATTER FOR CLAY LOAMS AND 2% ORGANIC MATTER FOR SANDY LOAM. TO A MAXIMUM OF 25% BY VOLUME. TOPSOIL SHALL BE LOOSE AND FRAGILE, FREE OF SUBSOIL, CLAY CLUMPS, STONES, ROOTS OR ANY OTHER DELETERIOUS MATERIAL GREATER THAN 50MM DIAMETER. TOPSOIL SHALL BE FREE OF ALL LITTER AND TOXIC MATERIALS THAT MAY BE HARMFUL TO PLANT GROWTH. TOPSOIL CONTAINING SOD CLUMPS, CHABGRASS, COCKGRASS OR OTHER NOXIOUS WEEDS IS NOT ACCEPTABLE. TOPSOIL SHALL NOT BE DELIVERED OR PLACED IN A FROZEN OR EXCESSIVELY WET CONDITION. TOPSOIL ACIDITY / ALKALINITY SHALL BE IN THE RANGE OF 6.0PH TO 7.5PH.
- SERVICES, STAKEOUTS & PLANTING ADJUSTMENTS**
- CONTRACTORS SHALL OBTAIN STAKEOUTS FROM ALL UTILITIES PRIOR TO LANDSCAPE INSTALLATIONS.

no.	revision	date	by
R1	SITE PLAN APPLICATION SUBMISSION	3/9/2023	MN
R1	SITE PLAN APPLICATION SUBMISSION	3/3/2023	MN
RD	TEAM COORDINATION	1/30/2023	MN

THESE DRAWINGS ARE THE PROPERTY OF LANDSCAPE PLANNING LIMITED AND SHALL NOT BE ALTERED, MODIFIED, REVISED OR CHANGED WITHOUT THE WRITTEN CONSENT OF LANDSCAPE PLANNING LIMITED. SEAL IS NOT VALID WITHOUT SIGNATURE OF THE LANDSCAPE ARCHITECT. DRAWINGS CANNOT BE USED FOR TENDER/CONSTRUCTION UNTIL SIGNED BY LANDSCAPE ARCHITECT.



project number
2023-019



project title
BAYFIELD COMMERCIAL DEVELOPMENT

535 BAYFIELD STREET, BARRIE, ON, L4M 4Z9

city file:
municipality: BARRIE

drawing title

DETAILS AND NOTES

drawn by	reviewed by	drawing number:
MN	JS	LD-1
date	scale	
JAN.2023		

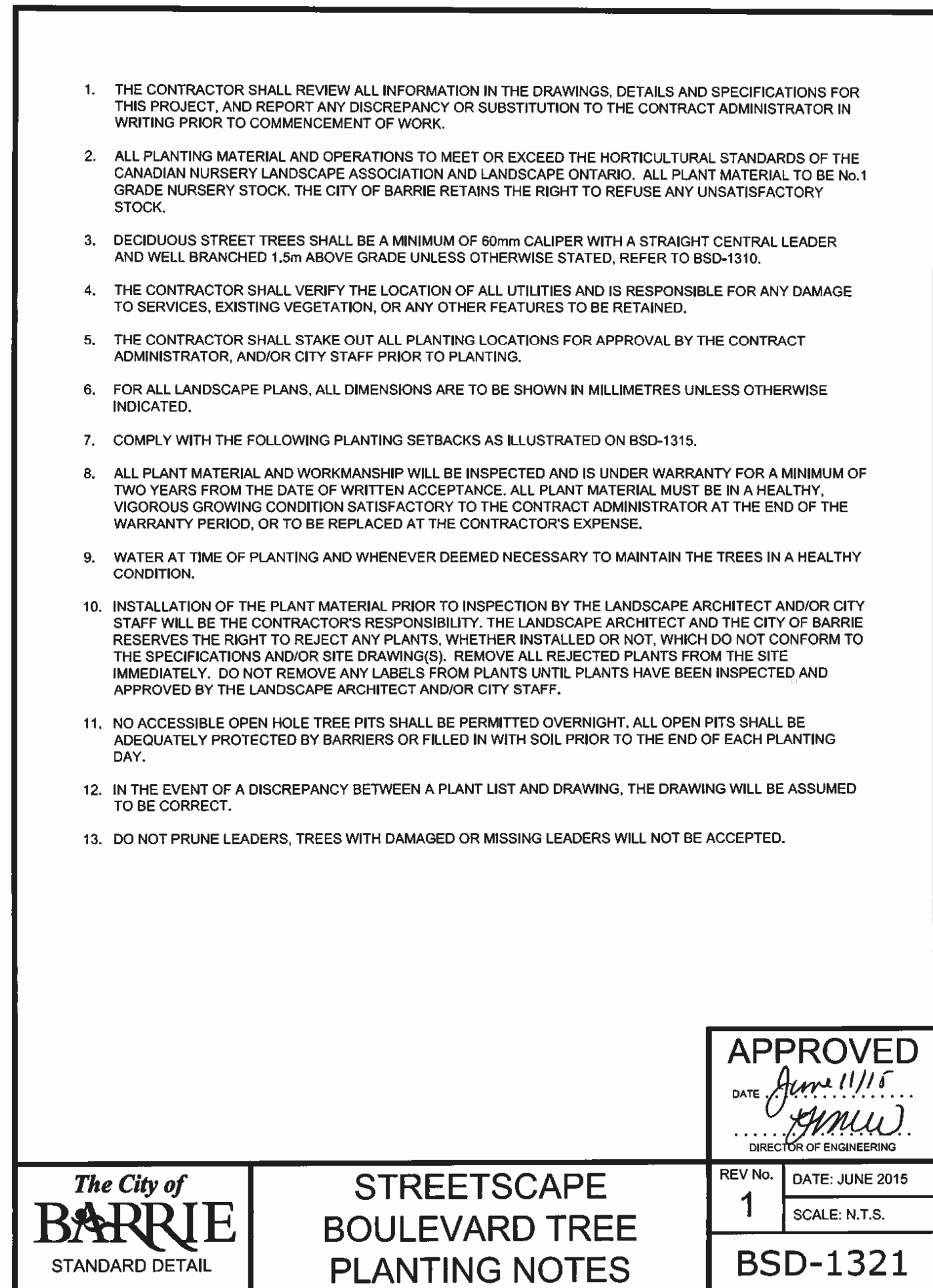
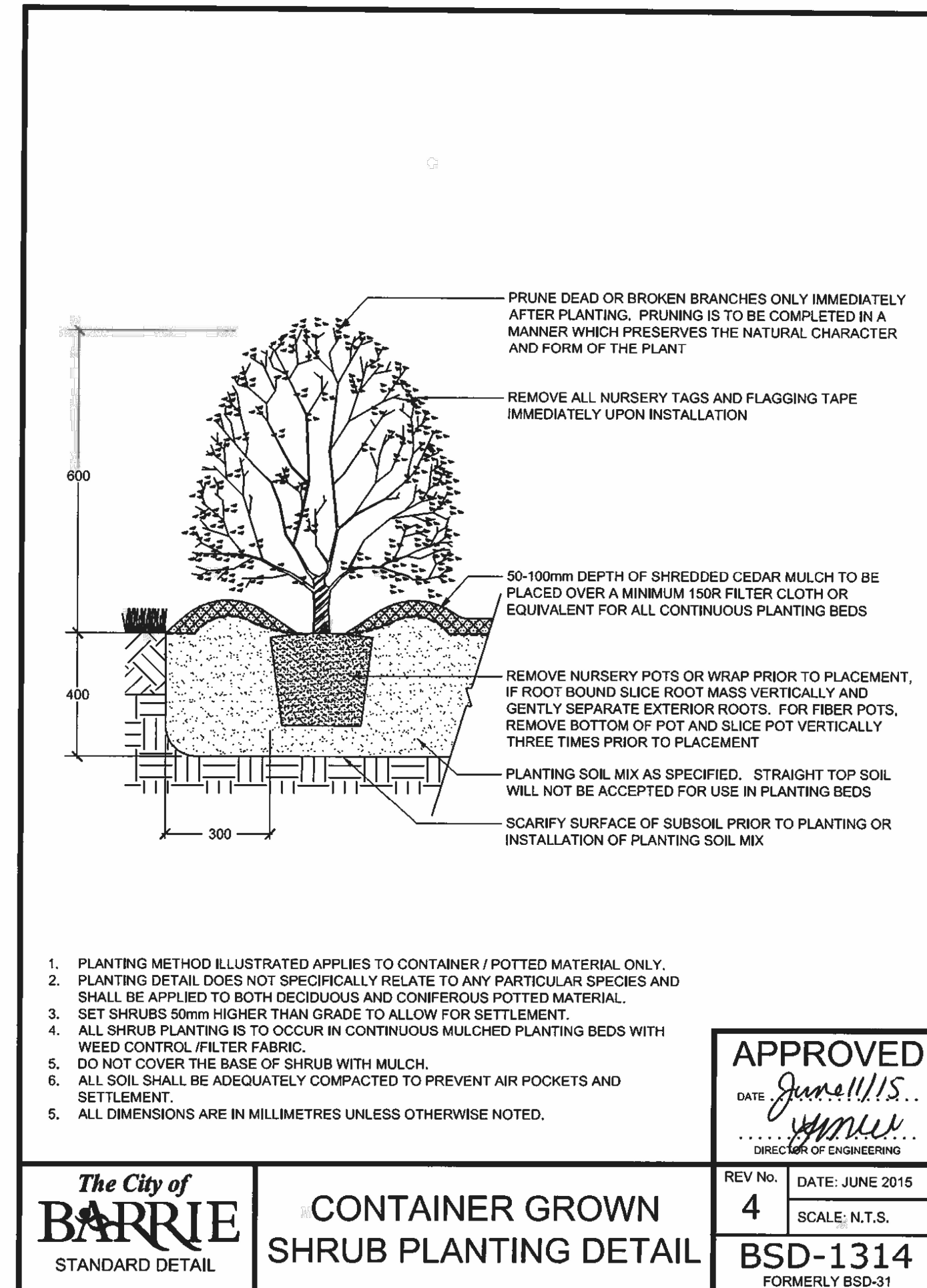
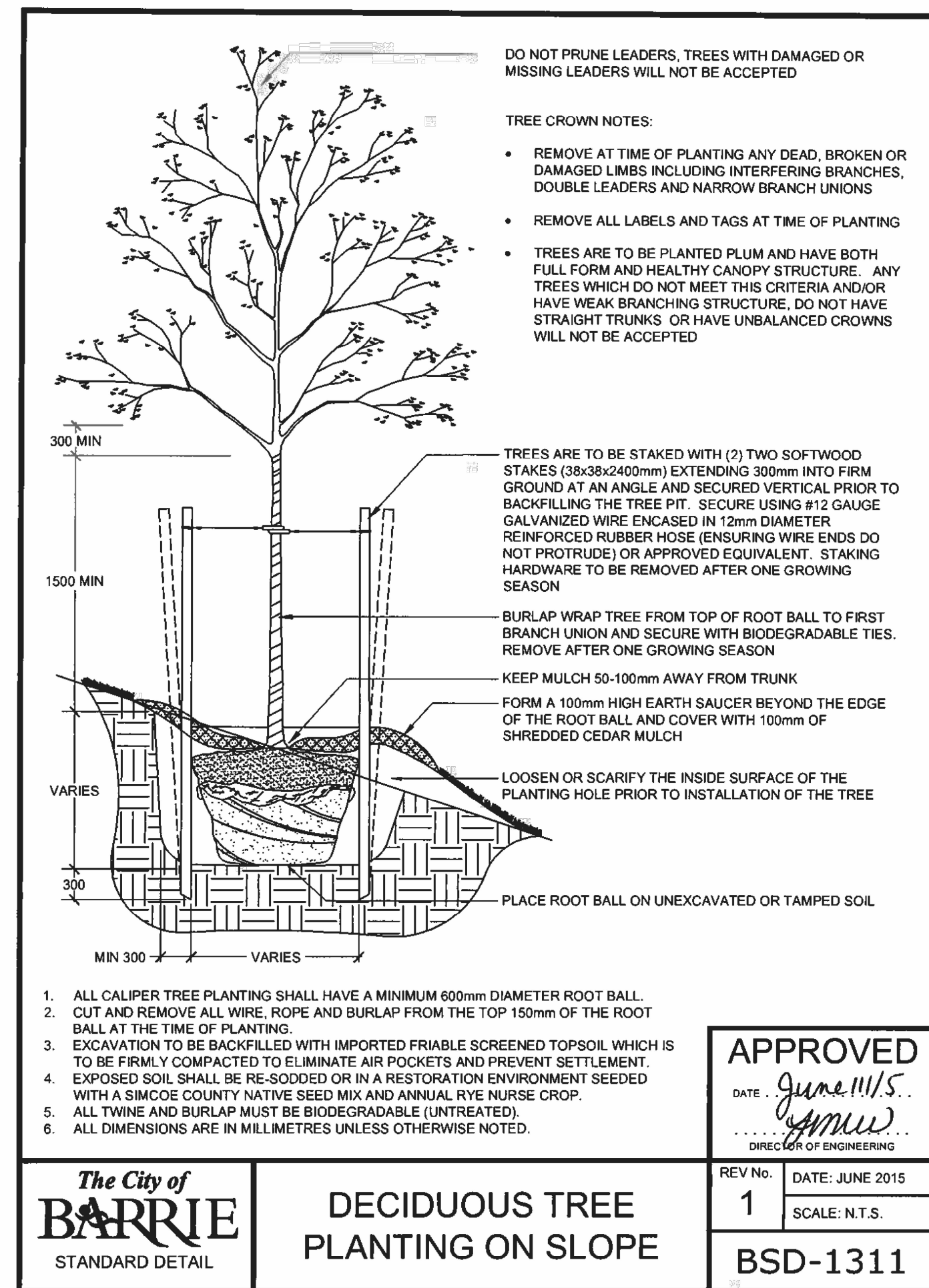
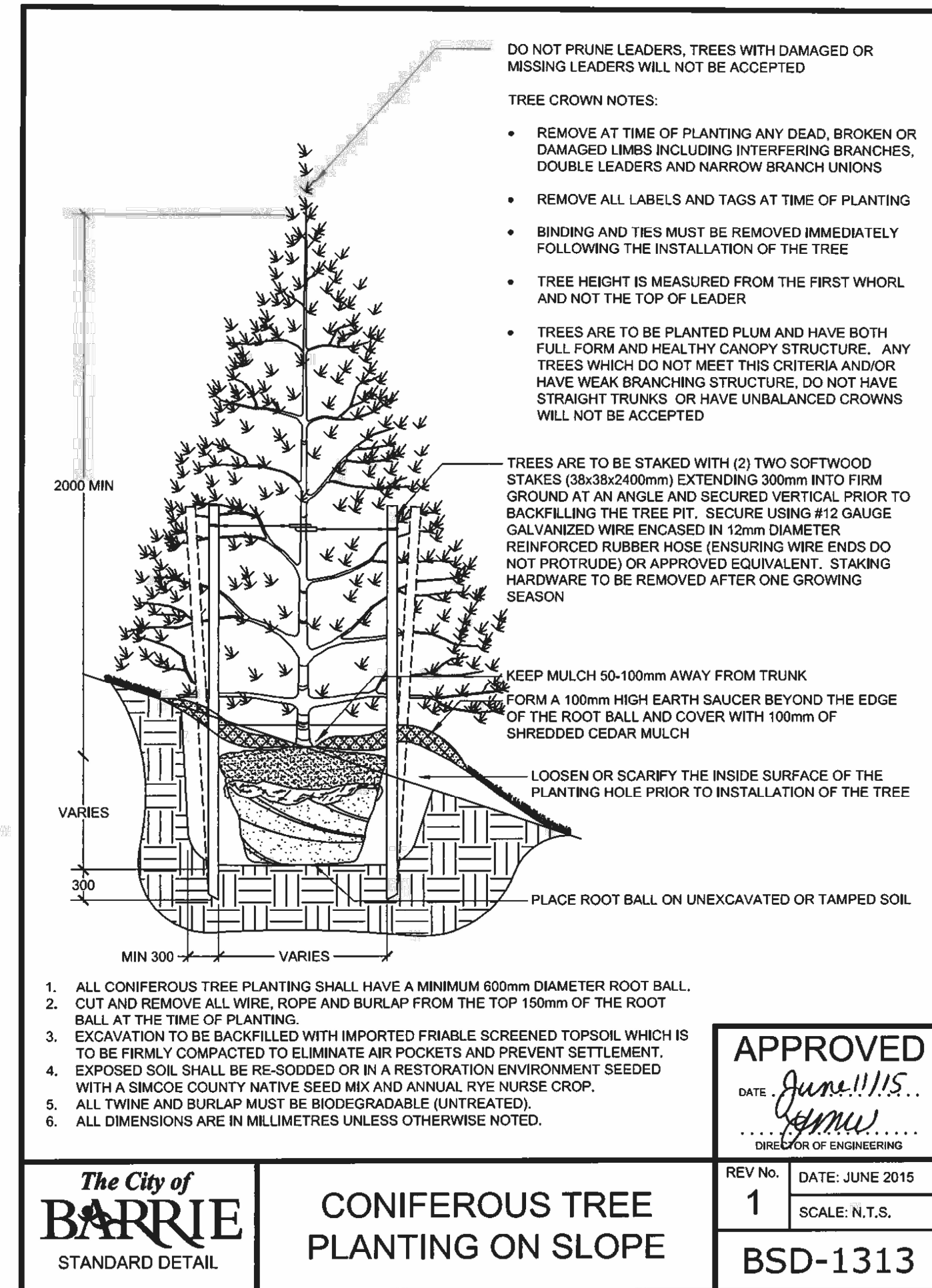
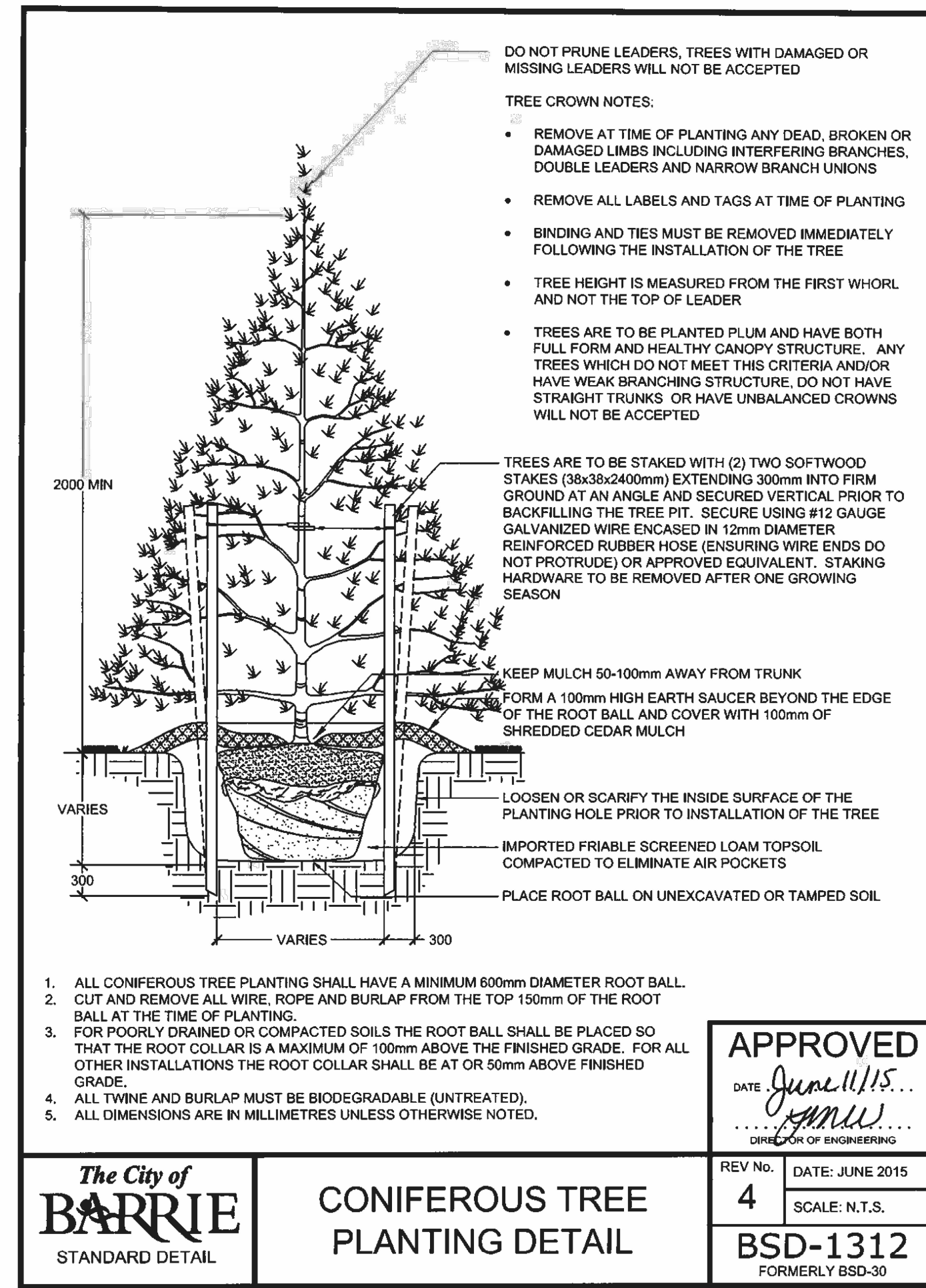
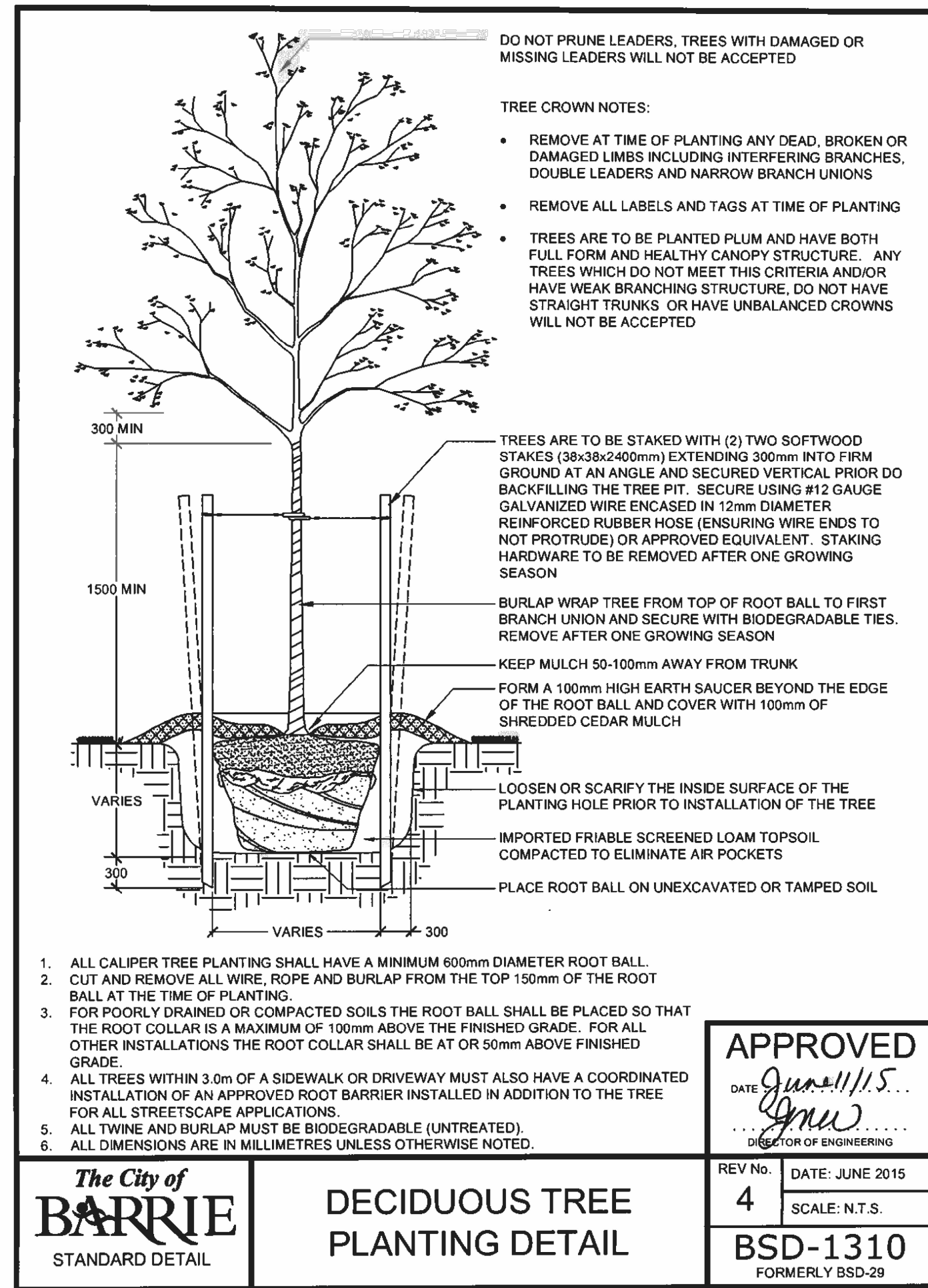

no.	revision	date	by
R1	SITE PLAN APPLICATION SUBMISSION	3/9/2023	MN
R1	SITE PLAN APPLICATION SUBMISSION	3/3/2023	MN
R0	TEAM COORDINATION	1/30/2023	MN

THESE DRAWINGS ARE THE PROPERTY OF LANDSCAPE PLANNING LIMITED AND SHALL NOT BE ALTERED, MODIFIED, REVISIONED OR CHANGED WITHOUT THE WRITTEN CONSENT OF LANDSCAPE PLANNING LIMITED. SEAL IS NOT VALID WITHOUT SIGNATURE OF THE LANDSCAPE ARCHITECT. DRAWINGS CANNOT BE USED FOR TENDER/CONSTRUCTION UNTIL SIGNED BY LANDSCAPE ARCHITECT.



project number
2023-019

landscape planning
LANDSCAPE ARCHITECTS
Suite 207, 95 Mural Street, Richmond Hill, Ontario L4B 3G2,
Tel. 905.669.6838, www.landscapeplan.ca

project title
BAYFIELD COMMERCIAL DEVELOPMENT

535 BAYFIELD STREET, BARRIE, ON, L4M 4Z9

city file:
municipality: BARRIE

drawing title

DETAILS

drawn by MN	reviewed by JS	drawing number: LD-2
date JAN.2023	scale	