

# 220 BRADFORD STREET, BARRIE, ON

MUNICIPAL FILE:

LANDMARK ENVIRONMENTAL GROUP LTD.

PROJECT NO. LA 439-19

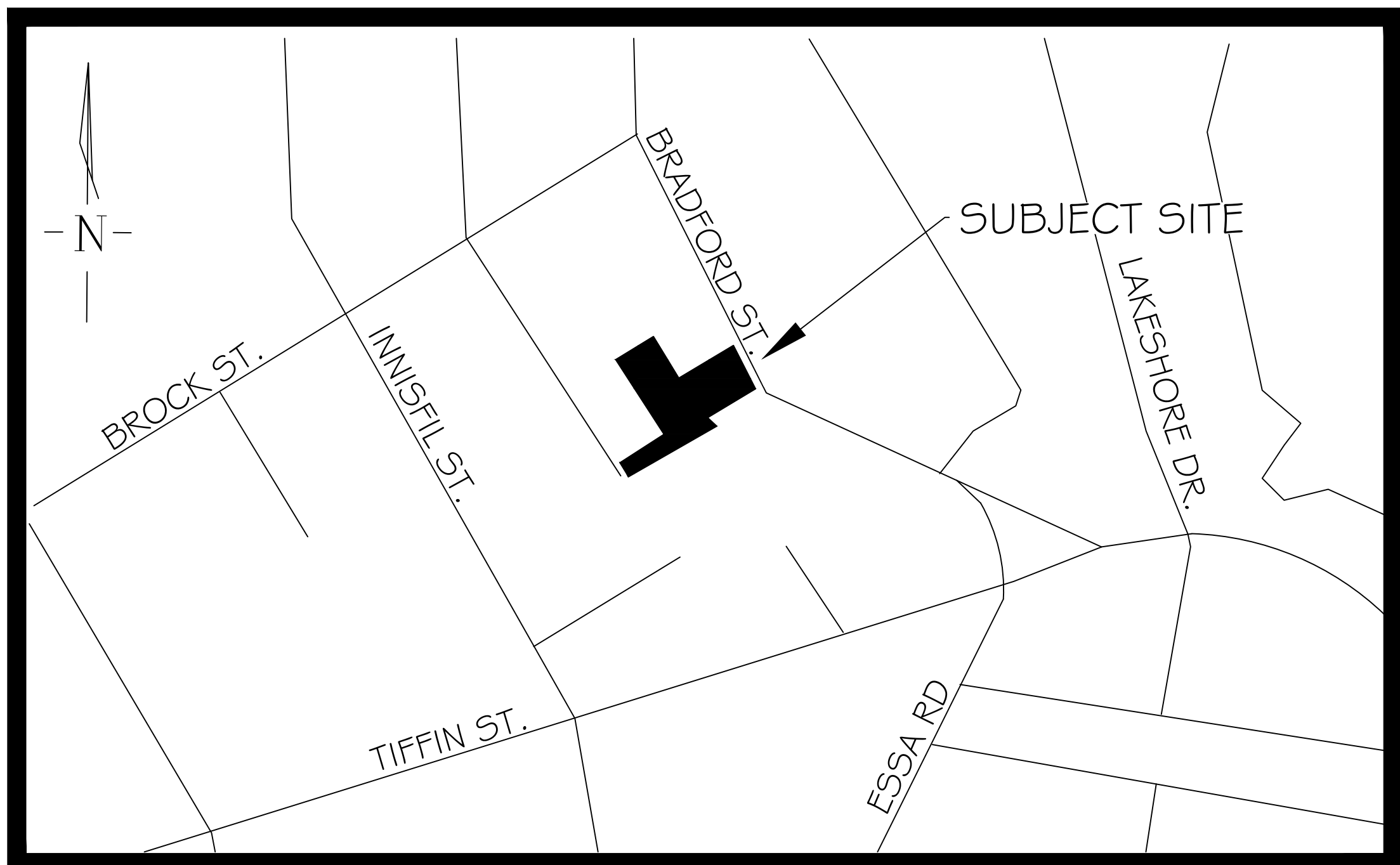

KEY PLAN N.T.S.

## DRAWING LIST:

ARB-1	ARBORIST PLAN
ARB-2	ARBORIST PLAN
ARB-3	ARBORIST PLAN
LP-1	OVERALL LANDSCAPE PLAN
LP-2	LANDSCAPE ENLARGEMENT
LP-3	LANDSCAPE ENLARGEMENT
LP-4	FIFTH FLOOR ROOFTOP PATIO
D-1	DETAILS
D-2	DETAILS
D-3	DETAILS
D-4	DETAILS

CLIENT:

MR. AHAD REHMAN  
C/O CHAYELL HOSPITALITY GROUP  
7815 KENT BLVD  
BROCKVILLE, ON K6V 6N7

MUNICIPALITY:



CITY OF BARRIE  
70 COLLIER STREET, P.O. BOX 400,  
BARRIE, ON  
L4M 4T5

LANDSCAPE ARCHITECT:





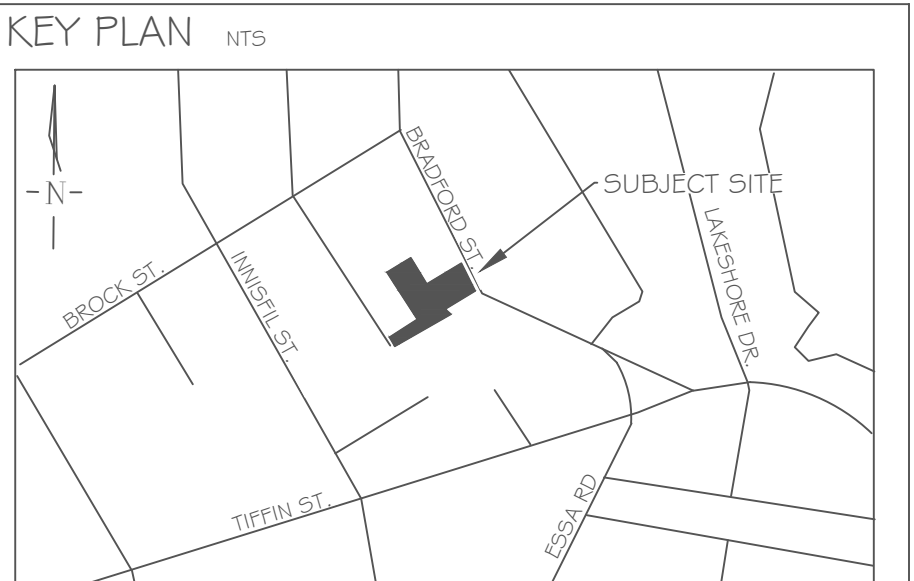
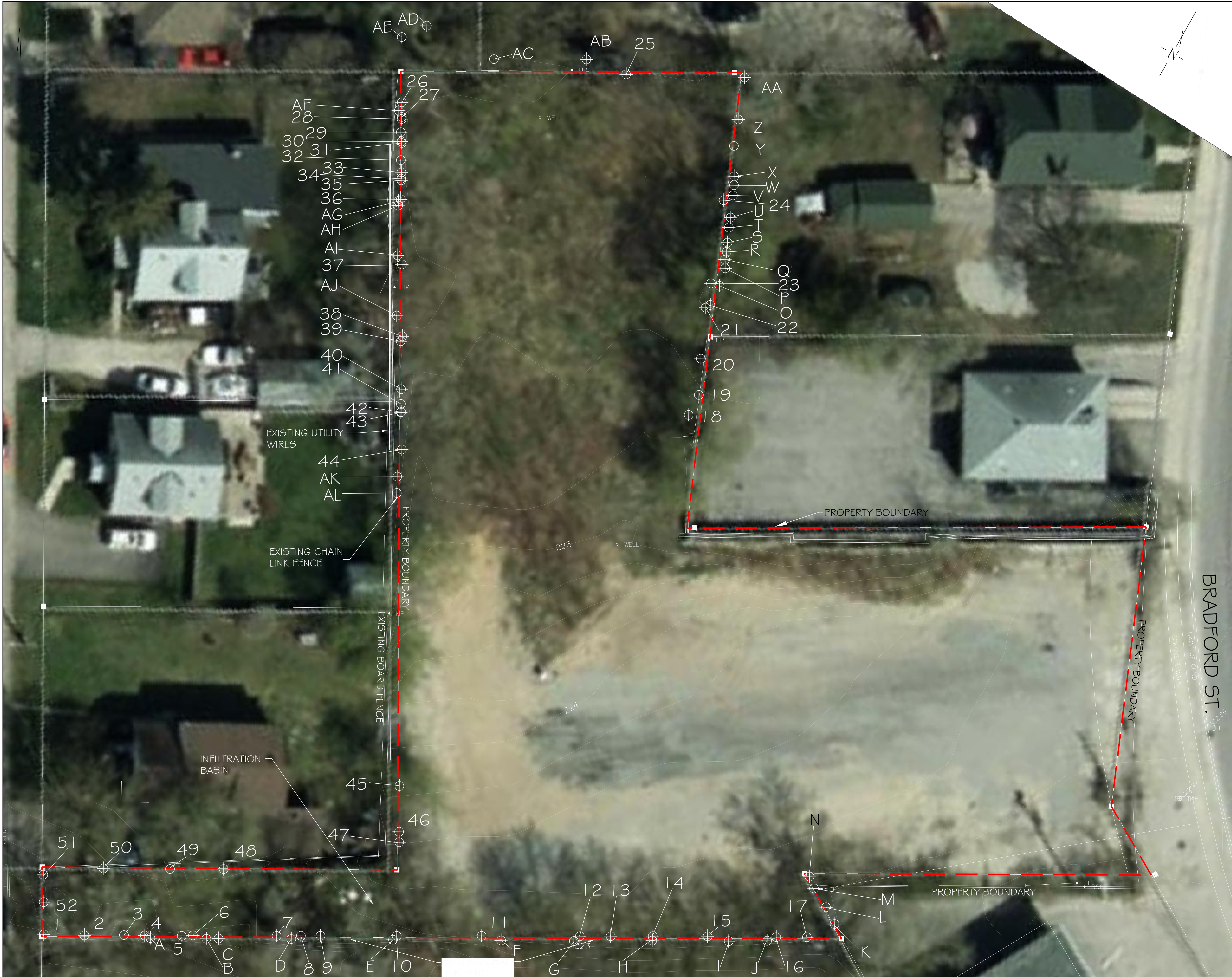

**GENERAL NOTES**

The Client and its contractors are responsible for all utility locates and confirming all setbacks, elevations, grades, etc. prior to installation of the constructed works.

The Contractor is to report any discrepancies in writing to the Landscape Architect prior to proceeding with the works to determine the impact and suitability of the proposed works. The Landscape Architect will not be responsible for any unapproved adjustments on site.

Construction of the works must conform to Authority requirements and applicable codes where they have jurisdiction.

All specifications and drawings are instruments of service and are the property and ownership of the Landmark Environmental Group Ltd. As such, the drawings shall not be modified or reproduced without the expressed written consent of Landmark Environmental Group Ltd. or they will be considered void. The said drawings are for Site Plan approval only and may require additional detailing prior to tender and construction.

The Landmark Environmental Group Ltd. is not liable for errors or omissions from the use of these drawings prior to approval, seal, signature and date, and will be considered void.

It is advised that the Contractor contact the Landscape Architect prior to commencement of the construction works to ensure that the Contractor has the latest approved drawings.

The Landmark Environmental Group Ltd. is not responsible for the accuracy of the base drawing information (eg Survey, Architectural, Engineering, etcO. If there are any discrepancies, the Contractor will refer to the appropriate base drawing information and report discrepancies on the Landscape Drawings to the Landscape Architect.

© Drawing set is protected under copyright.

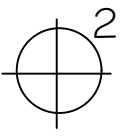
LEGEND			
 Tree Location			

			REVISIONS	
NO	DATE	BY		
STAMP			APPROVAL	
				
BASE PLAN PROVIDED BY SIMCOE COUNTY GIS AND J.D.BARNES LTD SURVEY # 19-11-783-00 DATED NOV 4, 2019				
			LANDSCAPE ARCHITECTS & CONSULTING ARBORISTS	
			OFFICE: 705-796-1122 info@LEGGroupLtd.com www.LEGroupLtd.com	
CLIENT:				
CHAYELL HOSPITALITY GROUP 7815 KENT BLVD, BROCKVILLE				
PROJECT:				
220 BRADFORD STREET BARRIE				
DRAWING:				
ARBORIST PLAN				
SCALE BAR:  Scale = 1:150				
PROJECT NO.: LA 439-19			SCALE: 1:150	
MUNICIPAL FILE NO.:			DATE: JANUARY 16, 2020	
DRAWN BY: K.S./J.G		CHECKED BY: J.H		DRAWING No.: ARB-1





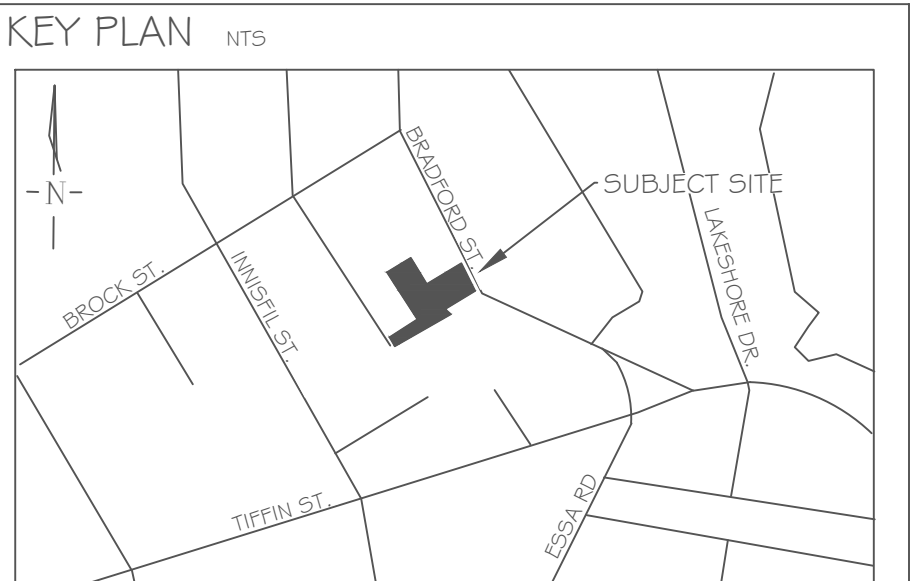

NOTES:  
1) TREE PRESERVATION DETAILS ARE ON SHEET D-1.  
2) TREE PRESERVATION NOTES ARE ON SHEET D-1.  
3) PRUNING OF THE EXISTING TREE CANOPY MAY BE REQUIRED TO PREVENT DAMAGE TO THE BUILDING FACE.



**GENERAL NOTES**  
The Client and its contractors are responsible for all utility locates and confirming all setbacks, elevations, grades, etc. prior to installation of the constructed works.  
The Contractor is to report any discrepancies in writing to the Landscape Architect prior to proceeding with the works to determine the impact and suitability of the proposed works. The Landscape Architect will not be responsible for any unapproved adjustments on site.  
Construction of the works must conform to Authority requirements and applicable codes where they have jurisdiction.  
All specifications and drawings are instruments of service and are the property and ownership of the Landmark Environmental Group Ltd. As such, the drawings shall not be modified or reproduced without the expressed written consent of Landmark Environmental Group Ltd. or they will be considered void. The said drawings are for Site Plan approval only and may require additional detailing prior to tender and construction.  
The Landmark Environmental Group Ltd. is not liable for errors or omissions from the use of these drawings prior to approval, seal, signature and date, and will be considered void.  
It is advised that the Contractor contact the Landscape Architect prior to commencement of the construction works to ensure that the Contractor has the latest approved drawings.  
The Landmark Environmental Group Ltd. is not responsible for the accuracy of the base drawing information (eg Survey, Architectural, Engineering, etcO. If there are any discrepancies, the Contractor will refer to the appropriate base drawing information and report discrepancies on the Landscape Drawings to the Landscape Architect.  
© Drawing set is protected under copyright.

- LEGEND**
-  Tree Location (with Canopy)
  -  Tree Preservation Fence
  -  Tree to be Removed

NO.	DATE	BY	REVISIONS
1			
2			
3			
4			
5			
6			
7			
8			
9			
10			
11			
12			
13			
14			
15			
16			
17			
18			
19			
20			
21			
22			
23			
24			
25			
26			
27			
28			
29			
30			
31			
32			
33			
34			
35			
36			
37			
38			
39			
40			
41			
42			
43			
44			
45			
46			
47			
48			
49			
50			
51			
52			
53			
54			
55			
56			
57			
58			
59			
60			
61			
62			
63			
64			
65			
66			
67			
68			
69			
70			
71			
72			
73			
74			
75			
76			
77			
78			
79			
80			
81			
82			
83			
84			
85			
86			
87			
88			
89			
90			
91			
92			
93			
94			
95			
96			
97			
98			
99			
100			

STAMP	APPROVAL
	
BASE PLAN PROVIDED BY SIMCOE COUNTY GIS AND SKELTON BRUMWELL AND ASSOC. #3266-R NOV 2019	
<b>LANDMARK ENVIRONMENTAL GROUP LTD.</b> LANDSCAPE ARCHITECTS & CONSULTING ARBORISTS OFFICE: 705-796-1122 info@LEGGroupLtd.com www.LEGroupLtd.com	
CLIENT: CHAYELL HOSPITALITY GROUP 7815 KENT BLVD, BROCKVILLE	
PROJECT: 220 BRADFORD STREET BARRIE	
DRAWING: ARBORIST PLAN	
SCALE BAR: 3m 0 3 6 9 Scale = 1:150	
PROJECT NO.: LA 439-19	SCALE: 1:150
MUNICIPAL FILE NO.:	DATE: JANUARY 16, 2020
DRAWN BY: K.S/J.G	CHECKED BY: J.H
DRAWING No.: ARB-2	



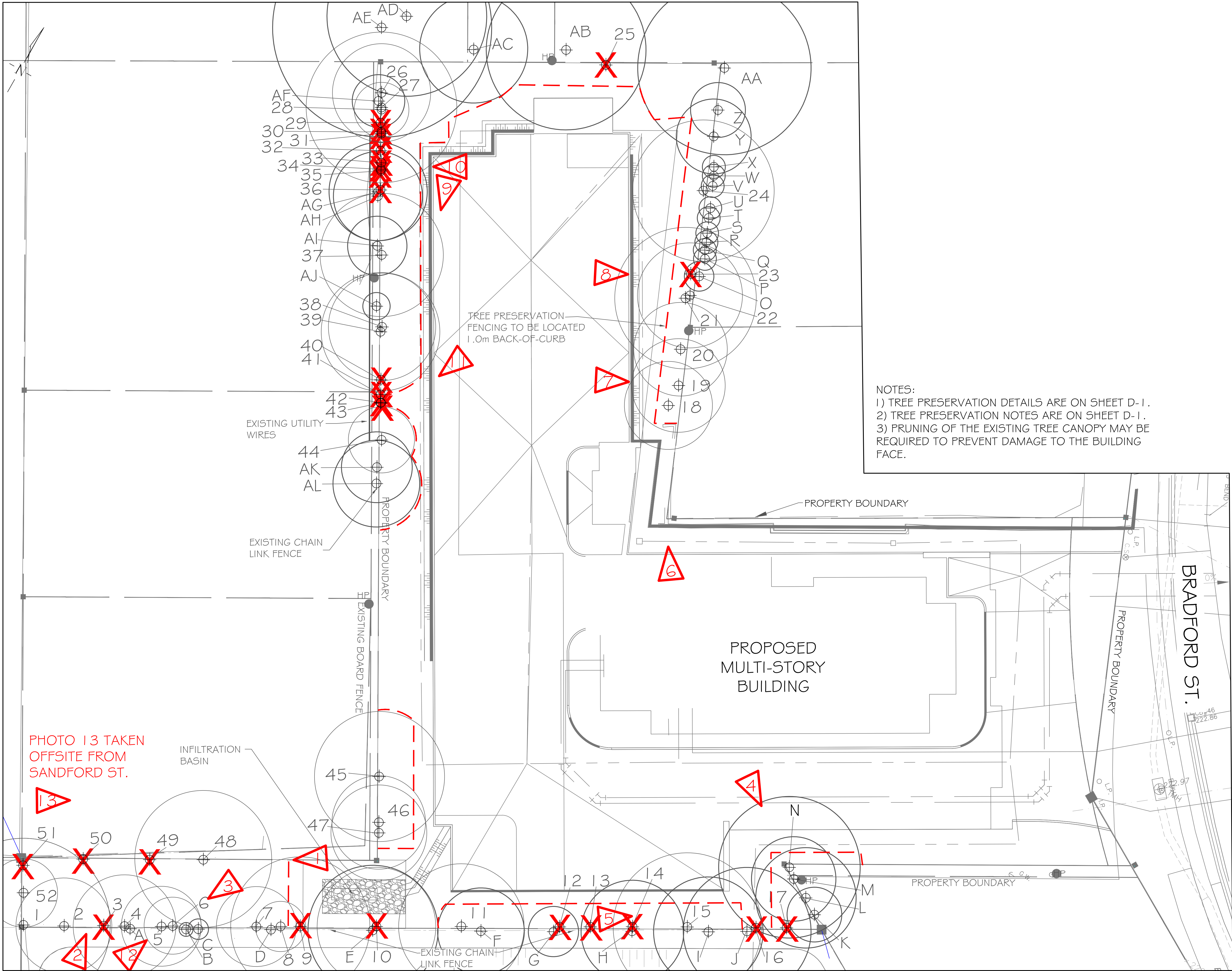

NOTES:  
1) TREE PRESERVATION DETAILS ARE ON SHEET D-1.  
2) TREE PRESERVATION NOTES ARE ON SHEET D-1.  
3) PRUNING OF THE EXISTING TREE CANOPY MAY BE REQUIRED TO PREVENT DAMAGE TO THE BUILDING FACE.

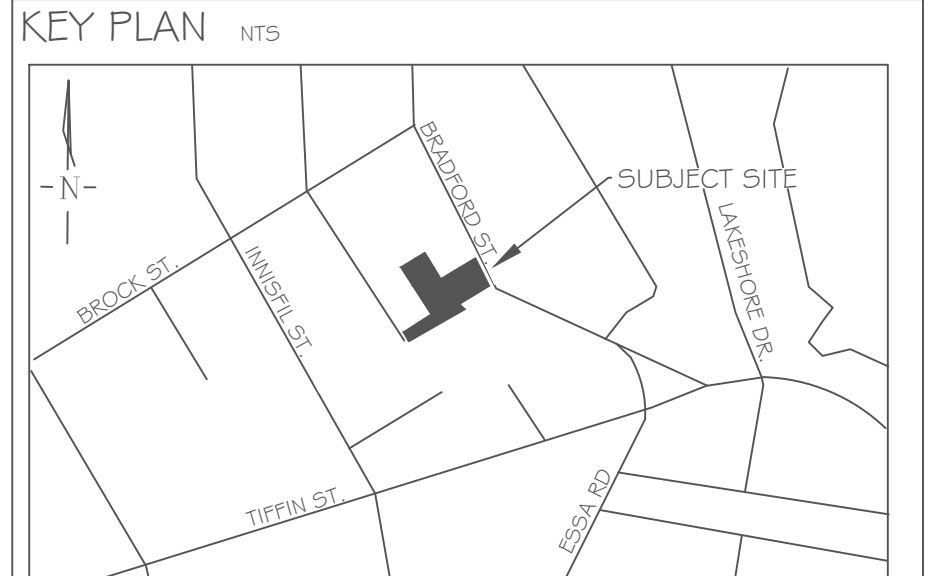

**GENERAL NOTES**

The Client and its contractors are responsible for all utility locates and confirming all setbacks, elevations, grades, etc. prior to installation of the constructed works.

The Contractor is to report any discrepancies in writing to the Landscape Architect prior to proceeding with the works to determine the impact and suitability of the proposed works. The Landscape Architect will not be responsible for any unapproved adjustments on site.

Construction of the works must conform to Authority requirements and applicable codes where they have jurisdiction.





All specifications and drawings are instruments of service and are the property and ownership of the Landmark Environmental Group Ltd. As such, the drawings shall not be modified or reproduced without the expressed written consent of Landmark Environmental Group Ltd. or they will be considered void. The said drawings are for Site Plan approval only and may require additional detailing prior to tender and construction.

The Landmark Environmental Group Ltd. is not liable for errors or omissions from the use of these drawings prior to approval, seal, signature and date, and will be considered void.

It is advised that the Contractor contact the Landscape Architect prior to commencement of the construction works to ensure that the Contractor has the latest approved drawings.

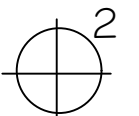
The Landmark Environmental Group Ltd. is not responsible for the accuracy of the base drawing information (eg Survey, Architectural, Engineering, etcO. If there are any discrepancies, the Contractor will refer to the appropriate base drawing information and report discrepancies on the Landscape Drawings to the Landscape Architect.

© Drawing set is protected under copyright.

- LEGEND**
-  Tree Location
  -  Tree Preservation Fence
  -  Tree to be Removed
  -  Photo number and direction to correlate with Appendix D of Arbor Report

NO.	DATE	BY	REVISIONS
STAMP			
			
APPROVAL			
BASE PLAN PROVIDED BY SKELTON BRUMWELL AND ASSOC. #32GG-R NOV 2019			
<b>LANDMARK ENVIRONMENTAL GROUP LTD.</b> LANDSCAPE ARCHITECTS & CONSULTING ARBORISTS OFFICE: 705-796-1122 info@LEGGroupLtd.com www.LEGroupLtd.com			
CLIENT: CHAYELL HOSPITALITY GROUP 7815 KENT BLVD, BROCKVILLE			
PROJECT: 220 BRADFORD STREET BARRIE			
DRAWING: ARBORIST PLAN			
SCALE BAR: 3m 0 3 6 9 Scale = 1:150			
PROJECT NO.: LA 439-19		SCALE: 1:150	
MUNICIPAL FILE NO.:		DATE: JANUARY 16, 2020	
DRAWN BY: K.S./J.G		CHECKED BY: J.H	
DRAWING No.: ARB-3			



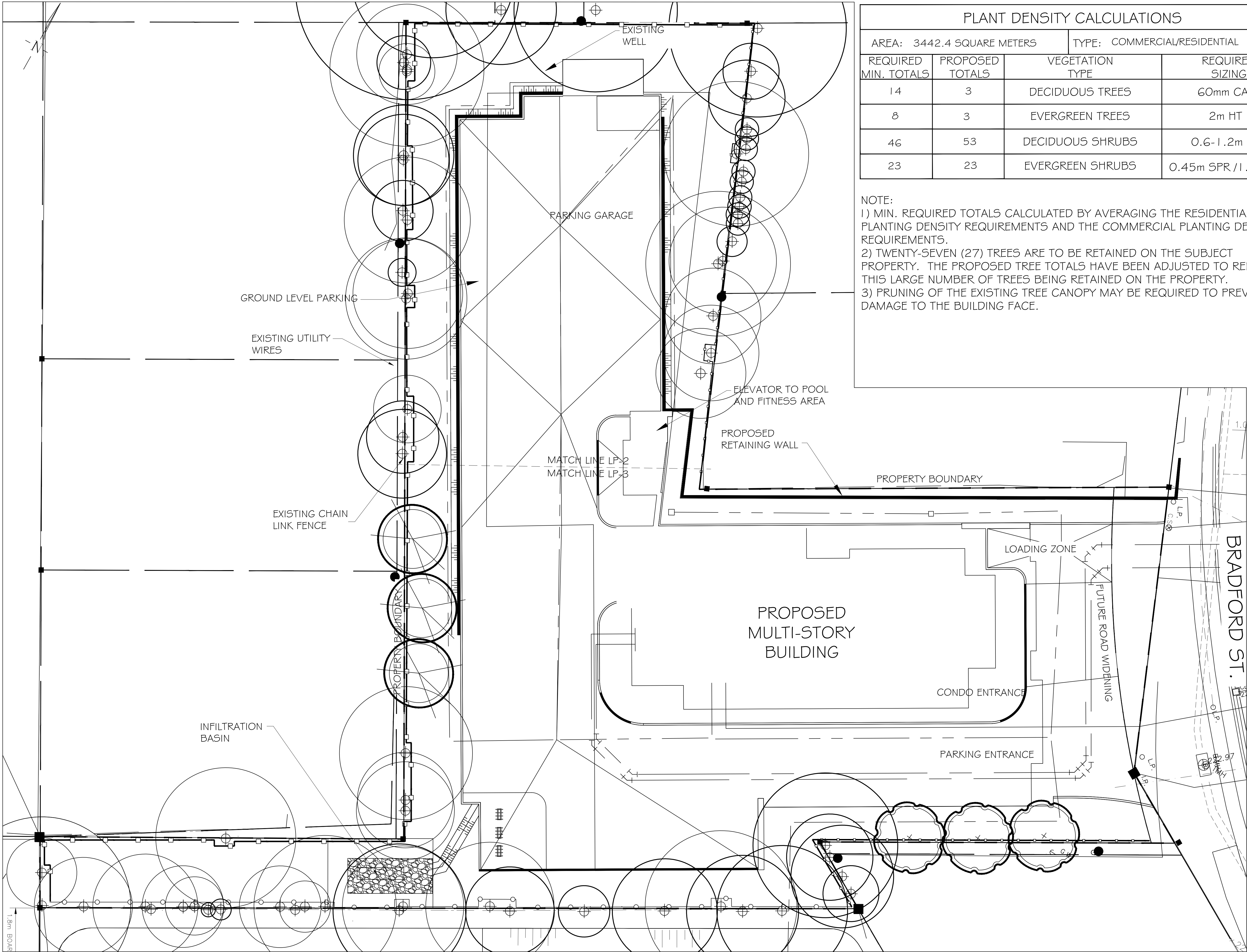

PLANT DENSITY CALCULATIONS			
AREA: 3442.4 SQUARE METERS		TYPE: COMMERCIAL/RESIDENTIAL	
REQUIRED MIN. TOTALS	PROPOSED TOTALS	VEGETATION TYPE	REQUIRED SIZING
14	3	DECIDUOUS TREES	60mm CAL
8	3	EVERGREEN TREES	2m HT
46	53	DECIDUOUS SHRUBS	0.6-1.2m HT
23	23	EVERGREEN SHRUBS	0.45m SPR / 1.2m HT

NOTE:  
1) MIN. REQUIRED TOTALS CALCULATED BY AVERAGING THE RESIDENTIAL PLANTING DENSITY REQUIREMENTS AND THE COMMERCIAL PLANTING DENSITY REQUIREMENTS.  
2) TWENTY-SEVEN (27) TREES ARE TO BE RETAINED ON THE SUBJECT PROPERTY. THE PROPOSED TREE TOTALS HAVE BEEN ADJUSTED TO REFLECT THIS LARGE NUMBER OF TREES BEING RETAINED ON THE PROPERTY.  
3) PRUNING OF THE EXISTING TREE CANOPY MAY BE REQUIRED TO PREVENT DAMAGE TO THE BUILDING FACE.

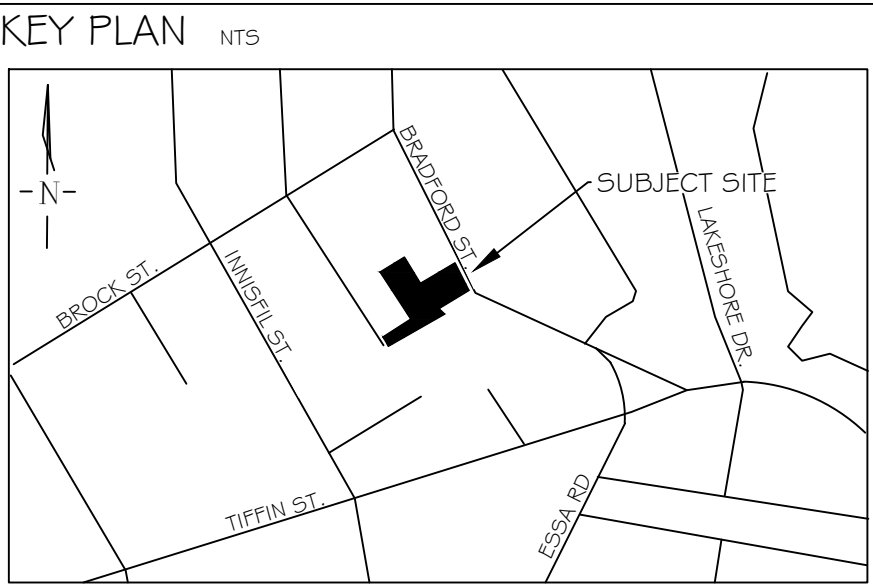

**GENERAL NOTES**  
The Client and its contractors are responsible for all utility locates and confirming all setbacks, elevations, grades, etc. prior to installation of the constructed works.  
The Contractor is to report any discrepancies in writing to the Landscape Architect prior to proceeding with the works to determine the impact and suitability of the proposed works. The Landscape Architect will not be responsible for any unapproved adjustments on site.  
Construction of the works must conform to Authority requirements and applicable codes where they have jurisdiction.  
All specifications and drawings are instruments of service and are the property and ownership of the Landmark Environmental Group Ltd. As such, the drawings shall not be modified or reproduced without the expressed written consent of Landmark Environmental Group Ltd. or they will be considered void. The said drawings are for Site Plan approval only and may require additional detailing prior to tender and construction.  
The Landmark Environmental Group Ltd. is not liable for errors or omissions from the use of these drawings prior to approval, seal, signature and date, and will be considered void.  
It is advised that the Contractor contact the Landscape Architect prior to commencement of the construction works to ensure that the Contractor has the latest approved drawings.  
The Landmark Environmental Group Ltd. is not responsible for the accuracy of the base drawing information (eg Survey, Architectural, Engineering, etc.). If there are any discrepancies, the Contractor will refer to the appropriate base drawing information and report discrepancies on the Landscape Drawings to the Landscape Architect.  
© Drawing set is protected under copyright.

- LEGEND**
- Existing Tree (with canopy) to Remain
  - Proposed Deciduous Tree
  - Proposed Coniferous Tree
  - Proposed Deciduous Shrubs/Perennials
  - Proposed Coniferous Shrubs
  - Plant Key
  - Proposed Fence

NO.	DATE	BY	REVISIONS
STAMP			
		APPROVAL	
BASE PLAN PROVIDED BY SKELTON BRUMWELL AND ASSOC. #3266 FEB 3, 2020			
		LANDSCAPE ARCHITECTS & CONSULTING ARBORISTS OFFICE: 705-796-1122 info@LEGgroupLtd.com www.LEGgroupLtd.com	

CLIENT: CHAYELL HOSPITALITY GROUP  
7815 KENT BLVD, BROCKVILLE

PROJECT: 220 BRADFORD STREET  
BARRIE

DRAWING: OVERALL LANDSCAPE PLAN

SCALE BAR: 3m 0 3 6 9  
Scale = 1:150

PROJECT NO.: LA 439-19	SCALE: 1:150
MUNICIPAL FILE NO.:	DATE: JANUARY 16, 2020
DRAWN BY: K.S/J.G	CHECKED BY: J.H
DRAWING No.: LP-1	



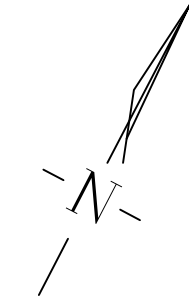

KEY	QTY	BOTANICAL NAME	COMMON NAME	SIZE/CONDITION
SHRUBS				
Ac	5	<i>Amelanchier canadensis</i>	Serviceberry	2 gal pot/60cm ht
Cr	6	<i>Cornus racemosa</i>	Grey Dogwood	2 gal pot/60cm ht
Jh	7	<i>Juniperus horizontalis</i> 'Limeglow'	Limeglow Creeping Juniper	2 gal pot/60cm spr
VI	6	<i>Viburnum lentago</i>	Nannyberry	2 gal pot/60cm ht

DRAWN BY: K.S/J.G	CHECKED BY: J.H	DRAWING No.: LP-2
----------------------	--------------------	----------------------



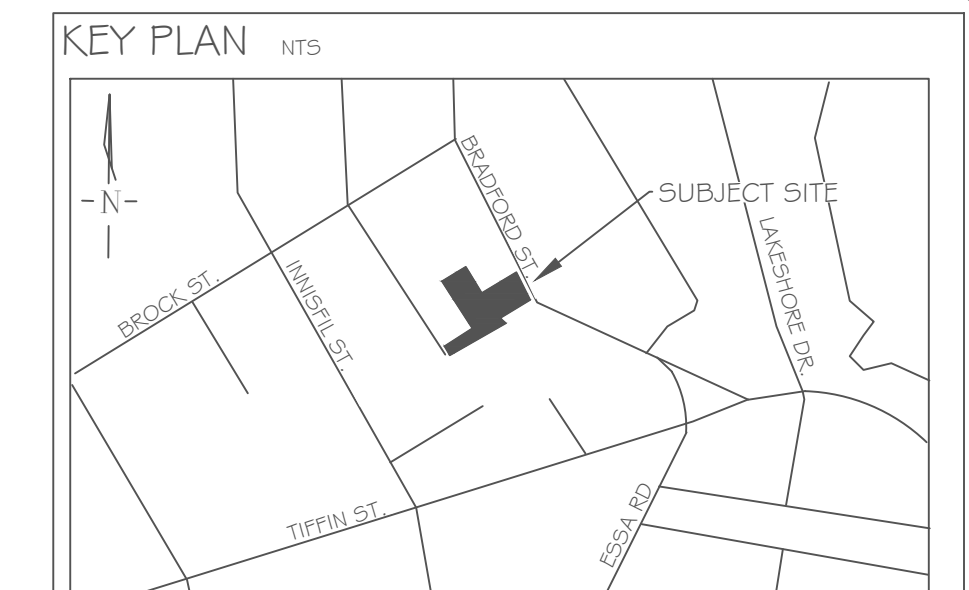

The Client and its contractors are responsible for all utility locates and confirming all setbacks, elevations, grades, etc. prior to installation of the constructed works.

The Contractor is to report any discrepancies in writing to the Landscape Architect prior to proceeding with the works to determine the impact and suitability of the proposed works. The Landscape Architect will not be responsible for any unapproved adjustments on site.

Construction of the works must conform to Authority requirements and applicable codes where they have jurisdiction.

All specifications and drawings are instruments of service and are the property and ownership of the Landmark Environmental Group Ltd. As such, the drawings shall not be modified or reproduced without the expressed written consent of Landmark Environmental Group Ltd. or they will be considered void. The said drawings are for Site Plan approval only and may require additional detailing prior to tender and construction.

The Landmark Environmental Group Ltd. is not liable for errors or omissions from the use of these drawings prior to approval, seal, signature and date, and will be considered void.

It is advised that the Contractor contact the Landscape Architect prior to commencement of the construction works to ensure that the Contractor has the latest approved drawings.

The Landmark Environmental Group Ltd. is not responsible for the accuracy of the base drawing information (eg Survey, Architectural, Engineering, etcO. If there are any discrepancies, the Contractor will refer to the appropriate base drawing information and report discrepancies on the Landscape Drawings to the Landscape Architect.

Existing Tree (with canopy) to Remain

Proposed Deciduous Tree

Proposed Coniferous Tree

Proposed Deciduous Shrubs/Perennials

Proposed Coniferous Shrubs

Plant Key

 Proposed OSC Native Seed Mix  
#6850

Proposed Fence

NO	DATE	BY	REVISIONS

STAMP	APPROVAL
-------	----------

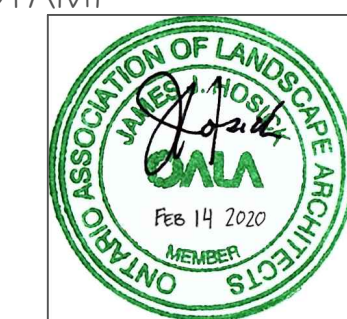

BASIC PLAN PROVIDED BY SKELTON BRUMWELL AND ASSOC. #3266  
FEB 3, 2020



LANDSCAPE ARCHITECTS  
& CONSULTING ARBORISTS

OFFICE: 705-796-1122

info@LEGroupLtd.com  
www.LEGroupLtd.com

CLIENT: CHAYELL HOSPITALITY GROUP  
7815 KENT BLVD, BROCKVILLE

PROJECT: 220 BRADFORD STREET  
BARRIE

DRAWING:  
LANDSCAPE PLAN ENLARGEMENT

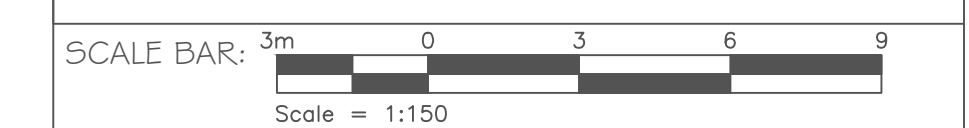

PROJECT NO.: LA 439-19	SCALE: 1:150
---------------------------	-----------------

MUNICIPAL FILE NO.:	DATE: JANUARY 16, 2020
---------------------	---------------------------

DRAWN BY: K.S/J.G	CHECKED BY: J.H	DRAWING No.: LP-3
----------------------	--------------------	----------------------

KEY	QTY	BOTANICAL NAME	COMMON NAME	SIZE/CONDITION
TREES				
Ab	3	<i>Abies balsamea</i>	Balsam Fir	2m ht/WB
Ta	3	<i>Tilia americana</i>	Basswood	60mm cal/WB
SHRUBS				
Ac	8	<i>Amelanchier canadensis</i>	Serviceberry	2 gal pot/60cm ht
Ca	7	<i>Ceanothus americanus</i>	New Jersey Tea	2 gal pot/60cm ht
Cr	4	<i>Cornus racemosa</i>	Grey Dogwood	2 gal pot/60cm ht
DI	13	<i>Diervilla lonicera</i>	Bush Honeysuckle	2 gal pot/60cm ht
Sa	6	<i>Salix cordata</i>	Heart-leaved Willow	2 gal pot/60cm ht
Sc	8	<i>Sambucus canadensis</i>	Elderberry	2 gal pot/60cm ht
Tc	16	<i>Taxus canadensis</i>	Canadian Yew	2 gal pot/60cm spr
PERENNIALS				
Af	28	<i>Athyrium filix-femina</i>	Lady Fern	1 gal pot/30cm ht
Hd	16	<i>Helianthus divaricatus</i>	Woodland Sunflower	1 gal pot/30cm ht

- 1) PLANT LIST, PLANTING NOTES AND PLANTING DETAILS ARE FOUND ON SHEET D-2.
- 2) PLANTING DENSITY TABLE IS LOCATED ON SHEET LP-1.
- 3) ALL FENCING AND FOOTINGS ARE TO BE PLACED SOLELY ON THE SITE PROPERTY LANDS.

\* APPLY BY HYDROSEED METHOD.  
SOW RATE 500g/180m<sup>2</sup> OR 25kgs/ha.

CANADA WILD RYE  
BLACK EYED SUSAN  
LITTLE BLUESTEM  
INDIANGRASS  
NEW ENGLAND ASTER  
WILD BERGAMOT  
CANADA GOLDENROD  
COMMON MILKWEED  
SAND DROPSIED  
SMOOTH BLUE ASTER

ELYMUS CANADENSIS  
 RUDBECKIA HIRTA  
 SCHIZACHYRIUM SCOPARIUM  
 SORGHASTRUM NUTANS  
 ASTER NOVAE-ANGLIAE  
 MONARDA FISTULOSA  
 SOLIDAGO CANADENSIS  
 ASCLEPIAS SYRIACA  
 SPOROBOLUS CRYPTANDRUS  
 ASTER LAEVIS







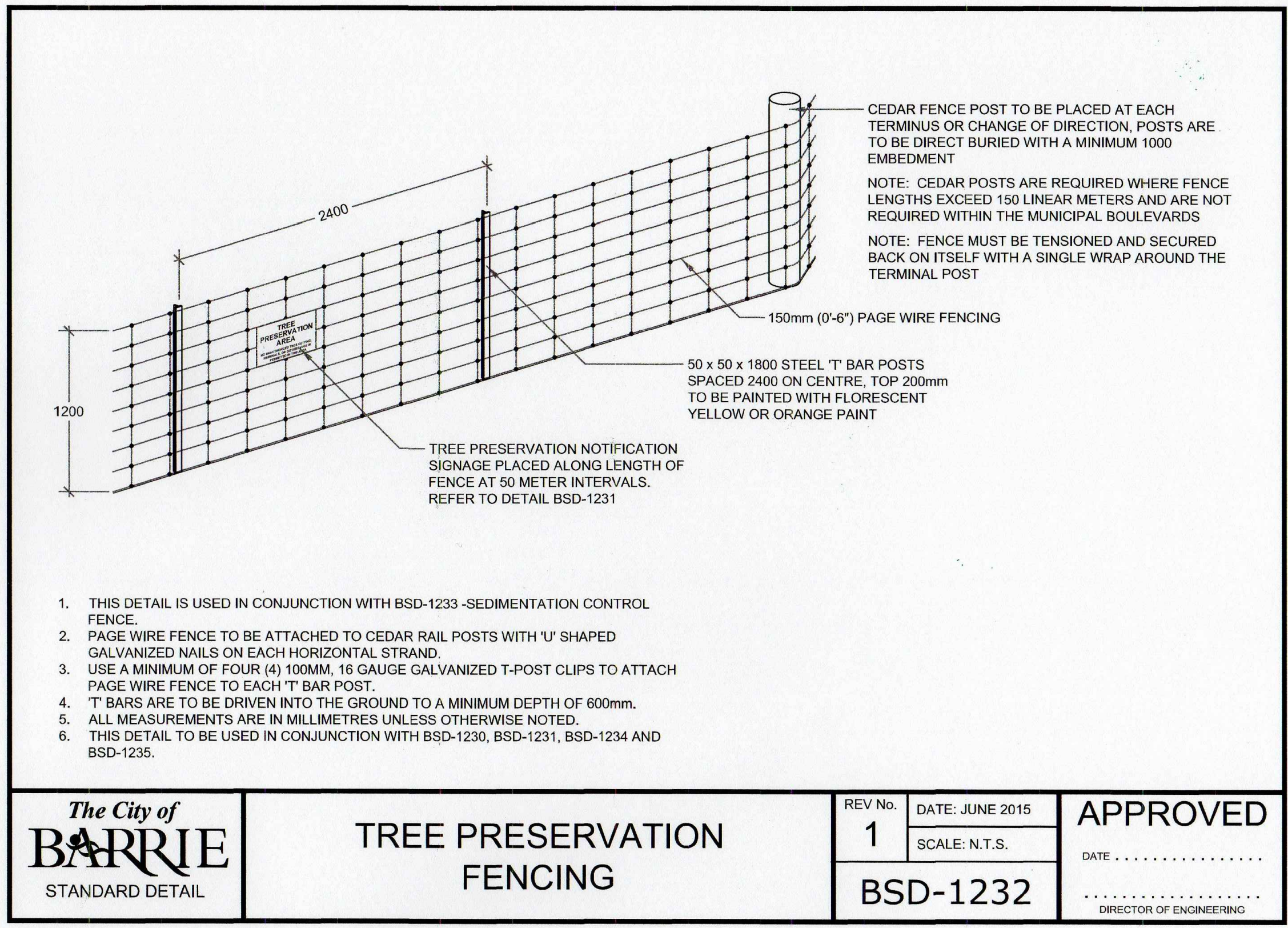
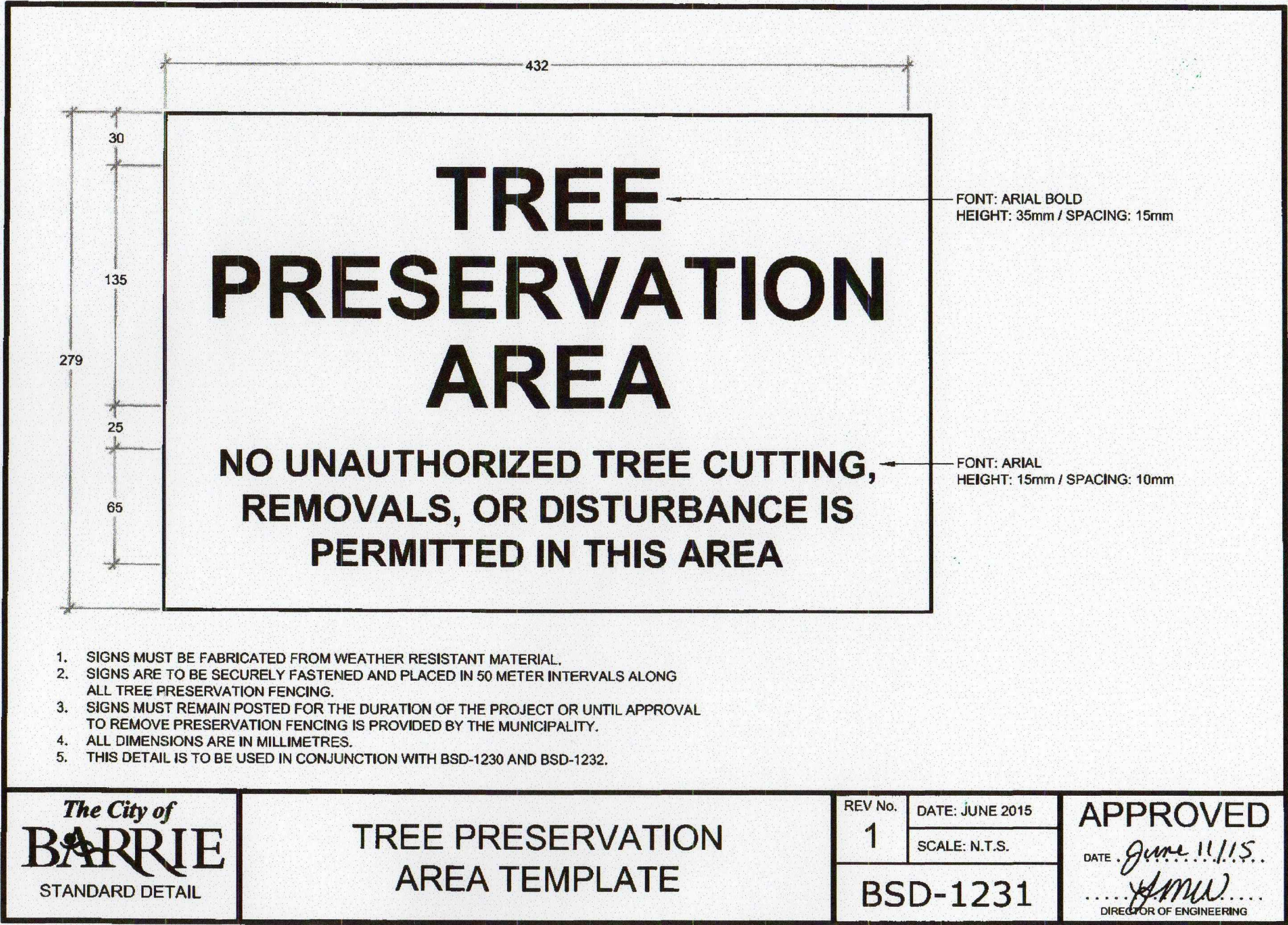

## TREE PRESERVATION NOTES

1. THE INTENT OF THE TREE PRESERVATION PLAN IS TO PROVIDE PROTECTION AND PRESERVATION FOR EXISTING TREES ON THE SUBJECT PROPERTY. THEREFORE, ALL TREES ARE TO BE PRESERVED UNLESS OTHERWISE INDICATED IN THE PLAN OR THE ARBORIST'S REPORT. CONTACT THE LANDSCAPE ARCHITECT TO CONFIRM THE REMOVAL/RETENTION STATUS OF ANY TREES ON SITE, PRIOR TO CLEARING AND GRUBBING. THE OWNER WILL TAKE EVERY PRECAUTION TO PROTECT AND PRESERVE THE TREES APPROVED TO BE RETAINED IN ACCORDANCE WITH THE APPROVED PLANS.

2. PRIOR TO THE COMMENCEMENT OF ANY CLEARING, GRUBBING OR CONSTRUCTION WORKS, THE REQUIRED HOARDING WILL BE ERCTED 5M OUTSIDE OF THE OUTERMOST DRIPLINE OF ANY TREE TO BE RETAINED, IN ACCORDANCE WITH THE HOARDING DETAIL, AND TO THE SATISFACTION OF THE LANDSCAPE ARCHITECT. ERECTION OF ANY PROTECTION FENCING LESS THAN 5M SHALL BE UNDER THE DIRECTION OF THE LANDSCAPE ARCHITECT.

3. IT IS THE RESPONSIBILITY OF THE CONTRACTOR TO ERECT AND MAINTAIN ALL HOARDING AS PER THE APPROVED DETAIL, PRESERVATION NOTES AND LOCATIONS SHOWN ON THE DRAWINGS.

4.NO STORAGE OF EQUIPMENT OR VEHICLES, NOR ANY STOCKPILING OF MATERIAL IS TO OCCUR WITHIN THE AREA OF PRESERVATION/PROTECTION. TREES SLATED FOR PROTECTION WILL NOT BE USED FOR RIGGING OR WRAPPING. THE PROTECTION/PRESERVATION AREA SHALL NOT BE USED TO EMPTY CONTAMINANTS, REFUELING OR REPAIR OF VEHICLES OR EQUIPMENT.

5. TREES LOCATED ON THE IMMEDIATE EDGE OF THE CONSTRUCTION WORKS ARE TO BE PRUNED IN THE INTEREST OF SAFETY, IN ACCORDANCE WITH APPROVED ARBORICULTURAL PRACTICES.

6. TREE LOCATIONS ARE APPROXIMATE AND THEREFORE VERIFICATION ON SITE IS REQUIRED.

7. SHOULD A TREE REQUIRED TO BE PROTECTED BECOME DAMAGED OR REMOVED WITHOUT WRITTEN PERMISSION OF THE CITY OF BARRIE OR THE LANDSCAPE ARCHITECT, THE CONTRACTOR OR OWNER WILL BE RESPONSIBLE FOR REPLACEMENT OF THE TREE OF EQUAL CALIPER AND ACCEPTABLE TREE SPECIES AT THE DISCRETION AND SATISFACTION OF THE LANDSCAPE ARCHITECT.

8. THE WORK COMPLETED BY THE CONTRACTOR WILL NOT CAUSE OR EXACERBATE FLOODING CONDITIONS OR CAUSE SEDIMENT BUILDUP OVER THE ROOTZONE OF PROTECTED TREES. NO GRADING SHALL TAKE PLACE WITHIN THE TREE PRESERVATION AREA UNLESS OTHERWISE APPROVED BY THE LANDSCAPE ARCHITECT.

9. ANY REQUIRED LIMB TRIMMING SHALL BE UNDER THE DIRECT SUPERVISION OF THE LANDSCAPE ARCHITECT OR A QUALIFIED ARBORIST.

10. PRESERVATION FENCING TO BE INSTALLED IN ACCORDANCE WITH THE APPROVED DETAIL. FILTER FABRIC TO BE INSTALLED IN CONJUNCTION WITH THE APPROVED ENGINEERING DRAWINGS.

11. HOARDING/TREE PRESERVATION MAY BE COMPLETED IN CONJUNCTION WITH SEDIMENTATION CONTROL.

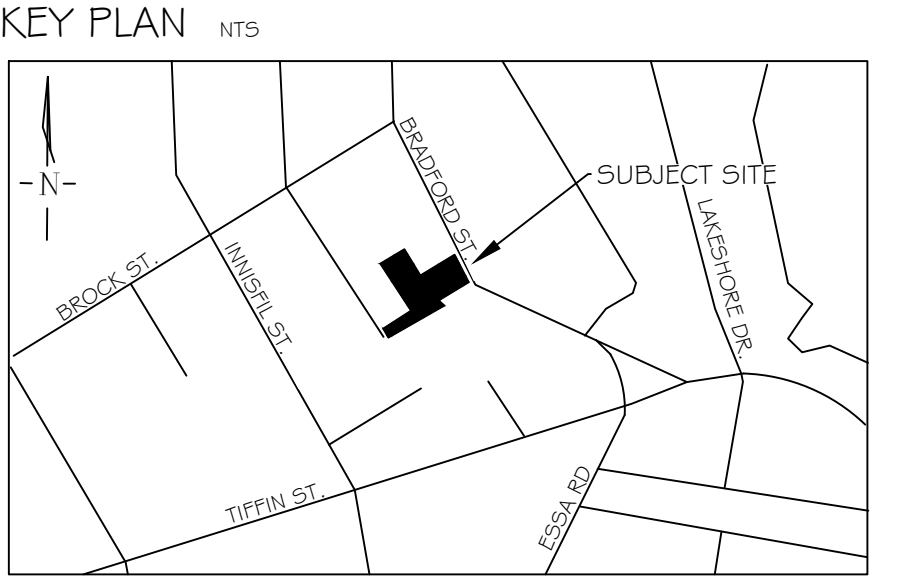

## GENERAL NOTES

The Client and its contractors are responsible for all utility locates and confirming all setbacks, elevations, grades, etc. prior to installation of the constructed works.

The Contractor is to report any discrepancies in writing to the Landscape Architect prior to proceeding with the works to determine the impact and suitability of the proposed works. The Landscape Architect will not be responsible for any unapproved adjustments on site.

Construction of the works must conform to Authority requirements and applicable codes where they have jurisdiction.

All specifications and drawings are instruments of service and are the property and ownership of the Landmark Environmental Group Ltd. As such, the drawings shall not be modified or reproduced without the expressed written consent of Landmark Environmental Group Ltd. or they will be considered void. The seal drawings are for Site Plan approval only and may require additional detailing prior to tender and construction.

The Landmark Environmental Group Ltd. is not liable for errors or omissions from the use of these drawings prior to approval, seal, signature and date, and will be considered void.

It is advised that the Contractor contact the Landscape Architect prior to commencement of the construction works to ensure that the Contractor has the latest approved drawings.

The Landmark Environmental Group Ltd. is not responsible for the accuracy of the base drawing information (eg Survey, Architectural, Engineering, etcO. If there are any discrepancies, the Contractor will refer to the appropriate base drawing information and report discrepancies on the Landscape Drawings to the Landscape Architect.

© Drawing set is protected under copyright.

## LEGEND

NO	DATE	BY	REVISIONS
STAMP		APPROVAL	

<b>LANDMARK</b> ENVIRONMENTAL GROUP LTD	<b>LANDSCAPE ARCHITECTS &amp; CONSULTING ARBORISTS</b>  OFFICE: 705-796-1122 info@LEGroupLtd.com www.LEGroupLtd.com
--	---

CLIENT: CHAYELL HOSPITALITY GROUP 7815 KENT BLVD, BROCKVILLE	
PROJECT: 220 BRADFORD STREET BARRIE	
DRAWING: DETAILS	
SCALE BAR:	
PROJECT NO.: LA 439-19	SCALE: N.T.S
MUNICIPAL FILE NO.:	DATE: JANUARY 16, 2020
DRAWN BY: K.S/J.G	CHECKED BY: J.H DRAWING No.: D-1











MLST1050B-BH-PC

1050 SERIES



**MATERIALS:** The stool frame is constructed from formed steel and the tops employ 3/4" HDPC.

**FINISH:** All steel components are protected with E-Coat rust proofing. The Maglin Powdercoat System provides a durable finish on all metal surfaces.

**INSTALLATION:** The stool comes preassembled with boards. The legs have 9/16" holes for anchoring.

**TO SPECIFY:** Select MLST1050B-BH-PC  
Choose:  
- Powdercoat Color  
- HDPC Color

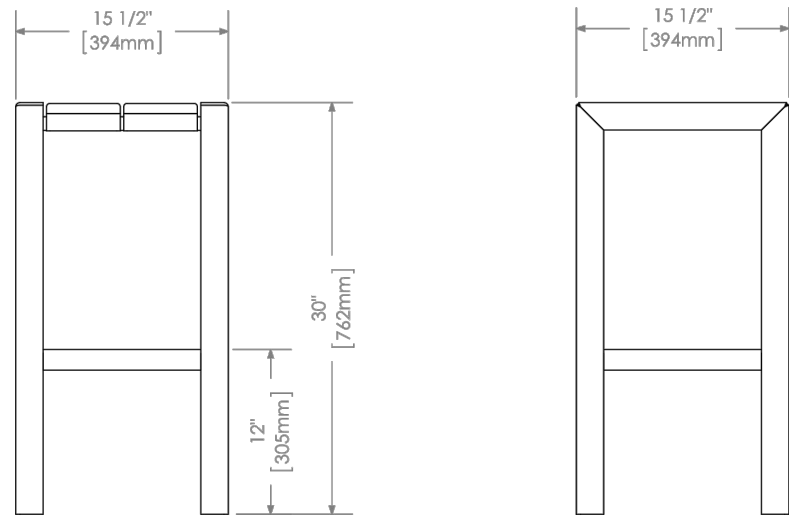

**DIMENSIONS:**  
Height: 30" (76.2cm)  
Length: 15.5" (39.4cm)  
Depth: 15.5" (39.4cm)  
Weight: 46.3lbs (21.0kg)



All drawings, specifications, design and details on this page remain the property of Maglin Site Furniture Inc. and may not be used without Maglin authorization. Details and specifications may vary due to continuing improvements of our products.

T: 800-716-8808  
F: 877-880-8263  
www.maglin.com  
sales@maglin.com

MCL720-M

720 SERIES



**MATERIALS:** The Chaise Lounge frame is constructed of laser cut and formed steel. The seat employs Steel.

**FINISH:** All steel components are protected with E-Coat rust proofing. The Maglin Powdercoat System provides a durable finish on all metal surfaces.

**INSTALLATION:** The chaise is delivered pre-assembled. Holes (0.5") are provided in each foot for securing to base.

**TO SPECIFY:** Select MCL720-M  
Choose:  
- Powdercoat Color

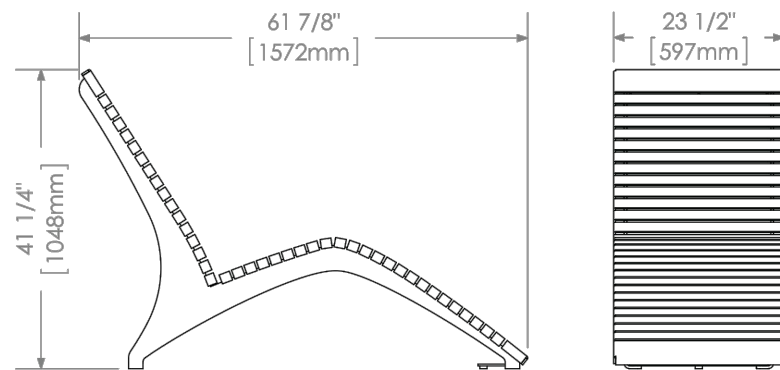

**DIMENSIONS:**  
Height: 41.25" (104.8cm)  
Length: 61.88" (157.2cm)  
Depth: 23.5" (59.7cm)  
Weight: 201.6lbs (91.5kg)



All drawings, specifications, design and details on this page remain the property of Maglin Site Furniture Inc. and may not be used without Maglin authorization. Details and specifications may vary due to continuing improvements of our products.

T: 800-716-8808  
F: 877-880-8263  
www.maglin.com  
sales@maglin.com

MLP1500-MPR-R4

1500 SERIES

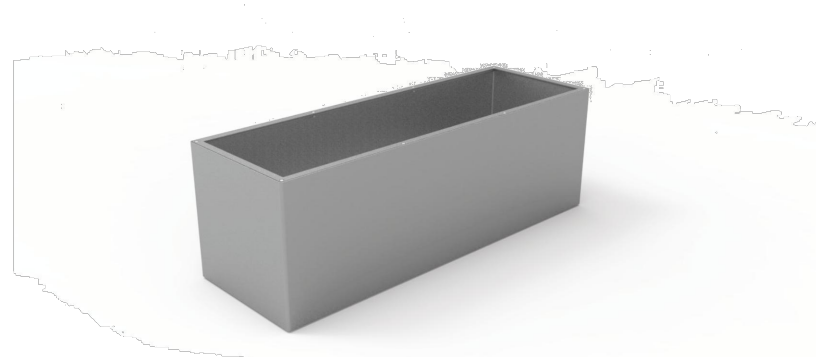

**MATERIALS:** The planter's outer structure is made from formed steel. A polyurethane/polyurea waterproof coating coats the inside.

**FINISH:** All steel components are protected with E-Coat rust proofing. The Maglin Powdercoat System provides a durable finish on all metal surfaces.

**INSTALLATION:** Planter comes pre-assembled and can be installed freestanding, or surface mounted. A plug in the middle can be removed if drainage is desired.

**TO SPECIFY:** Select MLP1500-MPR-R4  
Choose:  
- Powdercoat Color

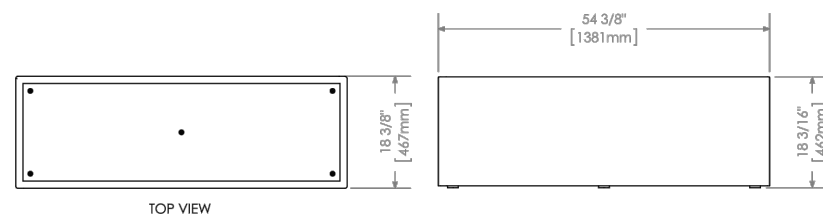

**DIMENSIONS:**  
Height: 38.13" (96.9cm)  
Length: 54.38" (138.1cm)  
Depth: 18.38" (46.7cm)  
Weight: 167.50lbs (75.9kg)



All drawings, specifications, design and details on this page remain the property of Maglin Site Furniture Inc. and may not be used without Maglin authorization. Details and specifications may vary due to continuing improvements of our products.

T: 800-716-8808  
F: 877-880-8263  
www.maglin.com  
sales@maglin.com

MLP1500-MPS-S2

1500 SERIES

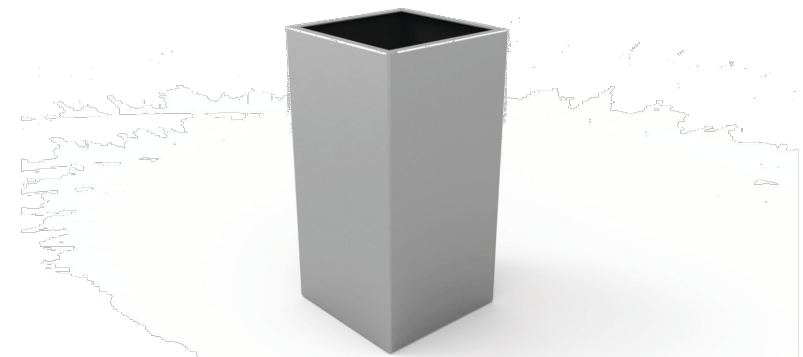

**MATERIALS:** The planter's outer structure is made from formed steel. A polyurethane/polyurea waterproof coating coats the inside.

**FINISH:** All steel components are protected with E-Coat rust proofing. The Maglin Powdercoat System provides a durable finish on all metal surfaces.

**INSTALLATION:** Planter comes pre-assembled and can be installed freestanding, or surface mounted. A plug in the middle can be removed if drainage is desired. Please reference INTALL\_MLP1500 for more detailed installation information.

**TO SPECIFY:** Select MLP1500-MPS-S2  
Choose:  
- Powdercoat Color

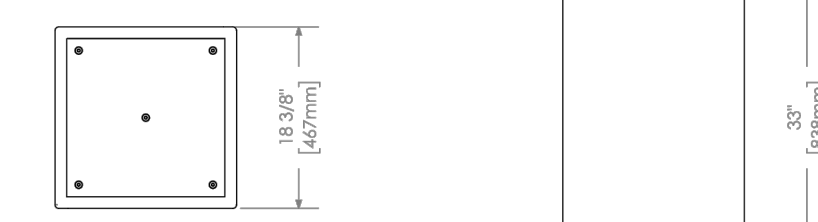

**DIMENSIONS:**  
Height: 33.00" (83.82cm)  
Length: 38.38" (97.7cm)  
Depth: 18.38" (46.7cm)  
Weight: 113.00lbs (51.4kg)



All drawings, specifications, design and details on this page remain the property of Maglin Site Furniture Inc. and may not be used without Maglin authorization. Details and specifications may vary due to continuing improvements of our products.

T: 800-716-8808  
F: 877-880-8263  
www.maglin.com  
sales@maglin.com

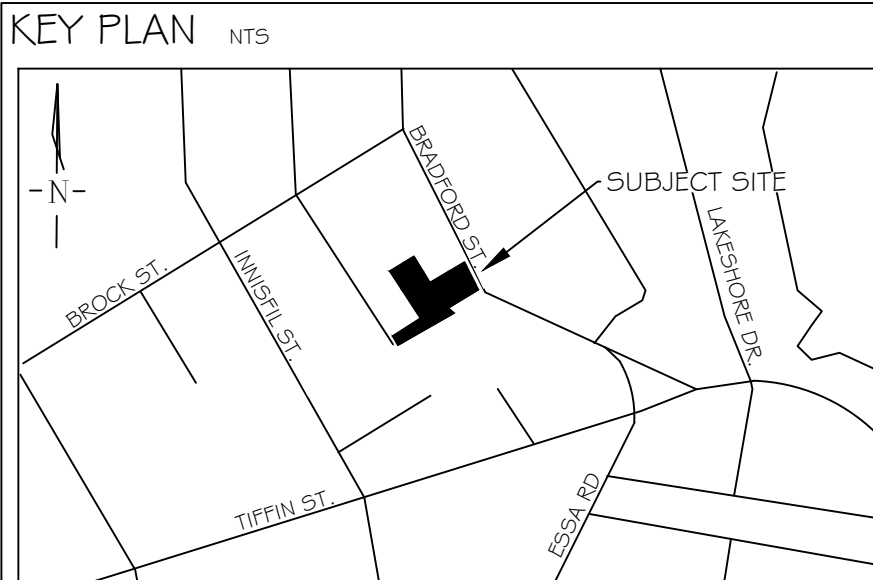

**GENERAL NOTES**

The Client and its contractors are responsible for all utility locates and confirming all setbacks, elevations, grades, etc. prior to installation of the constructed works.

The Contractor is to report any discrepancies in writing to the Landscape Architect prior to proceeding with the works to determine the impact and suitability of the proposed works. The Landscape Architect will not be responsible for any unapproved adjustments on site.

Construction of the works must conform to Authority requirements and applicable codes where they have jurisdiction.

All specifications and drawings are instruments of service and are the property and ownership of the Landmark Environmental Group Ltd. As such, the drawings shall not be modified or reproduced without the expressed written consent of Landmark Environmental Group Ltd. or they will be considered void. The said drawings are for Site Plan approval only and may require additional detailing prior to tender and construction.

The Landmark Environmental Group Ltd. is not liable for errors or omissions from the use of these drawings prior to approval, seal, signature and date, and will be considered void.

It is advised that the Contractor contact the Landscape Architect prior to commencement of the construction works to ensure that the Contractor has the latest approved drawings.

The Landmark Environmental Group Ltd. is not responsible for the accuracy of the base drawing information (eg Survey, Architectural, Engineering, etcO. If there are any discrepancies, the Contractor will refer to the appropriate base drawing information and report discrepancies on the Landscape Drawings to the Landscape Architect.

© Drawing set is protected under copyright.

LEGEND

FRT1700-RD-M1-FS-30

FORO SERIES



**MATERIALS:** The table base is constructed of steel plate and the post is steel tube. The top is laser cut steel with a steel tube outer ring.

**FINISH:** All steel components are protected with E-Coat rust proofing. The Maglin Powdercoat System provides a durable finish on all metal surfaces.

**INSTALLATION:** The table comes pre-assembled with 4 leveling feet.

**TO SPECIFY:** Select FRT1700-RD-M1-FS-30  
Choose:  
- Powdercoat Color

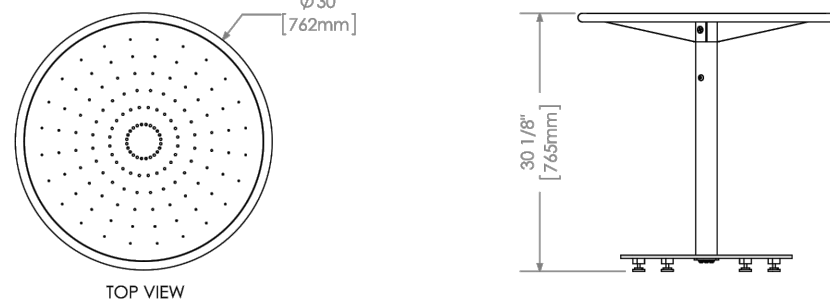

**DIMENSIONS:**  
Height: 30.13" (76.5cm)  
Diameter: 30" (76.2cm)  
Weight: 81.6lbs (37.3kg)



All drawings, specifications, design and details on this page remain the property of Maglin Site Furniture Inc. and may not be used without Maglin authorization. Details and specifications may vary due to continuing improvements of our products.

T: 800-716-8808  
F: 877-880-8263  
www.maglin.com  
sales@maglin.com

MLTB1050-BH-PC

1050 SERIES



**MATERIALS:** The table frame is constructed from formed steel and the tops employ 3/4" HDPC.

**FINISH:** All steel components are protected with E-Coat rust proofing. The Maglin Powdercoat System provides a durable finish on all metal surfaces.

**INSTALLATION:** The table is delivered pre-assembled. The legs have 9/16" holes for anchoring.

**TO SPECIFY:** Select MLTB1050-BH-PC  
Choose:  
- Powdercoat Color  
- HDPC Color  
(Charcoal, Sandstone)

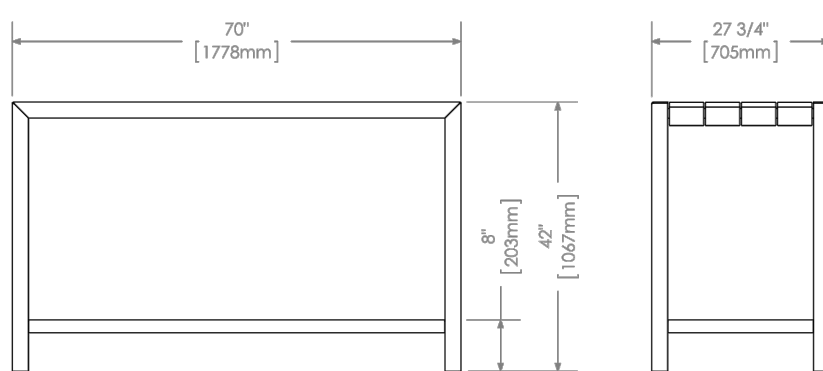

**DIMENSIONS:**  
Height: 42" (106.7cm)  
Length: 70" (177.8cm)  
Depth: 27.5" (70.5cm)  
Weight: 190.6lbs (86.5kg)



All drawings, specifications, design and details on this page remain the property of Maglin Site Furniture Inc. and may not be used without Maglin authorization. Details and specifications may vary due to continuing improvements of our products.

T: 800-716-8808  
F: 877-880-8263  
www.maglin.com  
sales@maglin.com

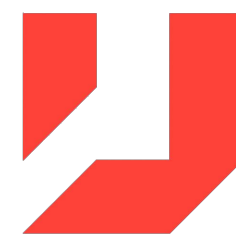
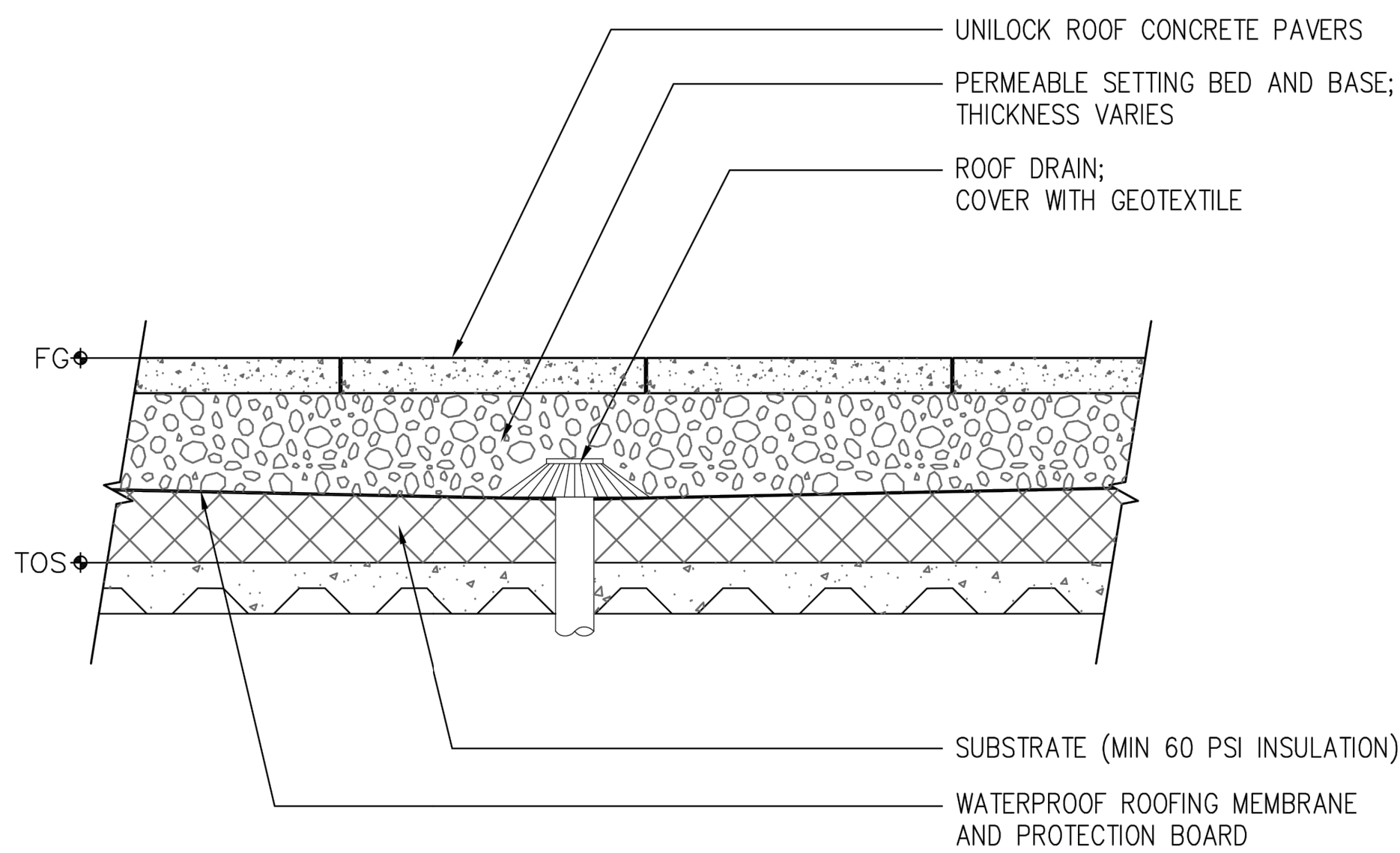

COMMERCIAL APPLICATION  
ROOF PAVES DETAIL

CREATED: DECEMBER 13, 2013  
REVISED: MARCH 6, 2014

FILE NAME: CS-9-COM-PAVER-ROOF.DWG

**NOTES:**  
This cross section is intended for preliminary design purposes only. Confirm site conditions and consult with a qualified design professional or installer prior to installation.

**CROSS SECTION**  
ROOF PAVERS ON PERMEABLE BASE

**UNILOCK**  
DESIGNED TO CONNECT.

**LANDMARK**  
ENVIRONMENTAL GROUP LTD

**LANDSCAPE ARCHITECTS & CONSULTING ARBORISTS**

OFFICE: 705-796-1122  
info@LEGGroupLtd.com  
www.LEGroupLtd.com

CLIENT:  
CHAYELL HOSPITALITY GROUP  
7815 KENT BLVD, BROCKVILLE

PROJECT:  
220 BRADFORD STREET  
BARRIE

DRAWING: DETAILS

SCALE BAR:

PROJECT NO.: LA 439-19  
SCALE: N.T.S

MUNICIPAL FILE NO.:  
DATE: JANUARY 16, 2020

DRAWN BY: K.S/J.G  
CHECKED BY: J.H  
DRAWING No.: D-4