

KEY MAP

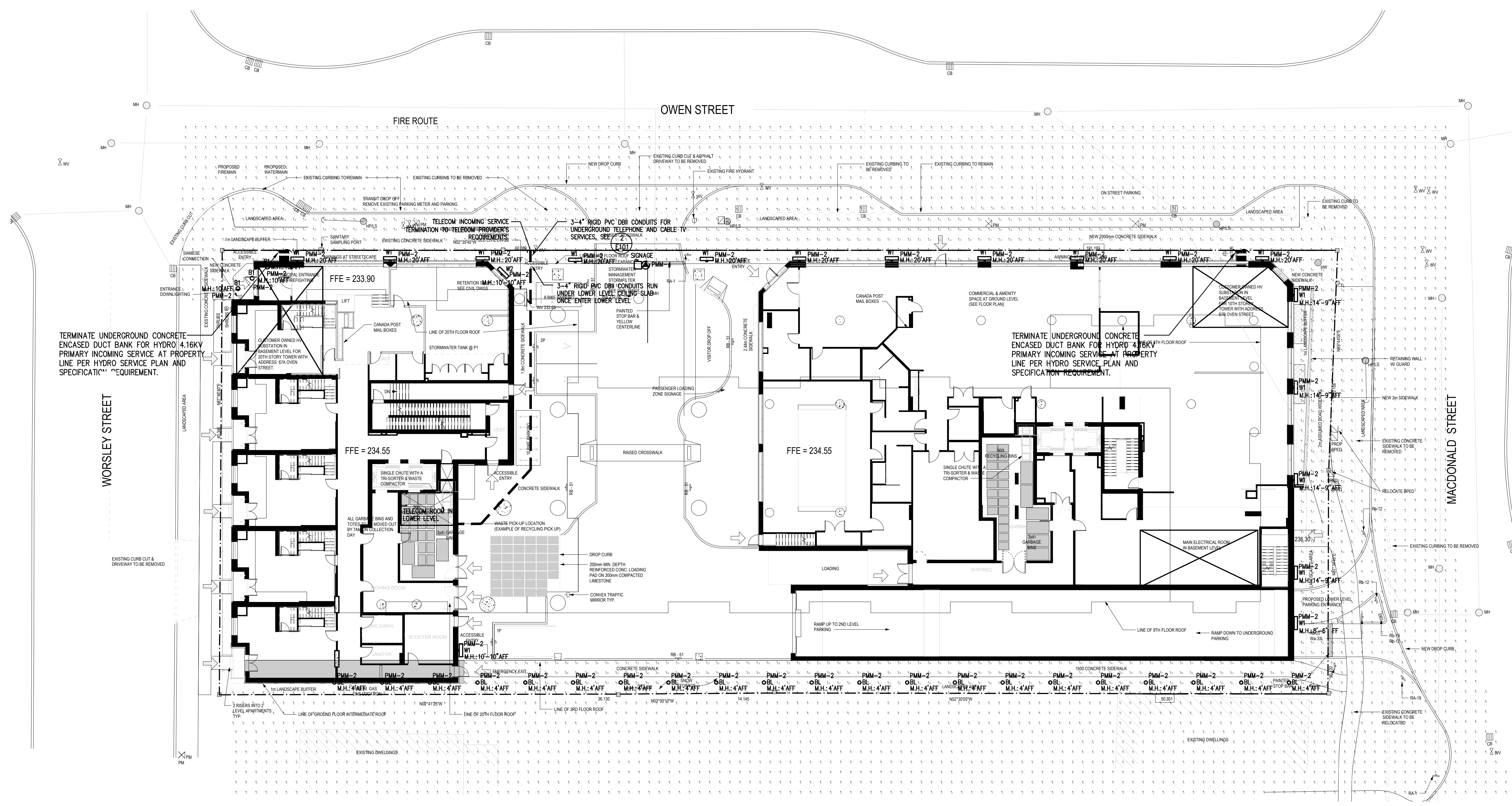
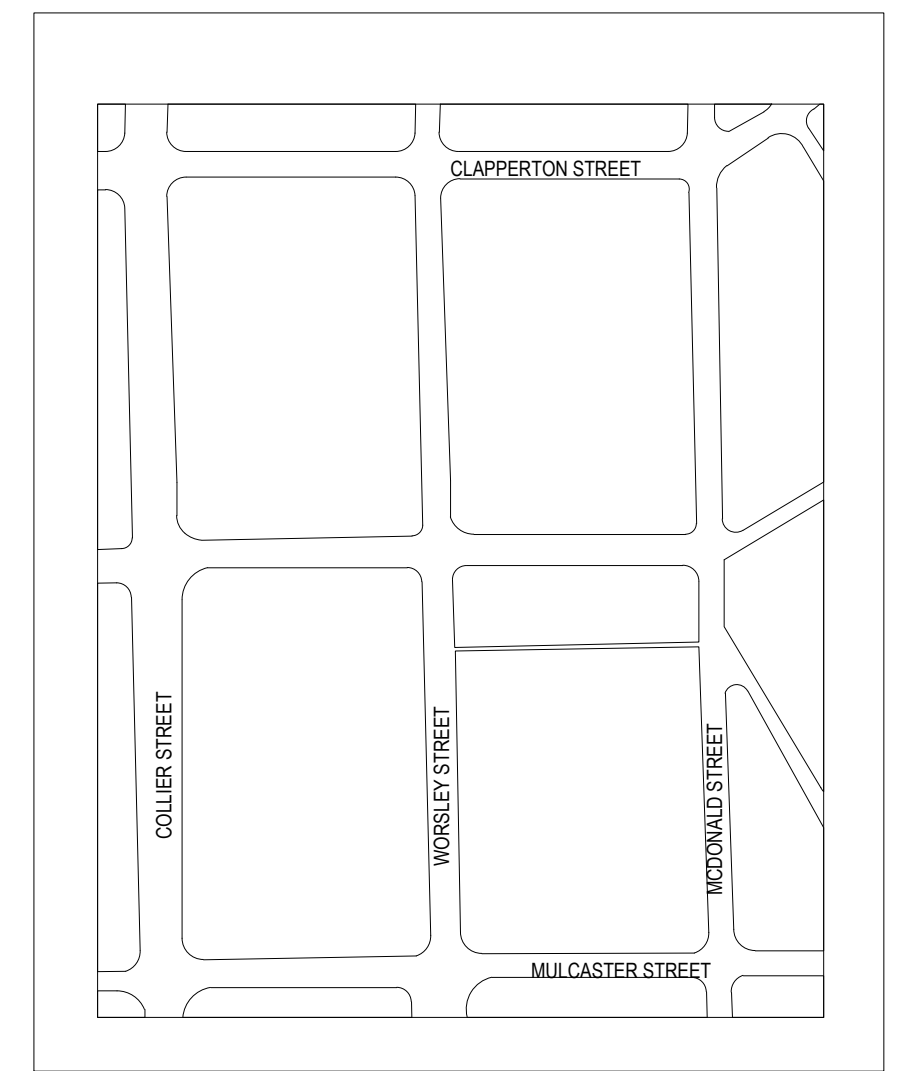

1 SITE PLAN  
E101 1:200

**DRAWING NOTES:**

- EXTERIOR LIGHTING AND SIGNAGE SHALL BE CONTROLLED BY PHOTOCELL WITH MANUAL OVERRIDE SWITCH AND TIMER. REFER TO SPECIFICATIONS FOR MORE INFORMATION. CONFIRM EXACT ELECTRICAL REQUIREMENTS WITH SIGNAGE MANUFACTURER.
- RUN MINIMUM #8AWG WIRING AND TYPE II PVC CONDUITS FOR ALL EXTERIOR LIGHTING.
- GENERAL NOTES FOR INCOMING SERVICE FROM LOCAL HYDRO CONSTRUCTION NOTES:
  - EC SHALL NOT START THE SITE SERVICE WORK UNTIL RECEIVED LOCAL HYDRO SITE SERVICING PLAN INCLUDING THE SERVICE INCOMING LOCATION, APPROVED TR LOCATION, HYDRO ASSIGNED HYDRO STANDARD SPECIFICATION FOR PRIMARY DUCT BANK DUCTS NUMBER, PRIMARY CABLES, PAD-MOUNT TR FOUNDATION, GROUNDING, PROTECTION & SPECIFICATION, SCOPE OF WORK, ETC. AS INSTRUCTION TO PROVIDE ALL REQUIRED MATERIALS AND LABOR TO SUIT.
  - ELECTRICAL CONTRACTOR WILL SUBMIT THE MAIN SWITCHBOARD AND BULK METER CABINET SHOP DRAWING FOR HYDRO APPROVAL PRIOR TO ORDER. THIS ENSURES THE METERING COMPARTMENT WILL MEET HYDRO METERING EQUIPMENT.
  - ALL CIVIL WORK AROUND UNDERGROUND PRIMARY AND HYDRO EQUIPMENT WILL BE COORDINATED WITH HYDRO ON SITE PRIOR TO PROCEED.
  - ALL SECONDARY CABLES, CONDUITS AND TERMINATIONS WILL BE THE RESPONSIBILITY OF ELECTRICAL OR AS DEFINED BY HYDRO "OFFER TO CONNECT".
  - GROUNDING AT PAD-MOUNT TR SUPPLIED AND INSTALLED BY ELECTRICIAN ACCORDING TO HYDRO CONSTRUCTION STANDARD REQUIREMENT AND OBTAIN HYDRO APPROVAL.
  - EC SHALL OBTAIN HYDRO SERVICING PLAN FOR THIS PROJECT PRIOR TO COMMENCEMENT OF ANY SITE EXCAVATION.

LUMINAIRE SCHEDULE					
TYPE	DESCRIPTION	LAMPS AND BALLAST	CATALOGUE NO.	IMAGE	DIV. 16 SUPPLIED
WT	EXTERIOR LED WALL MOUNTED FIXTURE, FULL CUT-OFF, WITH SILICONE SEALED OPTICAL AND DIE-CAST ALUMINUM HOUSING. COLOR FINISH AS PER ARCHITECT'S SELECTION. IP66 RATED. APPLICATION: SITE	12.2W LED, 1418 LUMENS, 347V DRIVER, 4000K, 70CRI	COOPER LIGHTING XTOR1B-W-347V SERIES OR APPROVED EQUAL		✓
BT	EXTERIOR CANOPY RECESSED 6" DIA., LED DOWNLIGHT, C/W REGRESSED LENS AND GALVANIZED STEEL PLASTER FRAME. TRIM COLOR FINISH AS PER ARCHITECT'S SELECTION. IP65 RATED. APPLICATION: SITE	14W LED, 1410 LUMENS, 347V DRIVER, 4000K, 80CRI	COOPER LIGHTING HC815D010347-HM612840-61WDH SERIES OR APPROVED EQUAL		✓
BL	EXTERIOR 6" DIA. 42" HIGH ROUND BASE BOLLARD LED FIXTURE, C/W 6" CONCRETE BASE, PATH ASYMMETRIC DISTRIBUTION, FULL CUTOFF, ALUMINUM HOUSING WITH CAST BASE AND TOP, POLYCARBONATE LENS. TRIM COLOR FINISH AS PER ARCHITECT'S SELECTION. IP66 RATED. APPLICATION: SITE	5.4W LED, 537 LUMENS, 347V DRIVER, 4000K, 70CRI	COOPER LIGHTING BR16-A1-740-9-13-42 SERIES OR APPROVED EQUAL		✓

**NOTES:**

- ONLY "SHIELDED" LIGHTING FIXTURES ARE PERMITTED FOR ALL DEVELOPMENT, EXCEPT FOR DETACHED AND SEMI-DETACHED DWELLINGS WITHIN 60 M (196.8 FT.) OF A RESIDENTIALLY ZONED PROPERTY AND MUST CONFORM TO THE ENGINEER CERTIFIED LIGHTING PLAN.
- ALL LIGHTING FIXTURES TO BE DARKSKY COMPLAINT TO THE SATISFACTION OF LOCAL AHA.
- COORDINATE ON SITE FOR FIXTURES' REMOTE DRIVERS LOCATION WHEN REQUIRED.

Calculation Summary							
Label	CalcType	Units	Avg	Max	Min	Avg/Min	Max/Min
CANOPY	Illuminance	Lux	143.34	198.3	71.3	2.01	2.78
SITE	Illuminance	Lux	13.68	136	0	N.A.	N.A.
SPILLAGE	Illuminance	Lux	1.60	10	0	N.A.	N.A.

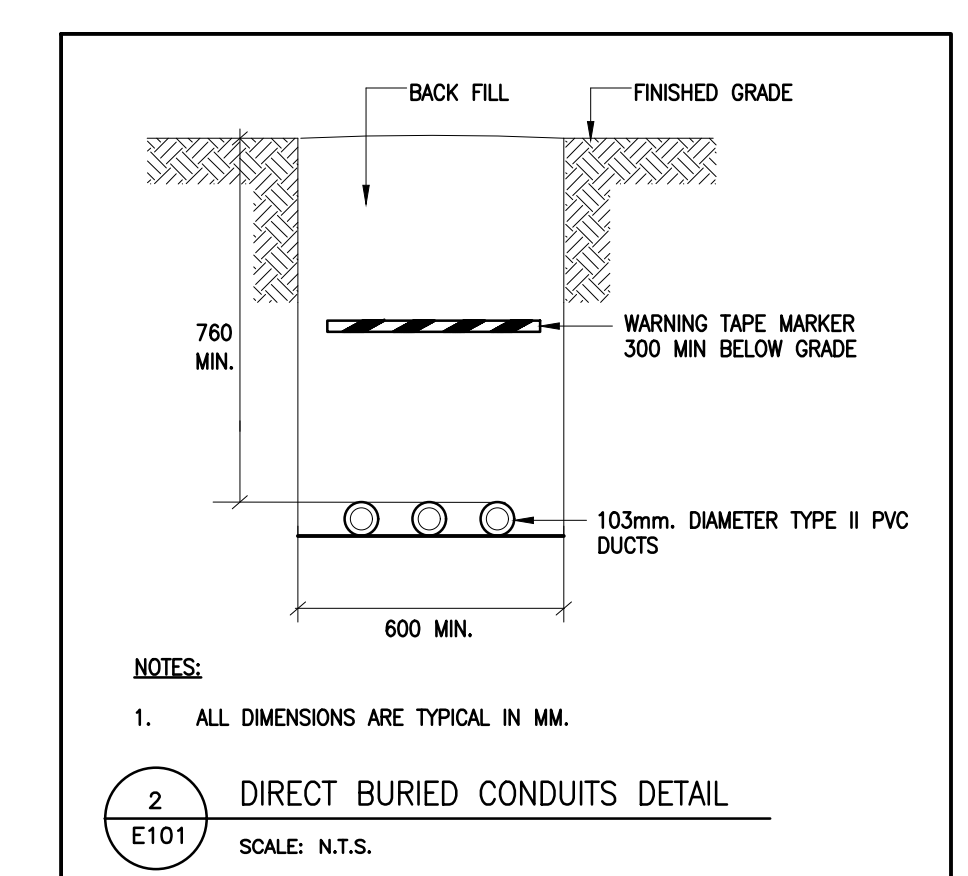

ISSUES/REVISIONS		
6	RESUBMISSION FOR SPA	AUG. 23, 2022
5	RE-ISSUED FOR PERMIT	AUG. 12, 2022
4	ISSUED FOR PERMIT	JUN. 21, 2022
3	RESUBMISSION FOR SPA	APR. 29, 2022
2	RESUBMISSION FOR SPA	NOV. 18, 2021
1	ISSUED FOR SPA	JUN. 23, 2021

ALL DIMENSIONS TO BE CHECKED AND VERIFIED ON SITE. DISCREPANCIES TO BE REPORTED TO THE ARCHITECT. LATEST APPROVED STAMPED DRAWINGS ONLY TO BE USED FOR CONSTRUCTION.

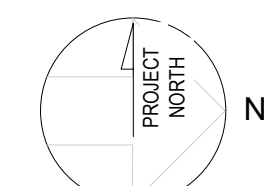

**Jain**  
7405 EAST DANBRO CRESCENT  
MISSISSAUGA, ONTARIO, L5N 6P8  
TEL: 905 285 9900, FAX 905 567 5246  
Email: mail@jainconsultants.com

**DRAWING TITLE:**  
SITE PLAN - ELECTRICAL LAYOUT

**PROJECT NAME:**  
OWEN STREET  
55-57 MACDONALD STREET, 61-67 OWEN STREET AND 70-78 WORSLEY STREET BARRIE, ON  
(FOR THE EASE OF REFERENCE, THE SITE WILL BE DESCRIBED AS 67 OWEN STREET)  
THE RESIDENCES ON OWEN LTD.

**DATE:** 02/15/2022 **PROJECT #** **SHEET #**  
**DRAWN BY:** KSN **PROJECT #**  
**SCALE:** As indicated **#**