

# Schedule 'A'

## Proposed Zoning By-Law Amendment

Part of Lots 5,6 and 7  
Registered Plan 1200  
City of Barrie, County of Simcoe  
2021

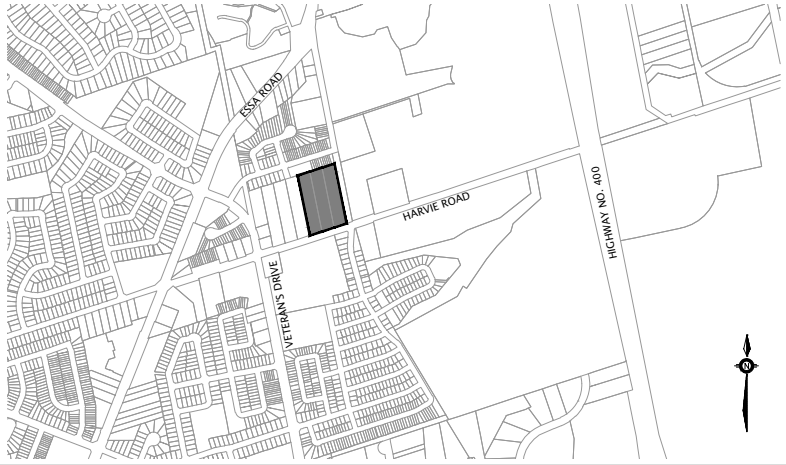

- Lands Subject to Zoning By-Law Amendment
- Lands to be Zoned Single Detached Residential 4 Exception (R4 SP-XXX) Zone
- Lands to be Zoned Multiple Residential Exception (RM2 SP-XXX) / Apartment Dwelling First Density - 2 Exception (RA1-2 SP-XXX) Zones
- Lands to be Zoned Multiple Residential Exception (RM2 SP-XXX) Zone

Scale 1:25,000 (8.5x11)

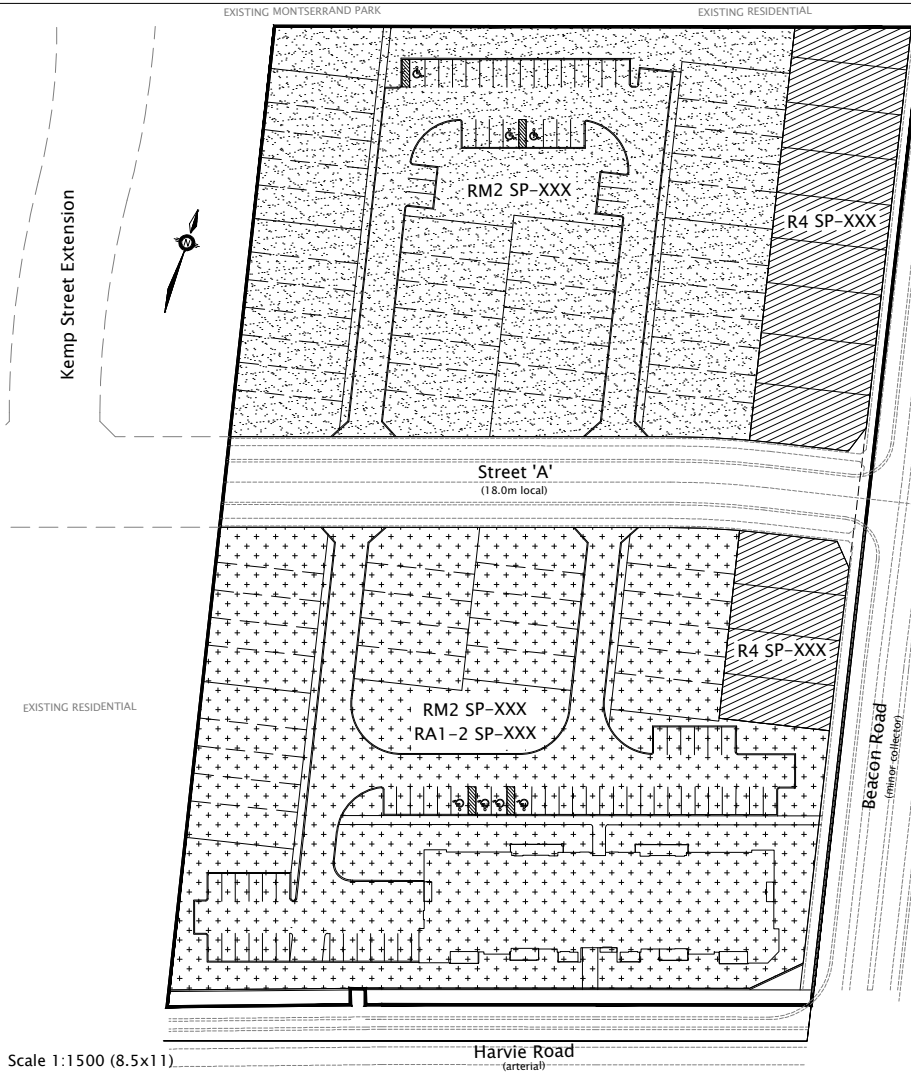

Scale 1:1500 (8.5x11)



ASA-20533-zbla-1.dwg  
21-09-24

**CONSULTING GROUP LTD.**  
**PLANNERS & ENGINEERS**  
229 Mapleview Drive East, Unit 1, Barrie, Ontario, L4N 0W5  
Phone: 705-734-2533 Fax: 705-734-1056  
www.jonesconsulting.com