

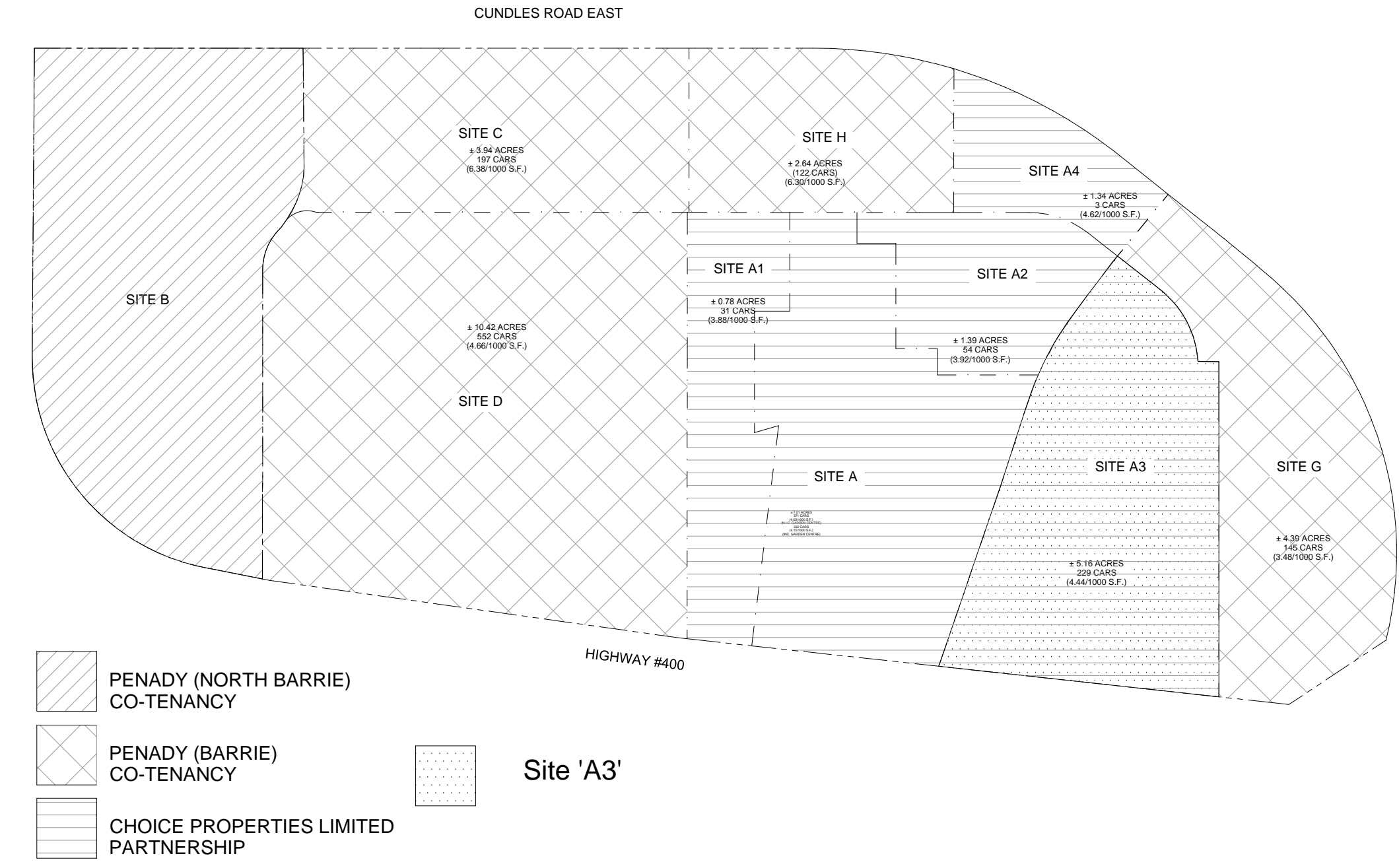

1 Site 'A3' Layout and Planting Plan  
L.3 SCALE: 1:300



3 OWNERSHIP PLAN  
N.T.S.

SITE 'A3' (COMMERCIAL LANDS 5.16 Ac = ±20,882 SQ.M.)  
LANDSCAPE PLANT LIST

Key	Botanical Name	Common Name	Cal.	Ht./Sp.	Cond.
<b>CONIFEROUS TREES</b>					
PP	18 Picea glauca	White Spruce	200cm	WB	
PP	25 Picea pungens	Colorado Spruce	200cm	WB	
PROVIDED IN ULTIMATE LANDSCAPE = 43 TOTAL REQUIRED UNDER UDG = 42					
<b>DECIDUOUS TREES</b>					
AT	19 Acer x freemontii 'Jefferson'	Autumn Blaze Maple	60mm	WB	
ARF	7 Acer rubrum 'Tranström'	Red Sunset Maple	60mm	WB	
CO	5 Cotinus occidentalis	Common Hackberry	60mm	WB	
GB	2 Ginkgo biloba	Maidenhair Tree	60mm	WB	
GTS	13 Quercus macrocarpa var. 'laevis' 'Skyline'	Skyline Ironoak	60mm	WB	
PG	4 Prunus coccinea 'Van's Form'	Chantrelle Ornamental Pear	60mm	WB	
PR	13 Prunus coccinea 'Redspire'	Redspire Ornamental Pear	60mm	WB	
QP	6 Quercus pedunculata	Pink Oak	60mm	WB	
QB	9 Quercus rubra	Red Oak	60mm	WB	
PROVIDED IN ULTIMATE LANDSCAPE = 74 TOTAL REQUIRED UNDER UDG = 70					
<b>CONIFEROUS/EVERGREEN SHRUBS</b>					
mp	46 Juniperus x media 'Yilderiana'	PRIEZE Juniper	50cm	3 gal. pot	
pr	37 Juniperus sabina	Savin Juniper	50cm	3 gal. pot	
mp	32 Pinus mugo var. 'pumila'	Mugo Pine	50cm	3 gal. pot	
top	42 Taxus canadensis 'Nana'	Dwarf Canadian Yew	50cm	3 gal. pot	
tmh	18 Taxus media 'Hicksii'	Hicks' Yew	50cm	3 gal. pot	
to	14 Thuja occidentalis	White Cedar	1.2m HT	pot	
PROVIDED IN ULTIMATE LANDSCAPE = 209 TOTAL REQUIRED UNDER UDG = 209					
<b>DECIDUOUS SHRUBS</b>					
sg	170 Desmodium illinoense	Slender Desmodium	60cm	3 gal. pot	
pe	6 Physocarpus x opulifolius 'Auratus'	Golden Birch Orange	60cm	3 gal. pot	
po	15 Physocarpus opulifolius	Common Ninebark	60cm	3 gal. pot	
pr	19 Prunus virginiana	Common Dogwood	60cm	3 gal. pot	
rr	10 Rosa rugosa	Japanese Rose	60cm	3 gal. pot	
sd	28 Spiraea x japonica 'Goldflame'	Goldflame Spirea	60cm	3 gal. pot	
sgm	12 Spiraea x japonica 'Goldmound'	Gold Mound Spirea	60cm	3 gal. pot	
sm	12 Spiraea x japonica 'Palmer'	Dwarf Korean Lilac	60cm	3 gal. pot	
st	7 Sorbus arbuscula	Fairy Spindle	60cm	3 gal. pot	
PROVIDED IN ULTIMATE LANDSCAPE = 418 TOTAL REQUIRED UNDER UDG = 418					
<b>PERENNIALS AND GRASSES</b>					
sp	177 Thymus serpyllifolius 'Honey'	Dwarf Fountain Grass	40cm	3 gal. 1 gal. pot	
PROVIDED IN ULTIMATE LANDSCAPE = 17 TOTAL REQUIRED UNDER UDG = 0					

SITE 'A3' PLANTING STATISTICS  
AREA (X) = 5.16 ac = 20,882 sq.m.

	Required under UDG	Provided
DECIDUOUS TREES (AREA/500)	70	74
CONIFEROUS TREES (AREA/500)	42	43
DECIDUOUS SHRUBS (AREA/500)	418	418
CONIFEROUS SHRUBS (AREA/100)	209	209

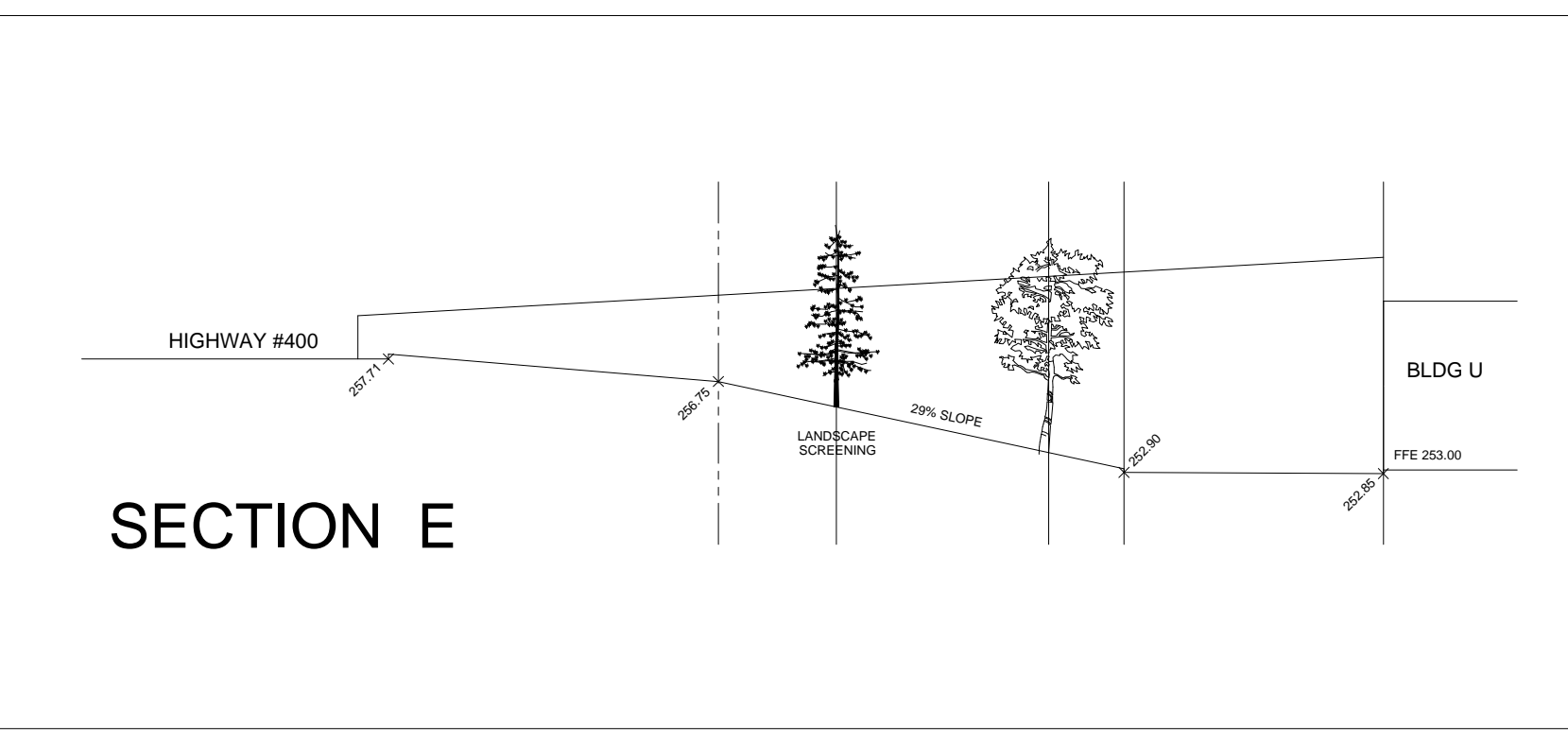

SECTION E

KEY PLAN  
N.T.S.

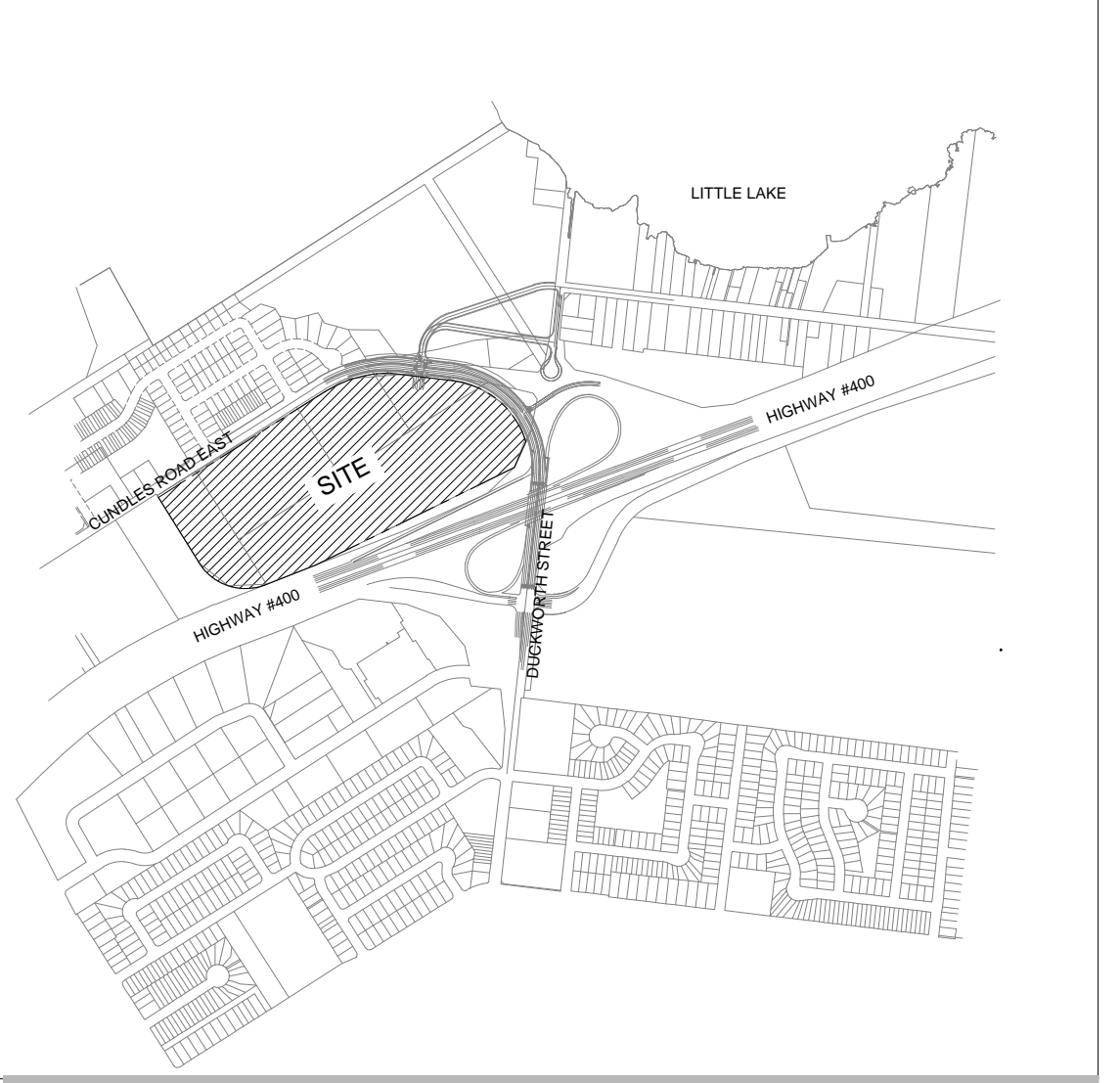

LEGEND

- PROPOSED DECIDUOUS TREE
- PROPOSED CONIFEROUS TREE
- PROPOSED CONTINUOUS SHRUB BED
- PERENNIAL GRASSES/FLOWERS
- SODDED AREA
- LIMIT OF PHASE 2
- PROPOSED CONCRETE PAVING
- PROPOSED COLOURED CONCRETE BAND - TYPE 'A'
- PROPOSED COLOURED CONCRETE BAND - TYPE 'B'
- PROPOSED COLOURED CONCRETE BAND - TYPE 'C'
- HYDROSEED AREA
- PROPOSED RETAINING WALL WITH DECORATIVE BLACK GUARD RAIL
- PROPOSED GLASS SCREEN AT PATIOS
- LIMESTONE LEDGERROCK
- PROPOSED BENCH
- PROPOSED TRASH RECEPTACLE
- PROPOSED BIKE RACK
- PLANTING REFERENCE KEY
- DETAIL REFERENCE KEY

NOTES

1. Do not scale the drawings. All dimensions are in millimetres unless noted otherwise.
2. This drawing is to be read in conjunction with the master site plan prepared by Turner Fletcher Architects and engineering drawings prepared by VML and Associates Limited.
3. For layout of all work refer to construction drawings for each parcel.
4. Plant quantities indicated on the plan supersede the quantities from the plant list (refer and discrepancies to the landscape architect). Refer to the North Barrie Crossing Shopping Centre Urban Design Guidelines for required plant quantities for each parcel.
5. The contractor shall check and verify all existing and proposed grading and conditions on the project and immediately report any discrepancies to the consultant before proceeding with any work.
6. The contractor is to be aware of all existing and proposed services and utilities. The contractor is responsible for having all underground services and utility lines staked by each agency having jurisdiction prior to commencing work.
7. Final locations for all signage and site furniture will be determined and approved during site plan application review for each parcel.
8. Keep area outside construction zone clean and useable by others at all times. Contractor shall thoroughly clean areas surrounding the construction zone at the end of each work day.
9. Do not leave any holes open overnight.
10. Contractor shall maintain a detailed record of all authorized changes in the form of a redline mark-up drawing. These records shall be submitted to the Landscape Architect as a condition of obtaining substantial completion.
11. Contractor to make good any and all damages resulting from the work at no extra cost.
12. All planting beds are to be mulched.
13. Final locations for site furniture is to be determined on site with the Landscape Architect present. Contractor shall install all site furniture in locations as directed.
14. This drawing is Copyright MHBC Planning, 2018.

Revision No.	Date	Issued / Revision	By
9	FEB. 28 2018	Re-issued for SPA	SN
8	NOV. 17 2017	Re-issued for SPA	SN
7	SEPT. 20 2017	Re-issued for SPA	LK
6	APR. 28 2015	Re-issued for SPA	BN
5	MAR. 04 2015	Issued for SPA	BN
4	JAN. 12 2015	Re-issued for Review	BN
3	OCT. 28 2014	Re-issued for Review	BN
2	OCT. 24 2014	Issued for Review	BN
1	OCT. 21 2014	Issued for Review	BN

Stamp: PLANNING URBAN DESIGN & LANDSCAPE ARCHITECTURE  
200-750 WERCH ROAD WOODBRIDGE, ON L4L 8C7 | P: 905.741.5588 F: 905.741.5589 | WWW.MHBCPLAN.COM

Date: October 2014  
Drawn By: B.N.  
Plan Scale: AS SHOWN  
File No.: 10179 G  
Checked By: N.M.  
Other:

Project Client: NORTH BARRIE CROSSING CUNDLES ROAD EAST  
PENADY (Barrie) Ltd.  
10 Dundas Street East, Suite 1002  
Toronto, Ontario M5B 2C5

File Name: Site A3 Landscape & Planting Plan  
Dwg No.: L-3