

SITE LIGHTING FIXTURE SCHEDULE		
ID	DESCRIPTION	CATALOGUE NUMBER
'W'	LED BASED WALL MOUNTED ALUMINUM BODIED BRONZE FINISHED WALL SCONCE WITH TYPE II DISTRIBUTION RATED AT 4000K, 1153 LUMENS, 14W POWER WITH 120V DRIVER. MOUNTED AT 10FT ABOVE GRADE ON FLUSH MOUNTED OUTLET BOX. EXACT PLACEMENT ON EXTERIOR ELEVATION TO LATER DETAIL.	SIGNIFY STONCO CAT # LPW7 LYTEPROBL-14L-450-NW-G2-3-120V-BZ FINISH
'X'	LED FLAT DISH TOP BOLLARD WITH DOUBLE ARM SUPPORT MOUNTED ON 4.5" DIA BRONZE FINISHED POST WITH TOTAL HEIGHT ABOVE CONCRETE BASE 42" TO TOP. FIXTURE SHALL BE CAST ALUMINUM WITH A 1/4 LED LIGHT SOURCE RATED AT 4000K, 1211 LUMENS, 10W POWER WITH 120V DRIVER. PROVIDE TYPE III DISTRIBUTION WITH THE SPLASH OF LIGHT AIMED AT SIDEWALK AREA. PROVIDE CONCRETE BASE WHICH SHALL BE 12" DIA WITH TOP OF BASE AT 4" ABOVE FINISHED GRADE AND EXTENDING 5FT BELOW GRADE IN UNDISTURBED SOIL OR ENGINEERED BACKFILL. PROVIDE REINFORCING STEEL REBAR CAGE FOR BASE. CHAMFER TOP OF CONCRETE BASE WITH 1" CHAMFER. EXTEND RIGID PVC RACEWAYS INTO BASE AT 20" BELOW FINISHED GRADE AND STUB UP IN CENTER OF POLE BASE PLATE EXTENDING 6" ABOVE TOP OF CONCRETE BASE. WHERE BOLLARDS ARE LOCATED IN PLANTERS BETWEEN BLOCKS 1 AND 2 AND BETWEEN BLOCKS 2 AND 3, BOLLARD SHALL BE MOUNTED ON CONCRETE PLINTH PROVIDED AS PART OF GARAGE CEILING SLAB WITH ANCHOR BOLTS AND WIRING RUN IN SLAB TO BE CO-ORDINATED ON SITE. SEE DETAILS ON SITE ELECTRICAL DRAWINGS.	SIGNIFY GARDCO CAT # PBL-14L-450-NW-G2-3-120V-BZ FINISH
'Y'	FLUSH MOUNTED CAST ALUMINUM STEP LIGHT WITH BRONZE FINISHED LOUVERED WEATHERPROOF COVER WITH INTEGRAL 14W 4000K 1211 LUMEN LIGHT SOURCE AND 120V DRIVER. FLUSH MOUNTED INTO CONCRETE FACE WITH WIRING RUN CONCEALED IN CONCRETE.	SIGNIFY HADCO CAT # RSV2-KSD-G2
'Z'	POLE MOUNTED LED STREET LIGHTING FIXTURE WITH DIE CAST ALUMINUM WITH BRONZE POWDER COAT FINISHED WITH 2-3/8" DIA SLIP FITTER BRACKET. LENSE SHALL BE CLEAR POLYCARBONATE, LEDS SHALL BE 4000K WITH 5255 LUMENS WITH 120V DRIVER AND TYPE III DISTRIBUTION WITH REAR HOUSE SIDE SHIELD ALIGNED WITH CURB LINE. 120V 56W, PROVIDE DA-50 ALL NIGHT 50% DIMMING MODULE, ONE FIXTURE PER POLE. REFER TO POLE SCHEDULE FOR HEIGHT OF POLE.	SIGNIFY GARDCO CAT # ECF-S-32L-530-NW-G2-2-HIS-120-DA50-TLRPC-F1-BZ FINISH
'Z1'	POLE MOUNTED LED STREET LIGHTING FIXTURE WITH DIE CAST ALUMINUM WITH BRONZE POWDER COAT FINISHED WITH 2-3/8" DIA SLIP FITTER BRACKET. LENSE SHALL BE CLEAR POLYCARBONATE, LEDS SHALL BE 4000K WITH 5348 LUMENS WITH 120V DRIVER AND TYPE III DISTRIBUTION WITH REAR HOUSE SIDE SHIELD ALIGNED WITH CURB LINE. 120V 56W, PROVIDE DA-50 ALL NIGHT 50% DIMMING MODULE, ONE FIXTURE PER POLE. REFER TO POLE SCHEDULE FOR HEIGHT OF POLE.	SIGNIFY GARDCO CAT # ECF-S-32L-530-NW-G2-3-HIS-120-DA50-TLRPC-F1-BZ FINISH

POLE SCHEDULE		
ID	DESCRIPTION	CATALOGUE NUMBER
'P1', 'P2', 'P3', 'P4', AND 'P5'	STRAIGHT 4" DIA ROUND ALUMINUM POLE 20FT TALL FINISHED IN BRONZE WITH MATCHING BASE CAP. POLE SHALL HAVE HANDHOLE AND 4" WEATHERPROOF CAP WITH ALL WIRING RUN CONCEALED IN POLE AND CORRESPONDING SINGLE LIGHT FIXTURE. PROVIDE PIG TAIL STYLE ANCHOR BOLTS IN CONCRETE BASE. PROVIDE CONCRETE BASE WHICH SHALL BE 16" DIA WITH TOP OF BASE AT 4" ABOVE FINISHED GRADE AND EXTENDING 5FT BELOW GRADE IN UNDISTURBED SOIL OR ENGINEERED BACKFILL. PROVIDE RE-INFORCING STEEL REBAR CAGE FOR BASE. CHAMFER TOP OF CONCRETE BASE WITH 1" CHAMFER. EXTEND RIGID PVC RACEWAYS INTO BASE AT 500 BELOW FINISHED GRADE AND STUB UP IN CENTER OF POLE BASE PLATE EXTENDING 6" ABOVE TOP OF CONCRETE BASE.	DYNAPOLE CAT # SRA20.4" BRONZE

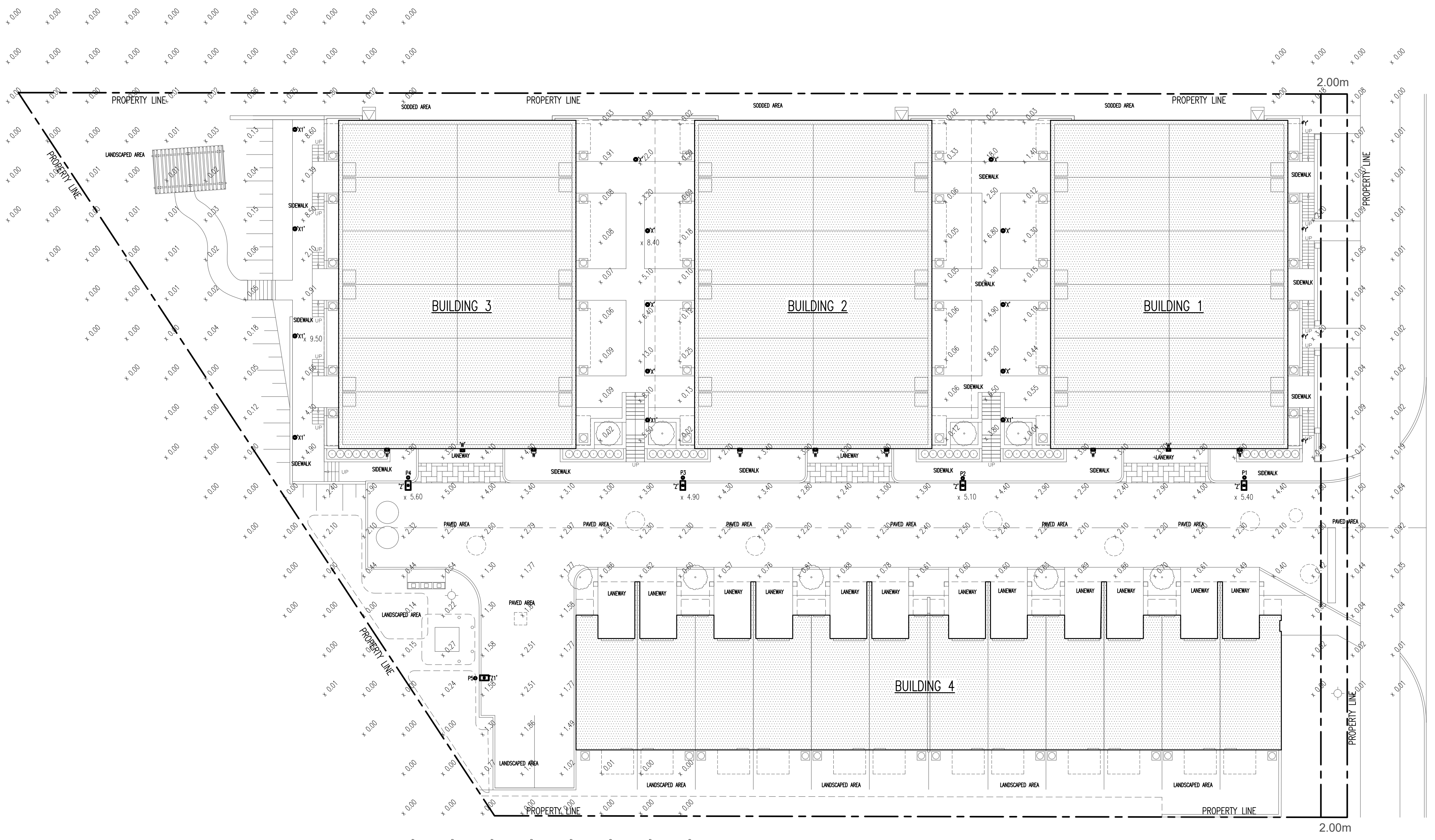

SITE PLAN - PROPOSED SITE LIGHTING

SCALE: 1:200 METRIC (22x34)

DRAWING REFERENCE NOTES

X DENOTES MEASUREMENT POINT AT GRADE LEVEL, 1.05 DENOTES ILLUMINATION LEVELS AS CALCULATED, MEASURED IN FOOTCANDLES

Light loss factor: 0.80

Surface result object 1: Perpendicular illuminance (adaptive) (Surface)

Light scene: Light scene 1

Average: 2.63 fc, Min: 0.046 fc, Max: 6.30 fc, Min/average: 0.018, Min/max: 0.007



ILLUMINATION VISUALIZATION - COURTYARD



ILLUMINATION VISUALIZATION - REAR OF SITE



ILLUMINATION VISUALIZATION - BIRDSEYE VIEW

PROFESSIONAL SERVICES INC.
MEED
 (416) 570-5456 info@medps.ca

12/MAR/21
 ENGINEER
 R. K. WALKER
 P. ENG. REG. NO. 4867013
 LICENSED PROFESSIONAL ENGINEER
 PROVINCE OF ONTARIO

Project	521 525 ESSA ROAD BARRIE, ONTARIO	Date	12/MAR/21	Drawn	MED	Approved	RCW
Drawing No.	SL1	Date	12/MAR/21	Drawn	MED	Approved	RCW
Project Number	MED-4500	Drawing Title PROPOSED SITE LIGHTING ILLUMINATION LEVELS					

