

How to Disconnect Your Downspout

Step One

Measure 23 cm (9") from where the downspout enters the sewer connection. Proceed to cut the downspout with a hacksaw.

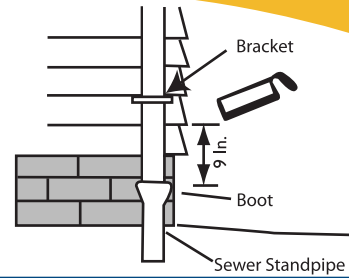

Step Two

Cap the sewer standpipe to prevent water from going in. You can use a simple rubber cap secured by a hose clamp. You can also use a wing-nut test plug if available cap sizes don't fit.

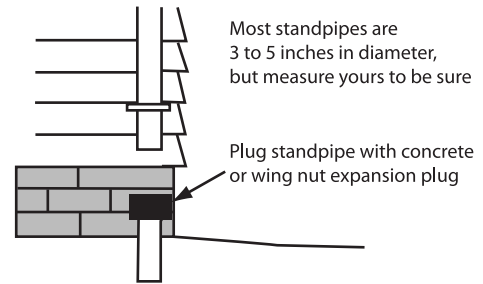

Step Three

Insert the downspout into the elbow (if you put the elbow into the downspout, it will leak). You may need to crimp the end of the downspout with a pair of pliers to get a good fit.

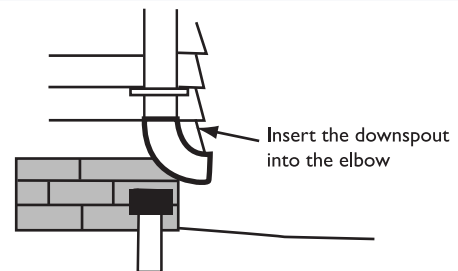

Step Four

Attach a downspout pipe extension to carry water away from the house and foundation. You can use a hacksaw to cut the extension to the desired length. Be sure to insert the elbow into the extension to prevent leaks. Secure the elbow and extension with sheet metal screws. To prevent erosion where the water drains, you can place a splash pad at the end of the downspout extension.

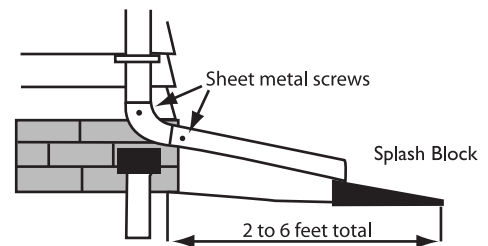

You Will Need:

- Hacksaw
- Tape measure
- Hammer
- Screwdriver
- Pliers
- Sheet metal screws
- Downspout elbow
- Downspout extension
- Splash block (optional)
- Rubber cap

Benefits of Disconnecting Your Downspout

- Less flooding on lawns and basements
- Less water sent to the Water Pollution Control Centre therefore less money spent on treatment
- Fewer pollutants carried into storm water as water is filtered through lawns

For More Information Contact:

The City of
BARRIE

Environmental Operations
P.O. Box 400
272 Ferndale Drive, North, Barrie ON
Phone: (705) 739 - 4219
Fax: (705) 739 - 4251
www.barrie.ca